

STATE OF KANSAS
STATE CORPORATION COMMISSION
CONSERVATION DIVISION
200 Colorado Derby Building
Wichita, Kansas 67202

Rev. 12/14/82
FORM CP-1

WELL PLUGGING APPLICATION FORM

File One Copy

API NUMBER 15-039-20304-00-00 NA (of this well) 6/86
(This must be listed; if no API# was issued, please note drilling completion date.)

LEASE OPERATOR A. L. Abercrombie, Inc. OPERATORS LICENSE NO. 5393

ADDRESS 801 Union Center Wichita, KS 67202 PHONE # (316) 262-1841

LEASE (FARM NAME) Huber WELL NO. 1

WELL LOCATION SE NW SEC. 21 TWP. 5 RGE. 30 or (W)

COUNTY Decatur TOTAL DEPTH 4170' FIELD NAME _____

check one:

OIL WELL GAS WELL INPUT WELL SWD WELL D&A

IS WELL LOG ATTACHED TO THIS APPLICATION AS REQUIRED? Yes IS ACO-1 FILED? _____
(If not, explain)

DATE AND HOUR PLUGGING IS DESIRED TO BEGIN As soon as possible

PLUGGING OF THIS WELL WILL BE DONE IN ACCORDANCE WITH K.S.A. 55-128 OF THE RULES AND REGULATIONS OF THE STATE CORPORATION COMMISSION.

NAME OF COMPANY REPRESENTATIVE AUTHORIZED TO BE IN CHARGE OF PLUGGING OPERATIONS:

E. L. Abercrombie ADDRESS Rt. #1 Box 56 Great Bend, KS 67530
PHONE # (316) 793-8186

PLUGGING CONTRACTOR Kelso Casing Pulling LICENSE NO. _____

ADDRESS Box 347 Chase, KS 67524 PHONE # (316) 938-2457

INVOICE COVERING ASSESSMENT FOR PLUGGING THIS WELL SHOULD BE SENT TO:

NAME A. L. Abercrombie, Inc.

ADDRESS 801 Union Center Wichita, KS 67202 PHONE # (316) 262-1841

AND PAYMENT WILL BE GUARANTEED BY APPLICANT OR ACTING AGENT.

SIGNED: E. L. Abercrombie RECEIVED
(Applicant or Acting Agent) STATE CORPORATION COMMISSION

DATE: 2-13-86

FEB 18 1986
02-18-1986
CONSERVATION DIVISION
Wichita, Kansas

(6)

KANSAS DRILLERS LOG

API No. 15 — 039 — 20,304-00-00
 County Number

S. 21 T. 5S R. 30 W
 Loc. SE NW
 County Decatur

Operator A.L. Abercrombie, Inc.

Address 801 Union Center, Wichita, Kansas 67202

Well No. 1 Lease Name HUBER

Footage Location 1980 feet from (N) X line 1980 feet from (E) X (W) line

Principal Contractor Abercrombie Drilling, Inc. Geologist Charles Johnson

Spud Date May 5, 1975 Total Depth 4170' P.E.T.D.

Date Completed Oil Purchaser Koch Oil Company

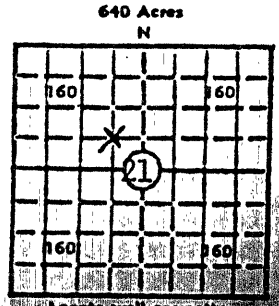

Locate well correctly 2874'
 Elev.: G. 2880' KB 2882'

CASING RECORD

Report of all strings set — surface, intermediate, production, etc.

Purpose of string	Size hole drilled	Size casing set (in O.D.)	Weight lbs/ft.	Setting depth	Type cement	Sacks	Type and percent additives
Surface	12 1/4"	8-5/8"		228'		160	None
Production		4 1/2"		4173'	50-50 Posmix	100	12# Gilsonite per sack
					Common	150	10% salt 4# friction reducer p/sack

LINER RECORD

PERFORATION RECORD

Top, ft.	Bottom, ft.	Sacks cement	Shots per ft.	Size & type	Depth interval
			4		4116'-4120'
			4		4011'-4016'

TUBING RECORD

Size	Setting depth	Packer set at	Depth interval
			4011'-4016'

ACID, FRACTURE, SHOT, CEMENT SQUEEZE RECORD

Amount and kind of material used	Depth interval treated
2500 Gal. Non-E	4116'-4120'
500 Gal. Non-E	4011'-4016'

INITIAL PRODUCTION

Date of first production <u>May 30, 1975</u>	Producing method (flowing, pumping, gas lift, etc.) <u>Pumping</u>
RATE OF PRODUCTION PER 24 HOURS	Oil <u>76</u> bbls. Gas <u>none</u> MCF Water <u>none</u> bbls. Gas-oil ratio <u>CFPB</u>
Disposition of gas (vented, used on lease or sold) <u>none</u>	Producing interval(s) <u>4116'-4120'</u>

INSTRUCTIONS: As provided in KCC Rule 82-2-125, within 90 days after completion of a well, one completed copy of this Drillers Log shall be transmitted to the State Geological Survey of Kansas, 4150 Monroe Street, Wichita, Kansas 67209. Copies of this form are available from the Conservation Division, State Corporation Commission, 3830 So. Meridian (P.O. Box 17027), Wichita, Kansas 66217. Phone AC 316-522-2206. If confidential custody is desired, please note Rule 82-2-125. Drillers Logs will be on open file in the Oil and Gas Division, State Geological Survey of Kansas, Lawrence, Kansas 66044.

RECEIVED
 STATE CORPORATION COM
 FEB 18 198
 CONSERVATION DIVISION



JOHN CARLIN
MICHAEL LENNEN
MARGALEE WRIGHT
KEITH R. HENLEY
JUDITH A. McCONNELL
BRIAN J. MOLINE

Governor
Chairman
Commissioner
Commissioner
Executive Secretary
General Counsel

State Corporation Commission

CONSERVATION DIVISION

(Oil, Gas and Water)
200 Colorado Derby Building
202 West 1st Street
WICHITA, KANSAS 67202-1286

THIS NOTICE

MAY 18 1986

EXPIRES

February 18, 1986

WELL PLUGGING NOTICE

Huber #1
SE NW
Sec. 21-5S-30W
Decatur County

A. L. Abercrombie, Inc.
801 Union Center
Wichita, KS 67202

Gentlemen:

This is your notice to plug the above subject well in accordance with the Rules and Regulations of the State Corporation Commission.

This notice is void after ninety (90) days from the above date.

Sincerely,

William R. Bryson, Director

Please contact the district office to review your suggested method of plugging

DIST. #6 1014 Cody Hays, KS 67601 913-628-1200

five days prior to plugging the well (KAR-82-3-113).