

b  
STATE OF KANSAS  
STATE CORPORATION COMMISSION  
CONSERVATION DIVISION  
500 INSURANCE BUILDING  
212 NORTH MARKET  
WICHITA 2, KANSAS

RECEIVED  
STATE CORPORATION COMMISSION

DEC 23 1959

CONSERVATION DIVISION  
Wichita, Kansas

12-23-59

15-023-00028-0000

WELL PLUGGING APPLICATION FORM  
File One Copy

Lease Owner JOHN O. FARMER, INC.  
(Applicant)  
Address Russell, Kansas

Lease (Farm Name) NEITZEL Well No. 1

Well Location NW NE Sec. 3 Twp. 5S Rge. (E) (W) 39

County Cheyenne Field Name (if any) \_\_\_\_\_

Total Depth 5200 Oil Well      Gas Well      Input Well      SWD Well      D & A X

Was well log filed with application? yes If not, explain: \_\_\_\_\_

Date and hour plugging is desired to begin 11:00 PM 12/16/59

Plugging of the well will be done in accordance with the Rules and Regulations of the State Corporation Commission.

Name of person on the lease in charge of well for owner \_\_\_\_\_

Dale Buchheister Address Plainville, Kansas

Plugging Contractor JOHN O. FARMER, INC. License No. \_\_\_\_\_

Address Russell, Kansas

Invoice covering assessment for plugging this well should be sent to \_\_\_\_\_

JOHN O. FARMER, INC. Address Russell, Kansas

and payment will be guaranteed by applicant.

Signed: John O. Farmer  
Applicant or Acting Agent

Date: December 21, 1959

OPERATOR JOHN O. FARMER, INC.

FORMATION RECORD

ADDRESS Russell, Kansas

Give detailed description and thickness of all formation drilled through, contents of sand, whether, dry, water, oil or gas.

WELL NO. 1 COUNTY Cheyenne TWP 5S RGE 39W

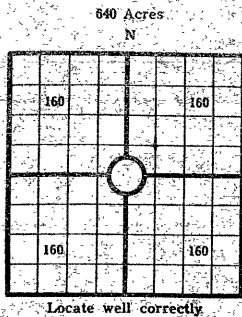

640 Acres  
N  
COUNTY Cheyenne SEC. 3 TWP. 5S RGE. 39W  
COMPANY OPERATING JOHN O. FARMER, INC.  
OFFICE ADDRESS Russell, Kansas  
DRILLING STARTED 11/30, 59 DRILLING FINISHED 12/16, 59  
DATE OF FIRST PRODUCTION \_\_\_\_\_ COMPLETED \_\_\_\_\_  
WELL LOCATED 1/4 NW 1/4 NE 1/4, North of South  
Line and \_\_\_\_\_ ft. East of West Line of Quarter Section  
Elevation (Relative to sea level) DERRICK FLOOR 3514 GROUND, 3511  
CHARACTER OF WELL (Oil, gas or dryhole) Dry

OIL OR GAS SANDS OR ZONES

Name	From	To	Name	From	To
1			4		
2			5		
3			6		

Perforating Record If Any

Shot Record

Formation	From	To	No. of Shots	Formation	From	To	Size of Shot

CASING RECORD

Amount Set						Amount Pulled				Packer Record	
Size	Wt.	Thds.	Make	Ft.	In.	Size	Length	Depth Set	Make		
8-5/8				366							

Liner Record: Amount \_\_\_\_\_ Kind \_\_\_\_\_ Top \_\_\_\_\_ Bottom \_\_\_\_\_

CEMENTING AND MUDDING

Size	Amount Set Ft.	Sacks In.	Chemical Gal.	Method of Make	Amount Cementing	Mudding Method	Results (See Note)
8-5/8	366	175					

Note: What method was used to protect sands if outer strings were pulled?

NOTE: Were bottom hole plugs used? \_\_\_\_\_ If so, state kind, depth set and results obtained \_\_\_\_\_

TOOLS USED

Rotary Tools were used from \_\_\_\_\_ feet to \_\_\_\_\_ feet to \_\_\_\_\_ feet to \_\_\_\_\_ feet, and from \_\_\_\_\_ feet to \_\_\_\_\_ feet, and from \_\_\_\_\_ feet to \_\_\_\_\_ feet.  
Type Rig \_\_\_\_\_

INITIAL PRODUCTION TEST

Describe initial test: whether by flow through tubing or casing or by pumping \_\_\_\_\_  
Amount of Oil Production \_\_\_\_\_ bbls. Size of choke, if any \_\_\_\_\_ Length of test \_\_\_\_\_ Water  
Production \_\_\_\_\_ bbls. Gravity of oil \_\_\_\_\_ Type of Pump if pump is used, describe \_\_\_\_\_

Formation	Top	Bottom	Formation	Top	Bottom
Clay & sand	0	335	FARM NAME:  NEITZEL #1  Elevation: RB sample log		
Blue shale	335	365			
Shale	365	1700			
Shale & sand	1700	1930			
Shale, sand & shells	1930	2290			
Shale & shells	2290	3010			
Anhydrite	3010	3041			
RedBed	3041	3085			
RedBed & lime streaks	3085	3240			
Anhydrite	3240	3345			
RedBed w/ stks	3345	3465			
Shale & lime	3465	3740			
Lime & shale	3740	4885			
Lime	4885	4915			
Lime & shale	4915	5180			
Lime & chert	5180	5200			
T.D.		5200			

D & A

RECEIVED  
 STATE COMMISSION  
 CONSERVATION DIVISION  
 Wichita, Kansas  
 DEC 23 1959

15-023-00028-06-00

I, the undersigned, being first duly sworn upon oath, state that this well record is true, correct and complete according to the records of this office and to the best of my knowledge and belief.

John O. Farmer President  
Name and title of representative of company

Subscribed and sworn to before me this 21st day of December, 1959

My Commission expires 10/11/62

Lucretia Keener  
Notary Public

State of Kansas



15-023-00028-0000

GEORGE DOCKING Governor  
HARRY G. WILES Chairman  
MARION BEATTY Commissioner  
RICHARD C. BYRD Commissioner  
RAYMOND B. HARVEY Secretary  
J. ROBERT WILSON Counsel

State Corporation Commission

CONSERVATION DIVISION

(Oil, Gas and Water)  
500 Interstate Bldg. 212 N. Market  
WICHITA, KANSAS  
JEWEL M. OGDEN, Director

WELL PLUGGING AUTHORITY

December 28, 1959

Well No. 1  
Lease Neitzel  
Description NW NE 3-5-39W  
County Cheyenne

John O. Farmer Inc.  
Russell, Kansas

Gentlemen:

This is your authority to plug the above subject well in accordance with the Rules and Regulations of the State Corporation Commission.

This authority is void after 90 days from the above date.

Very truly yours,

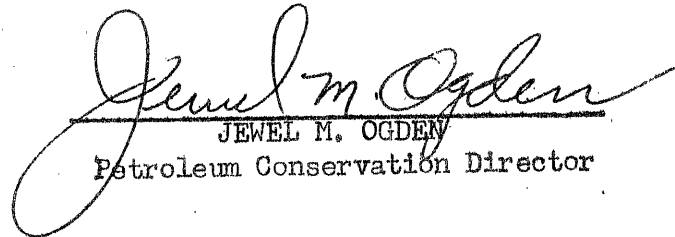
  
JEWEL M. OGDEN  
Petroleum Conservation Director

Mr. Fabricius  
is hereby assigned to supervise the plugging of the above named well.

In the event you need any further information regarding this well feel free to write or call me at any time.

J. Lewis Brock  
Western Kansas Field Supervisor  
P. O. Box 569  
Great Bend, Kansas  
Phone: GL-33022