

STATE OF KANSAS
STATE CORPORATION COMMISSION
CONSERVATION DIVISION
200 Colorado Derby Building
Wichita, Kansas 67202

FORM CP-1
Rev. 03/92

WELL PLUGGING APPLICATION FORM
(PLEASE TYPE FORM and File ONE Copy)

API # 15-023-20,033-00-00 (Identifier number of this well). This must be listed for wells drilled since 1967; if no API# was issued, indicate spud or completion date.

WELL OPERATOR A. L. Abercrombie, Inc. KCC LICENSE # 5393 6-13
(owner/company name) (operator's)

ADDRESS Rt. #1 Box 56 CITY Great Bend

STATE Kansas ZIP CODE 67530 CONTACT PHONE # (316) 793-8186

LEASE Fisher WELL# 1 SEC. 35 T. 5 R. 37 (East/West)

C SW NW SPOT LOCATION/QQQQ COUNTY Cheyenne

1980 FEET (in exact footage) FROM S (N) (circle one) LINE OF SECTION (NOT Lease Line)

660 FEET (in exact footage) FROM E (W) (circle one) LINE OF SECTION (NOT Lease Line)

Check One: OIL WELL GAS WELL D&A SWD/ENHR WELL DOCKET# _____

CONDUCTOR CASING SIZE _____ SET AT _____ CEMENTED WITH _____ SACKS

SURFACE CASING SIZE 8 5/8 SET AT 380 CEMENTED WITH 300 SACKS

PRODUCTION CASING SIZE 4 1/2 SET AT 4705 CEMENTED WITH 225 SACKS

LIST (ALL) PERFORATIONS and BRIDGEPLUG SETS: 4577-4586

ELEVATION 3319-3324 T.D. 4950 PBDT 4667 ANHYDRITE DEPTH 3020 Top
(G.L./K.B.) (Stone Corral Formation)

CONDITION OF WELL: GOOD POOR CASING LEAK JUNK IN HOLE

PROPOSED METHOD OF PLUGGING In compliance with rules and regulations
with State of Kansas.

(If additional space is needed attach separate page)

IS WELL LOG ATTACHED TO THIS APPLICATION AS REQUIRED? Yes IS ACO-1 FILED? C-10

If not explain why? _____

PLUGGING OF THIS WELL WILL BE DONE IN ACCORDANCE WITH K.S.A. 55-101 et. seq. AND THE RULES AND REGULATIONS OF THE STATE CORPORATION COMMISSION.

LIST NAME OF COMPANY REPRESENTATIVE AUTHORIZED TO BE IN CHARGE OF PLUGGING OPERATIONS:

E. L. Abercrombie PHONE# (316) 793-8186

ADDRESS Rt. #1 Box 56 City/State Great Bend, Ks. 67530

PLUGGING CONTRACTOR Kelso Casing Pulling, Inc. KCC LICENSE # 6050 6-13
(company name) (contractor's)

ADDRESS P.O. Box 347 Chase, Ks. 67524 PHONE # (316) 938-2943

PROPOSED DATE AND HOUR OF PLUGGING (If Known?) Soon as possible

PAYMENT OF THE PLUGGING FEE (K.A.R. 82-3-118) WILL BE GUARANTEED BY OPERATOR OR AGENT

DATE: 4-13-93 AUTHORIZED OPERATOR/AGENT: E. L. Abercrombie RECEIVED
STATE CORPORATION COMMISSION
(signature)

APR 14 1993
4-14-93
CONSERVATION DIVISION
Wichita, Kansas

KANSAS DRILLERS LOG

S. 35 T. 5 S R. 37 R
W

API No. 15 — 023 — 20,033 -00-00
County Number

Loc. C SW NW

County Cheyenne

Operator
Abercrombie Drilling, Inc.

Address
801 Union Center, Wichita, Kansas 67202

Well No. 1 Lease Name FISHER

Footage Location
feet from (N) (S) line feet from (E) (W) line

Principal Contractor Abercrombie Drilling, Inc. Geologist Jack K. Wharton

Spud Date June 11, 1977 Total Depth 4950' P.B.T.D.

Date Completed September 17, 1977 Oil Purchaser Koch Oil Company

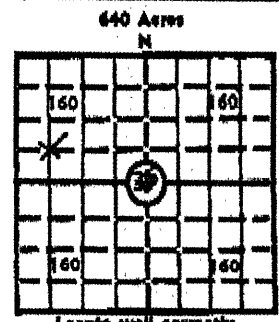

Elev. Cr. 3319'

DF 3322' KB 3324'

CASING RECORD

Report of all strings set— surface, intermediate, production, etc.

Purpose of string	Size hole drilled	Size casing set (in O.D.)	Weight lbs/ft.	Setting depth	Type cement	Seals	Type and percent additives
Surface	12-1/4"	8-5/8"		380'	Common	300	2% gel, 3% CaCl
Production	7-7/8"	4 1/2"	10#		50/50 Posmix	75	2% gel, 12# gilsinite
					Common	150	2% gel saturated

LINER RECORD

PERFORATION RECORD

Top, ft.	Bottom, ft.	Seals cement	Shots per ft.	Size & type	Depth interval
					4577-4586'

TUBING RECORD

Size	Setting depth	Pecker set at

ACID, FRACTURE, SHOT, CEMENT SQUEEZE RECORD

Amount and kind of material used	Depth interval treated

INITIAL PRODUCTION

Date of first production <u>September 6, 1977</u>	Producing method (flowing, pumping, gas lift, etc.) <u>Pumping</u>
RATE OF PRODUCTION PER 24 HOURS	Oil <u>140</u> bbls. Gas <u>None</u> MCF Water <u>12%</u> Gas-oil ratio <u>None</u> GPP
Disposition of gas (vented, used on lease or sold)	Producing interval (s) <u>4577-4586'</u>

INSTRUCTIONS: As provided in KCC Rule 82-2-125, within 90 days after completion of a well, one completed copy of this Drillers Log shall be transmitted to the State Geological Survey of Kansas, 4150 Monroe Street, Wichita, Kansas 67209. Copies of this form are available from the Conservation Division, State Corporation Commission, 3830 So. Meridian (P.O. Box 17027), Wichita, Kansas 67217. Phone AC 316-322-2206. If confidential custody is desired, please note Rule 82-2-125. Drillers Logs will be an open file in the Oil and Gas Division, State Geological Survey of Kansas, Lawrence, Kansas 66044.

C-10-1972

RECEIVED
STATE CORPORATION COMMISSION

APR 14 1993

CONSERVATION DIVISION
Wichita, Kansas

Operator **Abercrombie Drilling, Inc.** DESIGNATE TYPE OF COMP.: OIL, GAS, DRY HOLE, SWD, ETC.: **OIL**

Well No. **1** Lease Name **FISHER**

S 35 T 5 SR 37 W

WELL LOG

Show all important zones of porosity and contents thereof; cored intervals, and all drill-stem tests, including depth interval tested, cushion used, time tool open, flowing and shut-in pressures, and recoveries.

SHOW BIOLOGICAL MARKERS, LOGS RUN, OR OTHER DESCRIPTIVE INFORMATION.

FORMATION DESCRIPTION, CONTENTS, ETC.	TOP	BOTTOM	NAME	DEPTH
Surface clay & sand & shale	0	390		
Sand & shale	390	2236		
Shale	2236	2715		
Anhydrite	2715	2752	Blaine Anhydrite	2715 (+609)
Shale	2752	2866	B/Blaine Anhy.	2752 (+752)
Shale & shells	2866	3085	Anhydrite	3020 (+304)
Shale & lime	3085	3760	Heebner	4155 (-831)
Lime & shale	3760	4677	Toronto	4193 (-869)
Lime	4677	4726	Lansing	4214 (-890)
Lime & shale	4726	4761	B/KC	4480 (-1156)
Lime	4761	4884	Marmaton	4496 (-1172)
Lime & shale	4884	4950	Mississippian	4897 (-1573)
Rotary Total Depth		4950		
			ELECTRIC LOG TOPS:	
			Anhydrite	3014 (+310)
			B/Anhydrite	3052 (+272)
			Heebner	4144 (-820)
			Toronto	4183 (-859)
			Lansing	4200 (-876)
			B/KC	4477 (-1153)
			Marmaton	4495 (-1171)
			Fort Scott	4641 (-1317)
			Cherokee	4664 (-1340)
			Sand	4851 (-1527)
			Mississippian	4890 (-1566)
			RTD	4950 (-1626)
			ELTD	4950 (-1626)

DST #1 (4565-4635') 10", 45", 45", 45"
 Strong blow. Rec. 805' gip, 105' free oil (38°), 360' HMCO (50% oil) IFP 61-61, IBHP 1475, FFP 81-183, FBHP 1475. Temp. 116°. (Apparent packer seep; bottom hole pressure questionable.)
DST #2 (4690-4726') 20", 45", 30", 45"
 Weak blow - 20 min. & died. Rec. 10' mud. IFP 20-20, IBHP 938, FFP 20-20, FBHP 816.
DST #3 (4667-4690') Misrun
DST #4 (4567-4590') 30", 60", 90", 60".
 Rec. 1020' gip, 240' free gassy oil (39.5°) 390' HMCO - 45% mud, 55% oil. Temp. 116°. IFP 51-102, IBHP 1475, FFP 122-234, FBHP 1465.
DST #5 (4396-4454') 14", 45", 45", 45".
 Mis run.
DST #6 (4396-4454') 15", 30", 30", 30".
 Rec. 75' muddy water with spots of oil. IFP 30, IBHP 1283, FFP 51-61, IFHP 1161.

USE ADDITIONAL SHEETS, IF NECESSARY, TO COMPLETE WELL RECORD.

Date Received _____
 Signature: Jack L. Partridge
 Title: Assistant Secretary-Treasurer
 Date: September 29, 1977

RECEIVED
 STATE CORPORATION COMMISSION

APR 14 1993

CONSERVATION DIVISION
 Wichita, Kansas

Joan Finney
Governor

Jim Robinson
Chairman

F. S. Jack Alexander
Commissioner

Rachel C. Lipman
Commissioner

Judith McConnell
Executive Director

Brian Moline
General Counsel



Kansas Corporation Commission

15-023-20033-00-00

NOTICE OF RECEIPT OF WELL PLUGGING APPLICATION

April 14, 1993

A L Abercrombie Inc
Rt 1 Box 56
Great Bend Ks 67530

Fisher 1
API 15-023-20,033
1980'FSL-660'FEL
Sec. 35-05-37W
Cheyenne County

Dear Mr. E. L. Abercrombie,

This letter is to notify you that the Conservation Division is in receipt of your plugging proposal, form CP-1, for the above-captioned well.

Your CP-1 has been reviewed by the Conservation Division central office for completeness and to verify license numbers. The plugging proposal will now be forwarded to the district office listed below for review of your proposed method of plugging. Please contact the district office for approval of your proposed plugging method at least at five (5) days before plugging the well, pursuant to K.A.R. 82-3-113 (b). If a workover pit will be used during the plugging of the well it must be permitted. A CDP-1 form must be filed and approved prior to the use of the pit.

It has recently come to my attention that the form CP-1 has been filed by operators other than the owner or operator of the well and without the consent of the owner or operator. The Conservation Division's review of form CP-1, either in the central or district office, does not include an inquiry into well ownership or the filing operator's legal right to plug the well.

This notice in no way constitutes authorization to plug the above-captioned well by persons not having legal rights of ownership or interest in the well. This notice is void after ninety (90) days from the above date.

Sincerely,

Handwritten signature of David P. Williams in dark ink.

David P. Williams
Production Supervisor

Conservation Division
William R. Bryson
Director
200 Colorado Derby Bldg.
202 W. 1st Street
Wichita, Kansas 67202-1256
Telephone (316) 263-3238

District: #4 2301 E. 13th
Hays, KS 67601
(913) 628-1200