

R
STATE OF KANSAS
STATE CORPORATION COMMISSION
CONSERVATION DIVISION
500 INSURANCE BUILDING
212 NORTH MARKET
WICHITA 2, KANSAS

RECEIVED
STATE CORPORATION COMMISSION

NOV 16 1959

11-16-59
CONSERVATION DIVISION
Wichita, Kansas

WELL PLUGGING APPLICATION FORM
File One Copy

15-153-30000-0000

Lease Owner JOHN O. FARMER, INC.
(Applicant)
Address Russell, Kansas

Lease (Farm Name) BARCUS Well No. 1

Well Location SE SW Sec. 35 Twp. 5S Rge. (E) (W) 31

County Rawlins Field Name (if any) _____

Total Depth 4647 Oil Well Gas Well Input Well SWD Well D & A X

Was well log filed with application? yes If not, explain: _____

Date and hour plugging is desired to begin 11/4/59 at 12:45 PM

Plugging of the well will be done in accordance with the Rules and Regulations of the State Corporation Commission.

Name of person on the lease in charge of well for owner _____

Raymond Kaba Address Plainville, Kansas

Plugging Contractor John O. Farmer, Inc. License No. _____

Address Russell, Kansas

Invoice covering assessment for plugging this well should be sent to _____

JOHN O. FARMER, INC. Address Russell, Kansas

and payment will be guaranteed by applicant.

Signed: John O. Farmer
Applicant or Acting Agent

Date: November 13, 1959

OPERATOR JOHN O. FARMER, INC.
 ADDRESS Russell, Kansas

FORMATION RECORD

Give detailed description and thickness of all formation drilled through, contents of sand, whether dry, water, oil or gas.

WELL NO. 80 COUNTY RAWLINS SEC. 35 TWP. 5S RGE. 31W FARM NAME BARCUS

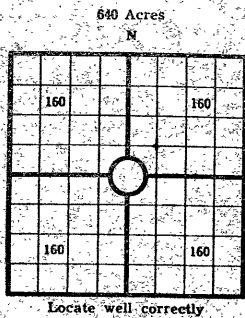

640 Acres
 COUNTY Rawlins SEC. 35 TWP. 5S RGE. 31W
 COMPANY OPERATING JOHN O. FARMER, INC.
 OFFICE ADDRESS Russell, Kansas
 DRILLING STARTED 10/23 59 DRILLING FINISHED 11/4 59
 DATE OF FIRST PRODUCTION _____ COMPLETED _____
 WELL LOCATED SE 1/4 SW 1/4 _____, North of South
 Line and _____ ft. East of West Line of Quarter Section
 Elevation (Relative to sea level) DERRICK FLOOR 2966 GROUND 2963
 CHARACTER OF WELL (Oil, gas or dryhole) Dry

OIL OR GAS SANDS OR ZONES

Name	From	To	Name	From	To
1			4		
2			5		
3			6		

Perforating Record if Any

Shot Record

Formation	From	To	No. of Shots	Formation	From	To	Size of Shot

CASING RECORD

Amount Set						Amount Pulled				Packer Record	
Size	Wt.	Thds.	Make	Ft.	In.	Ft.	In.	Size	Length	Depth Set	Make
8-5/8				238							

Liner Record: Amount _____ Kind _____ Top _____ Bottom _____

CEMENTING AND MUDDING

Size	Amount Set		Sacks Cement	Chemical		Method of Cementing	Amount	Mudding Method	Results (See Note)
	Ft.	In.		Gal.	Make				
8-5/8	238		125						

Note: What method was used to protect sands if outer strings were pulled?

NOTE: Were bottom hole plugs used? _____ If so, state kind, depth set and results obtained _____

TOOLS USED

Rotary Tools were used from _____ feet to _____ Cable tools were used from _____ feet to _____

_____ feet, and from _____ feet to _____ feet, and from _____ feet to _____

Type Rig _____

INITIAL PRODUCTION TEST

Describe initial test: whether by flow through tubing or casing or by pumping _____

Amount of Oil Production _____ bbls. Size of choke, if any _____ Length of test _____ Water

Production _____ bbls. Gravity of oil _____ Type of Pump if pump is used, describe _____

Formation	Top	Bottom	Formation	Top	Bottom
FARM NAME			BARCUS #1		
Sand & shale	0	375			
Shale	375	1900			
Shale-shells	1900	2200			
Shale, pyrite stringers	2200	2335	ELEVATION: RB	2968	
Shale-shells	2335	2675	FORMATION TOPS: sample log		
Shale	2675	2678	Waubunsee	3657	
Anhydrite	2678	3015	Topeka	3739	3785
Shale-shells	3015	3390	Heebner	3962	3962
Lime-shale	3390	3680	Toronto	3993	3994
Shale-lime	3680	3735	Lansing	4010	4010
Lime-shale	3735	4145	B/KC	4245	4238
KC lime	4145	4220	Cherokee	4432	4407
lime-shale	4220	4270	Mississippi	4546	4546
Shale-lime	4270	4320	T.D.	4646	4647
Lime-shale	4320	4570			
Chert	4570	4646			
R.T.D.		4646			

D & A

RECEIVED
 NOV 16 1959
 CONSERVATION DIVISION
 Wichita, Kansas

15-153-30000-205

I, the undersigned, being first duly sworn upon oath, state that this well record is true, correct and complete according to the records of this office and to the best of my knowledge and belief.

John O. Farmer
 Name and title of representative of company

Subscribed and sworn to before me this 13 day of November 19 59

My Commission expires 10/11/62
Luella Kennedy
 Notary Public

State of Kansas



15-153-30000-00-00

GEORGE DOCKING Governor
HARRY G. WILES Chairman
MARION BEATTY Commissioner
RICHARD C. BYRD Commissioner
RAYMOND B. HARVEY Secretary
J. ROBERT WILSON Counsel

State Corporation Commission

CONSERVATION DIVISION

(Oil, Gas and Water)
500 Insurance Bldg. 212 N. Market
WICHITA, KANSAS
JEWEL M. OGDEN, Director

WELL PLUGGING AUTHORITY

November 17, 1959

Well No. 1
Lease Barcus
Description SE SW 35-5-31W
County Rawlins

John O. Farmer Inc.
Russell, Kansas

Gentlemen:

This is your authority to plug the above subject well in accordance with the Rules and Regulations of the State Corporation Commission.

This authority is void after 90 days from the above date.

Very truly yours,

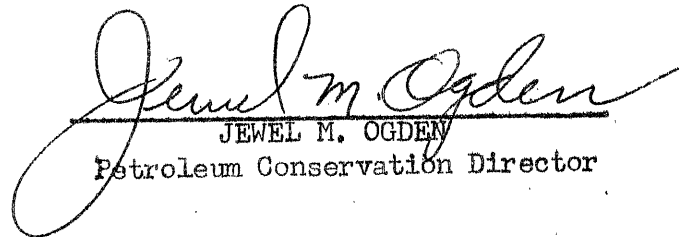
JEWEL M. OGDEN
Petroleum Conservation Director

Mr. Fabricius

is hereby assigned to supervise the plugging of the above named well.

In the event you need any further information regarding this well feel free to write or call me at any time.

J. Lewis Brock
Western Kansas Field Supervisor
P. O. Box 569
Great Bend, Kansas
Phone: GL-33022