

STATE OF KANSAS  
STATE CORPORATION COMMISSION  
CONSERVATION DIVISION  
500 INSURANCE BUILDING  
212 NORTH MARKET  
WICHITA 2, KANSAS

15-153-00040-00-00

WELL PLUGGING APPLICATION FORM  
File One Copy

Lease Owner JOHN O. FARMER, INC. & MUSGROVE PETROLEUM CORPORATION  
(Applicant)  
Address Russell, Kansas & Wichita, Kansas

Lease (Farm Name) FALCONER Well No. 1

Well Location C NW NW Sec. 12 Twp. 5S Rge. (E) (W) 34

County Rawlins Field Name (if any) \_\_\_\_\_

Total Depth 4820 Oil Well    Gas Well    Input Well    SWD Well    D & A x

Was well log filed with application? yes If not, explain: \_\_\_\_\_

Date and hour plugging is desired to begin 6:00 PM 12/9/59

Plugging of the well will be done in accordance with the Rules and Regulations of the State Corporation Commission.

Name of person on the lease in charge of well for owner \_\_\_\_\_

Dale Buchheister Address Plainville, Kansas

Plugging Contractor JOHN O. FARMER, INC. License No. \_\_\_\_\_

Address Russell, Kansas

Invoice covering assessment for plugging this well should be sent to \_\_\_\_\_

JOHN O. FARMER, INC. Address Russell, Kansas

and payment will be guaranteed by applicant.

Signed: John O. Farmer  
Applicant or Acting Agent

Date: December 18, 1959

RECEIVED  
STATE CORPORATION COMMISSION

DEC 21 1959  
CONSERVATION DIVISION  
Wichita, Kansas

12-21-59

OPERATOR JOHN O. FARMER, INC.

FORMATION RECORD

ADDRESS Russell, Kansas

Give detailed description and thickness of all formation drilled through, contents of sand, whether dry, water, oil or gas.

FARM NAME FALCONER WELL NO. 1 COUNTY RAWLINS SEC. 12 TWP. 5S RGE. 34W

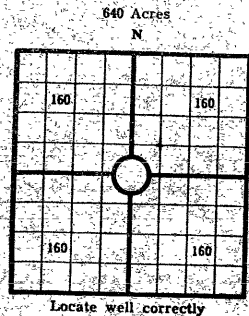

COUNTY Rawlins, SEC. 12, TWP. 5S, RGE. 34W

COMPANY OPERATING JOHN O. FARMER, INC.

OFFICE ADDRESS Russell, Kansas

DRILLING STARTED 11/24/59 DRILLING FINISHED 12/10/59

DATE OF FIRST PRODUCTION \_\_\_\_\_ COMPLETED \_\_\_\_\_

WELL LOCATED NW 1/4 NW 1/4 North of South

Line and \_\_\_\_\_ ft. East of West Line of Quarter Section

Elevation (Relative to sea level) DERRICK FLOOR 3205 GROUND 3202

CHARACTER OF WELL (Oil, gas or dryhole) Dry

OIL OR GAS SANDS OR ZONES

Name	From	To	Name	From	To
1			4		
2			5		
3			6		

Perforating Record If Any

Formation	From	To	No. of Shots	Formation	From	To	Size of Shot

CASING RECORD

Amount Set						Amount Pulled				Packer Record	
Size	Wt.	Thds.	Make	Ft.	In.	Ft.	In.	Size	Length	Depth Set	Make
8-5/8				290							

Liner Record: Amount \_\_\_\_\_ Kind \_\_\_\_\_ Top \_\_\_\_\_ Bottom \_\_\_\_\_

CEMENTING AND MUDDING

Size	Amount Set	Sacks	Chemical		Method	Amount	Mudding	Results
	Ft.	Cement	Gal.	Make	Cementing		Method	(See Note)
8-5/8	290	160						

Note: What method was used to protect sands if outer strings were pulled? \_\_\_\_\_

NOTE: Were bottom hole plugs used? \_\_\_\_\_ If so, state kind, depth set and results obtained \_\_\_\_\_

TOOLS USED

Rotary Tools were used from \_\_\_\_\_ feet to \_\_\_\_\_ feet to \_\_\_\_\_ feet, and from \_\_\_\_\_ feet to \_\_\_\_\_ feet, and from \_\_\_\_\_ feet to \_\_\_\_\_ feet to \_\_\_\_\_ feet.

Type Rig \_\_\_\_\_

INITIAL PRODUCTION TEST

Describe initial test, whether by flow through tubing or casing or by pumping \_\_\_\_\_

Amount of Oil Production \_\_\_\_\_ bbls. Size of choke, if any \_\_\_\_\_ Length of test \_\_\_\_\_ Water

Production \_\_\_\_\_ bbls. Gravity of oil \_\_\_\_\_ Type of Pump if pump is used, describe \_\_\_\_\_

Formation	Top	Bottom	Formation	Top	Bottom
Shale & sand	0	289	ELEVATION: RB sample log Howard Topeka Heebner Toronto Lansing B/KC Cherokee Mississippi T.D.  D & A	3207	
Shale	289	1030			
Shale & sand	1030	1680			
Shale & shells	1680	2250			
Shale, shells & sand w/ pyrite	2250	2565		3879	3878
Shale, lime & redbed	2565	2685		3928	3919
Shale - redbed	2685	2820		4089	4089
Shale & shells	2820	2900		4121	4121
Anhydrite	2900	2932		4139	4137
Shale, shells & redbed	2932	3230		4387	4379
Shale & lime	3230	3750		4555	4554
Lime & shale	3750	4395		4737	4737
Lime	4395	4435		4820	4820
Lime & shale	4435	4620			
Lime & shale & sand	4620	4650			
Shale, sand & Lime	4650	4695			
Lime & shale & sand	4695	4715			
Mississippi	4715	4744			
Shale & lime	4744	4765			
Mississippi	4765	4820			
T.D.		4820			

12-21-59

15-153-00040-00-00

I, the undersigned, being first duly sworn upon oath, state that this well record is true, correct and complete according to the records of this office and to the best of my knowledge and belief.

*John O. Farmer*  
Name and title of representative of company

Subscribed and sworn to before me this 18th day of December, 1959

My Commission expires 10/11/62  
*Livilla Kennedy*  
Notary Public

State of Kansas



15-153-00040-00-00

GEORGE DOCKING Governor  
HARRY G. WILES Chairman  
MARION BEATTY Commissioner  
RICHARD C. BYRD Commissioner  
RAYMOND B. HARVEY Secretary  
J. ROBERT WILSON Counsel

State Corporation Commission

CONSERVATION DIVISION

(Oil, Gas and Water)  
500 Insurance Bldg. 212 N. Market  
WICHITA, KANSAS  
JEWEL M. OGDEN, Director

WELL PLUGGING AUTHORITY

December 21, 1959

Well No. 1  
Lease Falconer  
Description C NW NW 12-5-34W  
County Rawlins

John O. Farmer Inc. & Musgrove Petr. Corp  
Russell, Kansas

Gentlemen:

This is your authority to plug the above subject well in accordance with the Rules and Regulations of the State Corporation Commission.

This authority is void after 90 days from the above date.

Very truly yours,

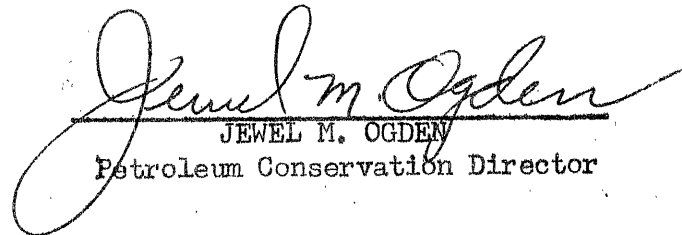
  
JEWEL M. OGDEN  
Petroleum Conservation Director

Mr. Fabricius  
is hereby assigned to supervise the plugging of the above named well.

In the event you need any further information regarding this well feel free to write or call me at any time.

J. Lewis Brock  
Western Kansas Field Supervisor  
P. O. Box 569  
Great Bend, Kansas  
Phone: GL-33022