

STATE CORPORATION COMMISSION OF KANSAS
OIL & GAS CONSERVATION DIVISION
WELL COMPLETION OR RECOMPLETION FORM
ACO-1 WELL HISTORY
DESCRIPTION OF WELL AND LEASE

Operator: License # 8925
Name Liberty Operations & Completions, Inc.
Address 308 West Mill
City/State/Zip Plainville, Ks. 67663
Purchaser Farmland Industries, Inc.
Operator Contact Person Charles G. Comeau
Phone 913-434-4686
Contractor: License # 5665
Name Pioneer Drilling Company, Inc.
Wellsite Geologist Kevin Adams
Phone 913-628-6698

Designate Type of Completion
 New Well Re-Entry Workover
 Oil SWD Temp Abd
 Gas Inj Delayed Comp.
 Dry Other (Core, Water Supply etc.)
If OWO: old well info as follows:
Operator
Well Name
Comp. Date Old Total Depth

WELL HISTORY

Drilling Method:
 Mud Rotary Air Rotary Cable
9-02-85 9-07-85 9-19-85
Spud Date Date Reached TD Completion Date
3750' 3730'
Total Depth PBTD

Amount of Surface Pipe Set and Cemented at 257' feet
Multiple Stage Cementing Collar Used? Yes No
If yes, show depth set 1772' feet
If alternate 2 completion, cement circulated
from 1772' feet depth to surface / 350' SX cmt
Cement Company Name Allied Cementing Co., Inc.
Invoice # 44133

INSTRUCTIONS: This form shall be completed in duplicate and filed with the Kansas Corporation Commission, 200 Colorado Derby Building, Wichita, Kansas 67202, within 90 days after completion or recompletion of any well. Rule 82-3-130 and 82-3-107 apply.
Information on side two of this form will be held confidential for a period of 12 months if requested in writing and submitted with the form. See rule 82-3-107 for confidentiality in excess of 12 months.
One copy of all wireline logs and drillers time log shall be attached with this form. Submit CP-4 form with all plugged wells. Submit CP-111 form with all temporarily abandoned wells.

All requirements of the statutes, rules and regulations promulgated to regulate the oil and gas industry have been fully complied with and the statements herein are complete and correct to the best of my knowledge.

Signature Charles G. Comeau
Title Petroleum Geologist Date 9-23-85
Subscribed and sworn to before me this 23rd day of September 1985
Notary Public Jolene Garvert
Date Commission Expires 3-9-88

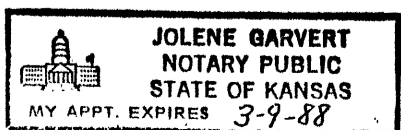

API No. 15-163-22,710
County Rooks
SE SE SE 17 6S 20 East
330 Ft North from Southeast Corner of Section
330 Ft West from Southeast Corner of Section
(Note: Locate well in section plat below)
Lease Name Freeman States Well # 1
Field Name TODD, NE
Producing Formation Arbuckle
Elevation: Ground 2206' 2211' KB

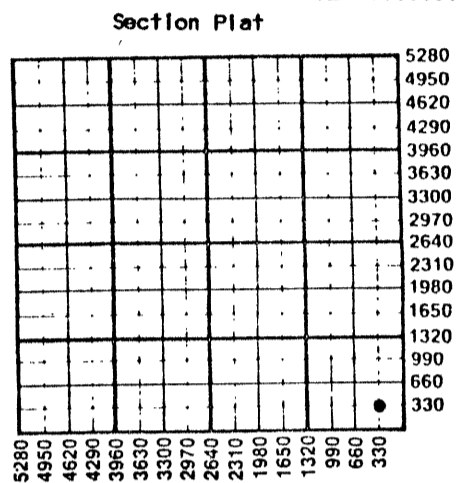

WATER SUPPLY INFORMATION
Disposition of Produced Water: Disposal
Docket # Repressuring

Questions on this portion of the ACO-1 call:
Water Resources Board (913) 296-3717
Source of Water: Farm Pond
Division of Water Resources Permit #
Groundwater Ft North from Southeast Corner (Well) Ft West from Southeast Corner of Sec Twp Rge East West
Surface Water Ft North from Southeast Corner (Stream, pond etc) Ft West from Southeast Corner Sec Twp Rge East West
Other (explain) (purchased from city, R.W.D. #)

K.C.C. OFFICE USE ONLY
F Letter of Confidentiality Attached
C Wireline Log Received
C Drillers Timelog Received
Distribution
 KCC SWD/Rep NGPA
 KGS Plug Other
(Specify)

STATE CORPORATION COMMISSION
ACO-1 (7-84)
OCT 2 1985
10-2-85
CONSERVATION DIVISION
Wichita, Kansas

Sec 17 Twp 6 Rge 20 E

SIDE TWO

Operator Name Liberty Operations & Completions, Inc. Lease Name Freeport Well #
 Sec 17 Twp 6S Rge 20 East West County Rocks

WELL LOG

INSTRUCTIONS: Show important tops and base of formations penetrated. Detail all cores. Report all drill stem tests giving interval tested, time tool open and closed, flowing and shut-in pressures, whether shut-in pressure reached static level, hydrostatic pressures, bottom hole temperature, fluid recovery, and flow rates if gas to surface during test. Attach extra sheet if more space is needed. Attach copy of log.

Drill Stem Tests Taken Yes No
 Samples Sent to Geological Survey Yes No
 Cores Taken Yes No

Formation Description
 Log Sample

LOG TOPS

Anhydrite 1815 (+396)
 Topeka 3216 (-1005)
 Heebner 3418 (-1207)
 Toronto 3442 (-1231)
 Lansing/KC 3454 (-1243)
 Base/KC 3651 (-1440)
 Marmaton 3669 (-1458)
 Arbuckle 3690 (-1479)

Name	Top	Bottom
sand and shale	0'	50'
sand and shale	50'	259'
shale and sand	259'	1140'
shale and sand	1140'	1820'
anhydrite	1820'	1851'
shale	1851'	1902'
shale	1902'	2250'
shale	2250'	2460'
shale and lime	2460'	2719'
shale and lime	2719'	2925'
lime and shale	2925'	3130'
lime and shale	3130'	3278'
lime and shale	3278'	3415'
lime and shale	3415'	3525'
lime and shale	3525'	3638'
lime and shale	3638'	3750'
arbuckle	3750'	3750'
	3750'	R.T.D.

CASING RECORD New Used
 Report all strings set-conductor, surface, intermediate, production, etc.

Purpose of String	Size Hole Drilled	Size Casing Set (In O.D.)	Weight Lbs/Ft.	Setting Depth	Type of Cement	#Sacks Used	Type and Percent Additives
Surface Casing	12 1/4"	8 5/8"	20#	257'	60-40pos	160	2%gel 3%cc
Production (1)	7 7/8"	4 1/2"	10.5#	3741.22'	60-40pos	175	8%salt 5%gilsonite
" (2)	"	"	"	"	50-50pos	350	6%gel

Shots Per Foot	Specify Footage of Each Interval Perforated	Acid, Fracture, Shot, Cement Squeeze Record (Amount and Kind of Material Used)	Depth
2/foot	3691-3704'	500 gal. 15% D.F.E. retreated w/750 gal. 15% D.F.E., 5% checker-sol hot acid	3691-3704'
		1000 gal. 15% D.F.E., 5% checker-sol hot acid	

TUBING RECORD	Size	Set At	Packer at	Liner Run	<input type="checkbox"/> Yes <input checked="" type="checkbox"/> No	retr. w/1000 gal. 15% D.F.E.
	2 3/8"	3724'				

Date of First Production	Producing Method
9-20-85	<input type="checkbox"/> Flowing <input checked="" type="checkbox"/> Pumping <input type="checkbox"/> Gas Lift <input type="checkbox"/> Other (explain).....

Estimated Production Per 24 Hours	Oil	Gas	Water	Gas-Oil Ratio	Gravity
	40 Bbls	MCF	20 Bbls	CFPB	

METHOD OF COMPLETION

Production Interval

Disposition of gas: Vented Open Hole Perforation
 Sold Other (Specify) 3691-3704'
 Used on Lease Dually Completed
 Commingled

