

STATE OF KANSAS
STATE CORPORATION COMMISSION
CONSERVATION DIVISION
800 BITTING BUILDING
WICHITA, KANSAS

15-163-00684-00-00

WELL PLUGGING APPLICATION FORM
File One Copy

Lease Owner Jones, Shelburne Address Russell, Kansas
(Applicant) & Farmer, Inc.
Lease (Farm Name) Attaberry Well No. 1

Well Location SE SE NW Sec. 22 Twp. 6 Rge. (E) - (W) 20

County Rooks Field Name (if any) Wildcat

Total Depth 3772 Oil Gas Dry Hole X

Was well log filed with application? yes If not, explain:

Date and hour plugging is desired to begin 4:30 P.M. 4-30-54

Plugging of the well will be done in accordance with the Rules and Regulations of the State Corporation Commission.

Name of the person on the lease in charge of well for owner

Clay Wiley Address Russell

Plugging Contractor Jones, Shelburne & Farmer, Inc.

Plugging Contractor's License No.

Address Russell, Kansas

Invoice covering assessment for plugging this well should be sent to

Jones, Shelburne & Farmer, Inc. Address Russell, Kansas

and payment will be guaranteed by applicant.

RECEIVED
STATE CORPORATION COMMISSION

MAY 7 - 1954

CONSERVATION DIVISION
Wichita, Kansas

John W. Farmer
Applicant or Acting Agent

Date May 1, 1954

PLUGGING
FILE SEC 22 T 6 R 20W
BOOK PAGE 31 LINE 32

5-7-54

OPERATOR Jones, Shelburne & Farmer, Inc.ADDRESS Russell, Kansas

FORMATION RECORD

Give detailed description and thickness of all formations drilled through, contents of sand, whether dry, water, oil or gas.

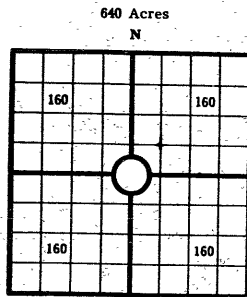
FARM NAME Attaberry WELL NO. 1 COUNTY Rooks SEC. 22 TWP. 6 RGE. 20COUNTY Rooks SEC. 22 TWP. 6 RGE. 20COMPANY OPERATING Jones, Shelburne & Farmer, Inc.OFFICE ADDRESS Russell, KansasFARM NAME Attaberry WELL NO. 1DRILLING STARTED 4-20, 1954 DRILLING FINISHED 4-29, 1954

DATE OF FIRST PRODUCTION _____ COMPLETED _____

WELL LOCATED SE 1/4 SE 1/4 NW 1/4 North of South

Line and _____ ft. East of West Line of Quarter Section:

Elevation (Relative to sea level) DERRICK FLOOR 2184 GROUND _____CHARACTER OF WELL (Oil, gas or dryhole) Dry

OIL OR GAS SANDS OR ZONES

Name	From	To	Name	From	To
1			4		
2			5		
3			6		

Perforating Record If Any

Shot Record

Formation	From	To	No. of Shots	Formation	From	To	Size of Shot

CASING RECORD

Amount Set								Amount Pulled		Packer Record	
Size	Wt.	Thds.	Make	Ft.	In.	Ft.	In.	Size	Length	Depth Set	Make
8 5/8				158							

Liner Record: Amount _____ Kind _____ Top _____ Bottom _____

CEMENTING AND MUDDING

Size	Amount Set		Sacks Cement	Chemical		Method of Cementing	Amount	Mudding Method	Results (See Note)
	Ft.	In.		Gal.	Make				
8 5/8	158		100						

Note: What method was used to protect sands if outer strings were pulled? _____

NOTE: Were bottom hole plugs used? _____ If so, state kind, depth set and results obtained _____

TOOLS USED

Rotary Tools were used from _____ feet to _____ feet. Cable tools were used from _____ feet to _____ feet, and from _____ feet to _____ feet, and from _____ feet to _____ feet.
Type Rig _____

INITIAL PRODUCTION TEST

Describe initial test: whether by flow through tubing or casing or by pumping _____

Amount of Oil Production _____ bbls. Size of choke, if any _____ Length of test _____ Water Production _____ bbls. Gravity of oil _____ Type of Pump if pump is used, describe _____

I, the undersigned, being first duly sworn upon oath, state that this well record is true, correct and complete according to the records of this office and to the best of my knowledge and belief.

Phil Farmer Vice-Pres.
Name and title of representative of company

Subscribed and sworn to before me this 1st day of May 1954
My Commission expires April 23, 1956
Donnie Berryhill
Notary Public.

Formation	Top	Bottom	Formation	Top	Bottom
Shale	0	250			
Sand & shale	250	1150			
Sand, redbed & shale	1150	1790			
Anhydrite	1790	1825			
Shale & shells	1825	2380			
Shale & lime	2380	2660			
Lime & shale	2660	3548			
Shale & lime	3548	3610			
Lime & shale	3610	3693			
Cong.	3693	3755			
Cong.	3755	3770			

TOPS:
Elevation 2186 R. B.
Heebner 3397
Toronto 3418
Lansing 3434
Arbuckle 3740
T. D. 3772

RECEIVED
STATE COMMISSION
MAY 7 - 1954

PLUGGING
FRI SEC 22 T 6 N 20W
BOOK PAGE 31 LINE 32

15-163-00684-00-00



STATE OF KANSAS
STATE CORPORATION COMMISSION
CONSERVATION DIVISION
800 BITTING BUILDING
WICHITA, KANSAS

May 3, 1954

15-163-00684-00-00

Well No.	1
Lease	Atterberry
Description	SE SE NW 22-6-20W
County	Rooks
File No.	R-32

~~Jones-Shelburne-Farmer~~
Russell
Kansas

Gentlemen:

This letter is your authority to plug the above subject well, in accordance with the Rules and Regulations of the State Corporation Commission. When you are ready to plug this well, please contact our District Plugging Supervisor, Mr. Eldon Petty, Box 326, Hays, Kansas.

STATE CORPORATION COMMISSION
CONSERVATION DIVISION

BY:

J. P. ROBERTS

cc: District Plugging Supervisor