

For KCC Use: 3-8-05
Effective Date: _____
District # 1

KANSAS CORPORATION COMMISSION
OIL & GAS CONSERVATION DIVISION

Form C-1
September 1999
Form must be Typed
Form must be Signed
All blanks must be Filled

NOTICE OF INTENT TO DRILL

Must be approved by KCC five (5) days prior to commencing well

Expected Spud Date March 7 2005

Spot App. C NW Sec. 32 Twp. 23S S. R. 15W East West
1320 FNL feet from S / (N) (circle one) Line of Section
1300 FWL feet from E / (W) (circle one) Line of Section
Is SECTION Regular Irregular?

OPERATOR: License# 6015 (16-30-05)
Name: Cambria Corporation
Address: P.O. Box 1065
City/State/Zip: Great Bend, Kansas 67530
Contact Person: Robert D. Dougherty
Phone: 620-793-9055

(Note: Locate well on the Section Plat on reverse side)
County: Pawnee
Lease Name: Becker Trust Well #: 1
Field Name: Benson

CONTRACTOR: License# _____
Name: Will Advise on ACO-1

Is this a Prorated / Spaced Field? Yes No

Target Information(s): Wabaunsee

Nearest Lease or unit boundary: 1300 ft.

Ground Surface Elevation: est. 2040 feet MSL

Water well within one-quarter mile: Yes No

Public water supply well within one mile: Yes No

Depth to bottom of fresh water: 120 ft.

Depth to bottom of usable water: 280 ft.

Surface Pipe by Alternate: X 1 2

Length of Surface Pipe Planned to be set: 300' per op

Length of Conductor Pipe required: none

Projected Total Depth: 3100 ft.

Producing Formation Target: Wabaunsee

Water Source for Drilling Operations:

Well Farm Pond Other

DWR Permit #: _____

(Note: Apply for Permit with DWR)

Will Cores be taken? Yes No

If Yes, proposed zone: _____

Well Drilled For: Oil Enh Rec Infield Mud Rotary
 Gas Storage Pool Ext. Air Rotary
 OWO Disposal Wildcat Cable
 Seismic; # of Holes Other

If OWWO: old well information as follows:
Operator: _____
Well Name: _____
Original Completion Date: _____ Original Total Depth: _____

Directional, Deviated or Horizontal wellbore? Yes No

If Yes, true vertical depth: _____

Bottom Hole Location: _____

KCC DKT #: _____

* W/IN AREA OF QUINOCO SINKHOLE
CONTACT KCC DISTRICT #1
(620) 225-8888

AFFIDAVIT

The undersigned hereby affirms that the drilling, completion and eventual plugging of this well will comply with K.S.A. 55-101, et. seq.

It is agreed that the following minimum requirements will be met:

1. Notify the appropriate district office *prior* to spudding of well;
2. A copy of the approved notice of intent to drill *shall be* posted on each drilling rig;
3. The minimum amount of surface pipe as specified below *shall be set* by circulating cement to the top; in all cases surface pipe *shall be set* through all unconsolidated materials plus a minimum of 20 feet into the underlying formation.
4. If the well is dry hole, an agreement between the operator and the district office on plug length and placement is necessary *prior to plugging*;
5. The appropriate district office will be notified before well is either plugged or production casing is cemented in;
6. If an ALTERNATE II COMPLETION, production pipe shall be cemented from below any usable water to surface within **120 days** of spud date. *In all cases, NOTIFY district office* prior to any cementing.

I hereby certify that the statements made herein are true and to the best of my knowledge and belief.

Date: Feb 28, 2005 Signature of Operator or Agent: Robert D. Dougherty Title: President

For KCC Use ONLY
API # 15 - 145-21515-00-00
Conductor pipe required NONE feet
Minimum surface pipe required 300 feet per Alt. (1)
Approved by RSP 3-305
This authorization expires: 9-3-05
(This authorization void if drilling not started within 6 months of effective date.)
Spud date: _____ Agent: _____

Remember to:

- File Drill Pit Application (form CDP-1) with Intent to Drill;
- File Completion Form ACO-1 within 120 days of spud date;
- File acreage attribution plat according to field proration orders;
- Notify appropriate district office 48 hours prior to workover or re-entry;
- Submit plugging report (CP-4) after plugging is completed;
- Obtain written approval before disposing or injecting salt water.

RECEIVED

MAR 02 2005

KCC WICHITA

Mail to: KCC - Conservation Division, 130 S. Market - Room 2078, Wichita, Kansas 67202

32 23 15W

IN ALL CASES PLOT THE INTENDED WELL ON THE PLAT BELOW

Plat of acreage attributable to a well in a prorated or spaced field

If the intended well is in a prorated or spaced field, please fully complete this side of the form. If the intended well is in a prorated or spaced field complete the plat below showing that the well will be properly located in relationship to other wells producing from the common source of supply. Please show all the wells and within 1 mile of the boundaries of the proposed acreage attribution unit for gas wells and within 1/2 mile of the boundaries of the proposed acreage attribution unit for oil wells.

API No. 15 - _____
 Operator: Cambria Corporation
 Lease: Becker Trust
 Well Number: 1
 Field: Benson

Number of Acres attributable to well: _____
 QTR / QTR / QTR of acreage: _____ C _____ NW

Location of Well: County: Pawnee
1320 fnl _____ feet from S / N (circle one) Line of Section
1300 fwl _____ feet from E / W (circle one) Line of Section
 Sec. 32 Twp. 23S S. R. 15W East West

Is Section Regular or _____ Irregular

If Section is Irregular, locate well from nearest corner boundary.
 Section corner used: ___ NE ___ NW ___ SE ___ SW

PLAT

*(Show location of the well and shade attributable acreage for prorated or spaced wells.)
 (Show footage to the nearest lease or unit boundary line.)*

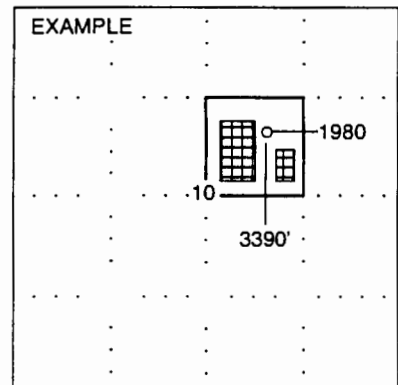
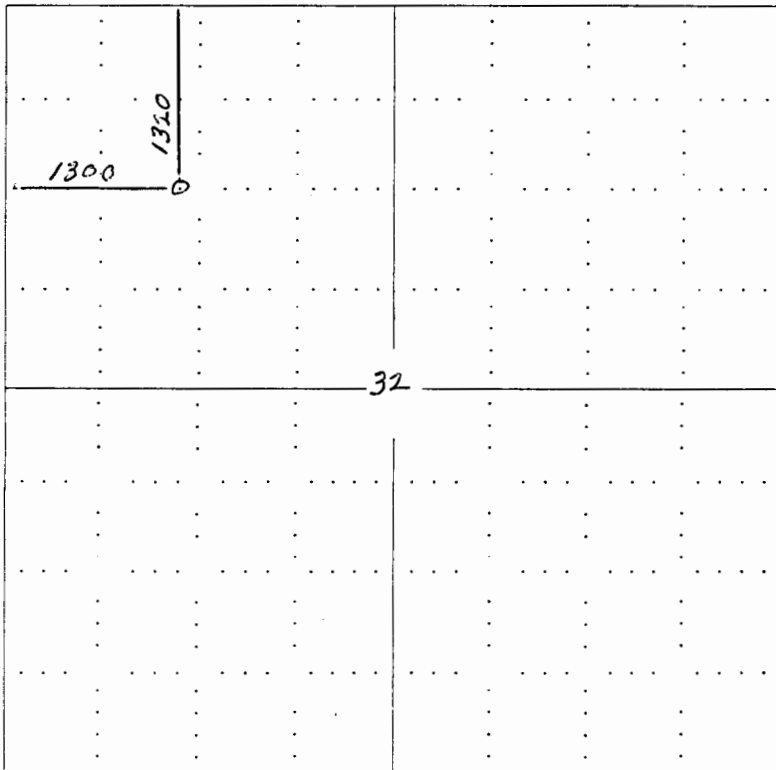

SEWARD CO.

NOTE: In all cases locate the spot of the proposed drilling locaton.

In plotting the proposed location of the well, you must show:

1. The manner in which you are using the depicted plat by identifying section lines, i.e. 1 section, 1 section with 8 surrounding sections, 4 sections, etc.
2. The distance of the proposed drilling location from the section's south / north and east / west.
3. The distance to the nearest lease or unit boundary line.
4. If proposed location is located within a prorated or spaced field a certificate of acreage attribution plat must be attached: (CO-7 for oil wells; CG-8 for gas wells).

KANSAS

CORPORATION COMMISSION

KATHLEEN SEBELIUS, GOVERNOR
BRIAN J. MOLINE, CHAIR
ROBERT E. KREHBIEL, COMMISSIONER
MICHAEL C. MOFFET, COMMISSIONER

March 3, 2005

Mr. Robert D. Dougherty
Cambria Corporation
PO Box 1065
Great Bend, KS 67530

RE: Drilling Pit Application
Becker Trust Lease Well No. 1
NW/4 Sec. 32-23S-15W
Pawnee County, Kansas

Dear Mr. Dougherty:

District staff has inspected the above referenced location and has determined that the reserve pit shall be constructed **without slots**, the bottom shall be flat and reasonably level, and the free fluids must be removed. The fluids are to be removed from the reserve pit as soon as the Hutchinson Salt section has been drilled through and displacement of the fluids into the reserve pit has occurred. The fluids should be removed again as soon as practical after drilling operations have ceased.

If production casing is set all completion fluids shall be removed on a daily basis.

The fluids should be taken to an authorized disposal well. Please call the District Office at (620) 225-8888 when the fluids have been removed. Also please file the enclosed CDP-5 form, Surface Pond Waste Transfer, within 30 days of fluid removal.

A copy of this letter should be posted in the doghouse along with the approved Intent to Drill.

If you have any questions or concerns please feel free to contact the undersigned at the above address.

Sincerely,

Kathy Haynes

Environmental Protection and Remediation Department

cc: S Durrant