

MAR 10 2005

Form C-1
September 1999
Form must be Typed
Form must be Signed
blanks must be Filled

For KCC Use: 3-15-05
Effective Date: 4
District # _____
SGA? Yes No

KANSAS CORPORATION COMMISSION
OIL & GAS CONSERVATION DIVISION

NOTICE OF INTENT TO DRILL

Must be approved by KCC five (5) days prior to commencing work WICHITA, KS

Expected Spud Date 03 16 2005
month day year

OPERATOR: License# 31652
Name: Norstar Petroleum Inc.
Address: 5 Inverness Drive East, Suite 120
City/State/Zip: Englewood, CO 80112
Contact Person: Per Burchardt
Phone: (303) 925-0696

CONTRACTOR: License# 31548
Name: Discovery Drilling

<input checked="" type="checkbox"/> Oil	<input type="checkbox"/> Enh Rec	<input checked="" type="checkbox"/> Infield	<input checked="" type="checkbox"/> Mud Rotary
<input type="checkbox"/> Gas	<input type="checkbox"/> Storage	<input type="checkbox"/> Pool Ext.	<input type="checkbox"/> Air Rotary
<input type="checkbox"/> OWWO	<input type="checkbox"/> Disposal	<input type="checkbox"/> Wildcat	<input type="checkbox"/> Cable
<input type="checkbox"/> Seismic; _____ # of Holes	<input type="checkbox"/> Other		

If OWWO: old well information as follows:
Operator: _____
Well Name: _____
Original Completion Date: _____ Original Total Depth: _____

Directional, Deviated or Horizontal wellbore? Yes No

If Yes, true vertical depth: _____

Bottom Hole Location: _____

KCC DKT #: _____

Spot 20' A N. of
W/2 - W/2 - SW Sec. 27 Twp. 15 S. R. 12
1340 feet from S / N (circle one) Line of Section
330 feet from E / W (circle one) Line of Section
Is SECTION Regular Irregular?

(Note: Locate well on the Section Plat on reverse side)

County: Russell
Lease Name: Pfister-Kaufman Unit Well #: 1-27
Field Name: Hall Gurney

Is this a Prorated / Spaced Field? Yes No

Target Formation(s): Arbuckle

Nearest Lease or unit boundary: 310 ft.

Ground Surface Elevation: Est. 1750 ft. feet MSL

Water well within one-quarter mile: Yes No

Public water supply well within one mile: Yes No

Depth to bottom of fresh water: 180 ft.

Depth to bottom of usable water: 380 ft.

Surface Pipe by Alternate: 1 2

Length of Surface Pipe Planned to be set: 230 ft.

Length of Conductor Pipe required: _____

Projected Total Depth: 3250 ft.

Formation at Total Depth: Arbuckle

Water Source for Drilling Operations:

Well Farm Pond Other _____

DWR Permit #: _____

(Note: Apply for Permit with DWR)

Will Cores be taken? Yes No

If Yes, proposed zone: _____

AFFIDAVIT

The undersigned hereby affirms that the drilling, completion and eventual plugging of this well will comply with K.S.A. 55-101, et. seq.

It is agreed that the following minimum requirements will be met:

1. Notify the appropriate district office **prior** to spudding of well;
2. A copy of the approved notice of intent to drill **shall be** posted on each drilling rig;
3. The minimum amount of surface pipe as specified below **shall be set** by circulating cement to the top; in all cases surface pipe **shall be set** through all unconsolidated materials plus a minimum of 20 feet into the underlying formation.
4. If the well is dry hole, an agreement between the operator and the district office on plug length and placement is necessary **prior to plugging**;
5. The appropriate district office will be notified before well is either plugged or production casing is cemented in;
6. If an ALTERNATE II COMPLETION, production pipe shall be cemented from below any usable water to surface within **120 days** of spud date. **In all cases, NOTIFY district office** prior to any cementing.

I hereby certify that the statements made herein are true and to the best of my knowledge and belief.

Date: 3/8/05 Signature of Operator or Agent: [Signature] Title: PRESIDENT

For KCC Use ONLY
API # 15 - 167-23281-00-00
Conductor pipe required NONE feet
Minimum surface pipe required 200 feet per Alt. + (2)
Approved by: RJP 3-10-05
This authorization expires: 9-10-05
(This authorization void if drilling not started within 6 months of effective date.)
Spud date: _____ Agent: _____

Remember to:

- File Drill Pit Application (form CDP-1) with Intent to Drill;
- File Completion Form ACO-1 within 120 days of spud date;
- File acreage attribution plat according to field proration orders;
- Notify appropriate district office 48 hours prior to workover or re-entry;
- Submit plugging report (CP-4) after plugging is completed;
- Obtain written approval before disposing or injecting salt water.

27 15 12W

IN ALL CASES PLOT THE INTENDED WELL ON THE PLAT BELOW

Plat of acreage attributable to a well in a prorated or spaced field

If the intended well is in a prorated or spaced field, please fully complete this side of the form. If the intended well is in a prorated or spaced field complete the plat below showing that the well will be properly located in relationship to other wells producing from the common source of supply. Please show all the wells and within 1 mile of the boundaries of the proposed acreage attribution unit for gas wells and within 1/2 mile of the boundaries of the proposed acreage attribution unit for oil wells.

API No. 15 - _____
 Operator: Norstar Petroleum Inc.
 Lease: Pfister-Kaufman Unit
 Well Number: 1-27
 Field: Hall Gurney
 Number of Acres attributable to well: 10
 QTR / QTR / QTR of acreage: W/2 - W/2 - SW

Location of Well: County: Russell

 1340 feet from S / N (circle one) Line of Section

 330 feet from E / W (circle one) Line of Section
 Sec. 27 Twp. 15 S. R. 12 East West

Is Section Regular or _____ Irregular

If Section is Irregular, locate well from nearest corner boundary.

Section corner used: ___ NE ___ NW ___ SE ___ SW

PLAT

*(Show location of the well and shade attributable acreage for prorated or spaced wells.)
 (Show footage to the nearest lease or unit boundary line.)*

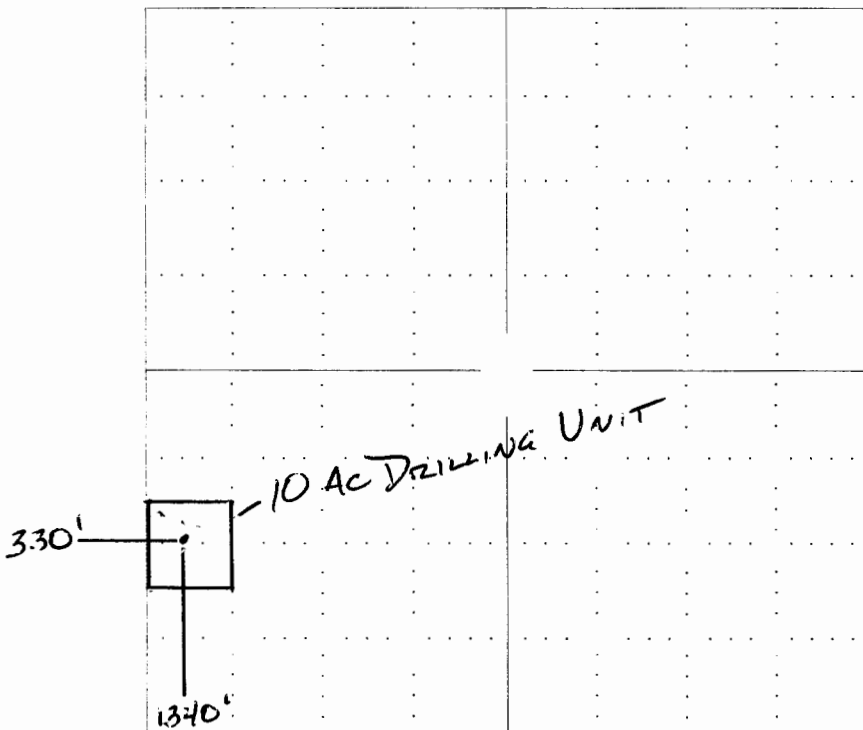

NOTE: In all cases locate the spot of the proposed drilling location.

RECEIVED
 KANSAS CORPORATION COMMISSION
MAR 10 2005
 CONSERVATION DIVISION
 WICHITA, KS

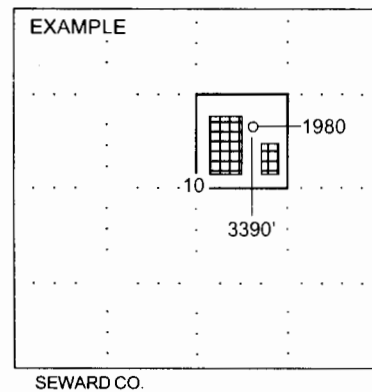

In plotting the proposed location of the well, you must show:

1. The manner in which you are using the depicted plat by identifying section lines, i.e. 1 section, 1 section with 8 surrounding sections, 4 sections, etc.
2. The distance of the proposed drilling location from the section's south / north and east / west.
3. The distance to the nearest lease or unit boundary line.
4. If proposed location is located within a prorated or spaced field a certificate of acreage attribution plat must be attached: (C0-7 for oil wells; CG-8 for gas wells).