

FIRST  
CORRECTED

For KCC Use:  
Effective Date: 11-18-01  
District # 1  
SGA?  Yes  No

KANSAS CORPORATION COMMISSION  
OIL & GAS CONSERVATION DIVISION

NOTICE OF INTENT TO DRILL

Must be approved by KCC five (5) days prior to commencing well

CONSERVATION DIVISION  
WICHITA, KS

Expected Spud Date 11 15 01  
month day year

Spot NE SE Sec. 3 Twp. 20 S. R. 19  East  West  
1980 feet from (S) N (circle one) Line of Section  
1980 feet from (E) W (circle one) Line of Section  
Is SECTION  Regular  Irregular?

OPERATOR: License# 32302  
Name: Key Gas Corp  
Address: 410 Urban Dr.  
City/State/Zip: Hutchinson, Ks 67501  
Contact Person: Rod Andersen  
Phone: (316) 993-2740

(Note: Locate well on the Section Plat on reverse side)

County: Pawnee  
Lease Name: Snodgrass Well #: 1-3

CONTRACTOR: License# BE LICENSED WITH KCC  
Name: \_\_\_\_\_

Field Name: \_\_\_\_\_  
Is this a Prorated / Spaced Field?  Yes  No

Well Drilled For:  Oil  Enh Rec  Infield  Gas  Storage  Pool Ext.  OWWO  Disposal  Wildcat  Seismic; # of Holes  Other  
Type Equipment:  Mud Rotary  Air Rotary  Cable

Target Formation(s): Chase  
Nearest Lease or unit boundary: 660'

Ground Surface Elevation: 2222' feet MSL  
Water well within one-quarter mile:  Yes  No

Public water supply well within one mile:  Yes  No  
Depth to bottom of fresh water: 180'  
Depth to bottom of usable water: 380' 520'

If OWWO: old well information as follows:  
Operator: \_\_\_\_\_  
Well Name: \_\_\_\_\_  
Original Completion Date: \_\_\_\_\_ Original Total Depth: \_\_\_\_\_

\* Length of Surface Pipe Planned to be set: 400 540'  
Length of Conductor Pipe required: \_\_\_\_\_

Directional, Deviated or Horizontal wellbore?  Yes  No  
If Yes, true vertical depth: \_\_\_\_\_

Projected Total Depth: 2700'  
Formation at Total Depth: Chase

Bottom Hole Location: \_\_\_\_\_  
KCC DKT #: \_\_\_\_\_

Water Source for Drilling Operations:  
Well \_\_\_\_\_ Farm Pond \_\_\_\_\_ Other

DWR Permit #: \_\_\_\_\_  
(Note: Apply for Permit with DWR )

Will Cores be taken?  Yes  No  
If Yes, proposed zone: \_\_\_\_\_

NOTE:  
\* Min. surface eq. for ALT I = 540'

AFFIDAVIT

\* WAS: NESW

The undersigned hereby affirms that the drilling, completion and eventual plugging of this well will comply with K.S.A. 55-101, et. seq.  
It is agreed that the following minimum requirements will be met:

\* IS: NE SE

1. Notify the appropriate district office **prior** to spudding of well;
2. A copy of the approved notice of intent to drill **shall be** posted on each drilling rig;
3. The minimum amount of surface pipe as specified below **shall be set** by circulating cement to the top; in all cases surface pipe **shall be set** through all unconsolidated materials plus a minimum of 20 feet into the underlying formation.
4. If the well is dry hole, an agreement between the operator and the district office on plug length and placement is necessary **prior to plugging**;
5. The appropriate district office will be notified before well is either plugged or production casing is cemented in;
6. If an ALTERNATE II COMPLETION, production pipe shall be cemented from below any usable water to surface within **120 days** of spud date. **In all cases, NOTIFY district office** prior to any cementing.

I hereby certify that the statements made herein are true and to the best of my knowledge and belief.

Date: 10/20/01 Signature of Operator or Agent: Rod Andersen Title: Agent

For KCC Use ONLY  
API # 15 - 145-21475-0000  
Conductor pipe required NONE feet  
Minimum surface pipe required 540' feet per Alt.   
Approved by: DPW 11-13-01/RJP 4-1-05  
This authorization expires: 5-13-02  
(This authorization void if drilling not started within 6 months of effective date.)  
Spud date: \_\_\_\_\_ Agent: \_\_\_\_\_

Remember to:

- File Drill Pit Application (form CDP-1) with Intent to Drill;
- File Completion Form ACO-1 within 120 days of spud date;
- File acreage attribution plat according to field proration orders;
- Notify appropriate district office 48 hours prior to workover or re-entry;
- Submit plugging report (CP-4) after plugging is completed;
- Obtain written approval before disposing or injecting salt water.

3  
20  
19w

**IN ALL CASES PLOT THE INTENDED WELL ON THE PLAT BELOW**

*Plat of acreage attributable to a well in a prorated or spaced field*

**If the intended well is in a prorated or spaced field, please fully complete this side of the form.** If the intended well is in a prorated or spaced field complete the plat below showing that the well will be properly located in relationship to other wells producing from the common source of supply. Please show all the wells and within 1 mile of the boundaries of the proposed acreage attribution unit for gas wells and within 1/2 mile of the boundaries of the proposed acreage attribution unit for oil wells.

API No. 15 - \_\_\_\_\_  
 Operator: Key Gas Corp  
 Lease: Snodgrass  
 Well Number: 1-3  
 Field: \_\_\_\_\_

Location of Well: County: Pawnee  
 \_\_\_\_\_  
1980 feet from S / N (circle one) Line of Section  
 \_\_\_\_\_  
1980 feet from E / W (circle one) Line of Section  
 Sec. 3 Twp. 20 S. R. 19  East  West

Number of Acres attributable to well: \_\_\_\_\_  
 QTR / QTR / QTR of acreage: \_\_\_\_\_ - NE - SE

Is Section X Regular or \_\_\_\_\_ Irregular  
**If Section is Irregular, locate well from nearest corner boundary.**  
 Section corner used: \_\_\_ NE \_\_\_ NW \_\_\_ SE \_\_\_ SW

**PLAT**

*(Show location of the well and shade attributable acreage for prorated or spaced wells.)  
 (Show footage to the nearest lease or unit boundary line.)*

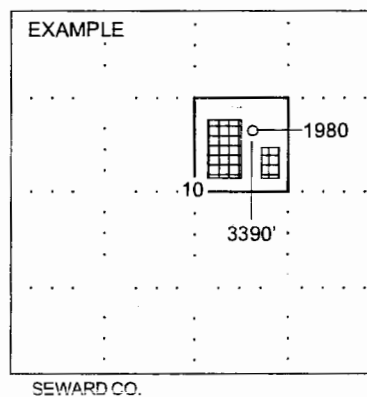
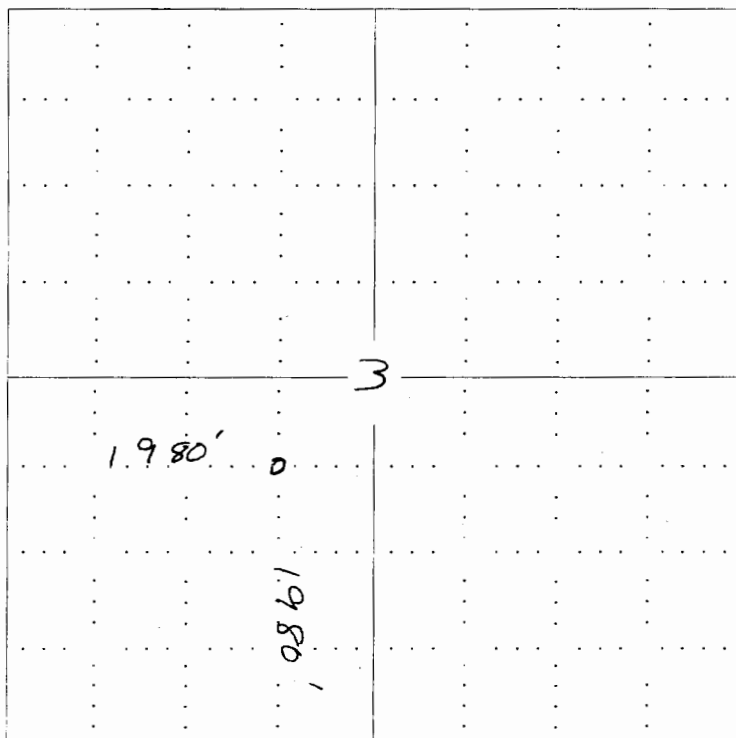

**NOTE: In all cases locate the spot of the proposed drilling location.**

**In plotting the proposed location of the well, you must show:**

1. The manner in which you are using the depicted plat by identifying section lines, i.e. 1 section, 1 section with 8 surrounding sections, 4 sections, etc.
2. The distance of the proposed drilling location from the section's south / north and east / west.
3. The distance to the nearest lease or unit boundary line.
4. If proposed location is located within a prorated or spaced field a certificate of acreage attribution plat must be attached: (CO-7 for oil wells; CG-8 for gas wells).