

STATE OF KANSAS  
STATE CORPORATION COMMISSION  
CONSERVATION DIVISION  
P. O. BOX 17027  
Wichita, Kansas 67217

Rev. 3-15-72  
FORM CP-1

RECEIVED  
STATE CORPORATION COMMISSION

WELL PLUGGING APPLICATION FORM  
File One Copy

AUG 17 1972  
08-17-1972  
CONSERVATION DIVISION  
Wichita, Kansas

15-163-20454-00-00

Lease Owner JOHN O. FARMER, INC.  
Address P.O. Box 352, Russell, Kansas 67665  
Lease (Farm Name) BROBST #2 Well No. \_\_\_\_\_  
Well Location C SE SW Sec. 8 Twp. 6S Rge. 19W (E) (W) \_\_\_\_\_  
County ROOKS Total Depth \_\_\_\_\_ Field Name \_\_\_\_\_  
Oil Well \_\_\_\_\_ Gas Well \_\_\_\_\_ Input Well \_\_\_\_\_ SWD Well \_\_\_\_\_ Rotary D & A X  
Well Log filed with application as required Yes  
Date and hour plugging is desired to begin 8-13-72

PLUGGING OF THIS WELL WILL BE DONE IN ACCORDANCE WITH K.S.A. 55-128 OF THE RULES AND REGULATIONS OF THE STATE CORPORATION COMMISSION.

Name of company representative authorized to be in charge of plugging operations:

Dale Buchheister Address Plainville, Kansas

Plugging Contractor John O. Farmer, Inc. License No. \_\_\_\_\_

Address Russell, Kansas

Invoice covering assessment for plugging this well should be sent to:

Name John O. Farmer, Inc.

Address P.O. Box 352, Russell, Kansas 67665

and payment will be guaranteed by applicant or acting agent.

Signed: John O. Farmer  
Applicant or Acting Agent

Date: August 16, 1972

OPERATOR JOHN O. FARMER, INC.

FORMATION RECORD

ADDRESS Box 352, Russell, Ks. 67665

Give detailed description and thickness of all formation drilled through, contents of sand, whether dry, water, oil or gas.

FARM NAME BROBST WELL NO. 2 COUNTY ROOKS SEC. 8 TWP. 6S RGE. 19W

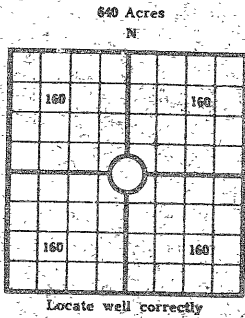

COUNTY Rooks SEC. 8 TWP. 6S RGE. 19W  
 COMPANY OPERATING John O. Farmer, Inc.  
 OFFICE ADDRESS Box 352, Russell, Ks.  
 DRILLING STARTED 8-7, 1972 DRILLING FINISHED 8-13, 1972  
 DATE OF FIRST PRODUCTION \_\_\_\_\_ COMPLETED \_\_\_\_\_  
 WELL LOCATED \_\_\_\_\_ North of South Line and C SE SW ft. East of West Line of Quarter Section  
 Elevation (Relative to sea level) DERRICK FLOOR 2170 GROUND 2167  
 CHARACTER OF WELL (Oil, gas or dryhole) Dryhole

OIL OR GAS SANDS OR ZONES

Name	From	To	Name	From	To
1			4		
2			5		
3			6		

Perforating Record If Any

Shot Record

Formation	From	To	No. of Shots	Formation	From	To	Size of Shot

CASING RECORD

Amount Set							Amount Pulled		Packer Record		
Size	Wt.	Thds.	Make	Ft.	In.	Ft.	In.	Size	Length	Depth Set	Make

Liner Record: Amount \_\_\_\_\_ Kind \_\_\_\_\_ Top \_\_\_\_\_ Bottom \_\_\_\_\_

CEMENTING AND MUDDING

Size	Amount Set		Sacks Cement	Chemical		Method of Cementing	Amount	Mudding Method	Results (See Note)
	Ft.	In.		Gal.	Make				
8-5/8	203		140						

Note: What method was used to protect sands if outer strings were pulled?

NOTE: Were bottom hole plugs used? \_\_\_\_\_ If so, state kind, depth set and results obtained \_\_\_\_\_

TOOLS USED

Rotary Tools were used from 0 feet to 3695 feet to \_\_\_\_\_  
 feet, and from \_\_\_\_\_ feet to \_\_\_\_\_ feet, and from \_\_\_\_\_ feet to \_\_\_\_\_ feet to \_\_\_\_\_  
 Type Rig Rotary

INITIAL PRODUCTION TEST

Describe initial test: whether by flow through tubing or casing or by pumping \_\_\_\_\_  
 Amount of Oil Production \_\_\_\_\_ bbls. Size of choke, if any \_\_\_\_\_ Length of test \_\_\_\_\_ Water  
 Production \_\_\_\_\_ bbls. Gravity of oil \_\_\_\_\_ Type of Pump if pump is used, describe \_\_\_\_\_

Formation	Top	Bottom	Formation	Top	Bottom
Anhydrite	1738				
Heebner	3354				
Lansing	3393				
LOG TOPS					
Topeka	3155				
Heebner	3358				
Toronto	3381				
Lansing	3396				
B/Kansas City	3608				
Reagan Sand	3664				
Granite Wash	3678				
Log T.D.	3699				
Rotary T.D.	3695				
SAMPLE TOPS					
Shale	0	835			
Shale & Sand	835	1250			
Sand	1250	1430			
Red Bed	1430	1707			
Anhydrite	1707	1843			
Shale & Shells	1843	2065			
Shale & Lime	2065	2740			
Lime & Shale	2740	3225			
Lime	3225	3695			
R.T.D.	3695				

RECEIVED  
 STATE CORPORATION COMMISSION  
 AUG 17 1972  
 CONSERVATION DIVISION  
 WICHITA, KANSAS

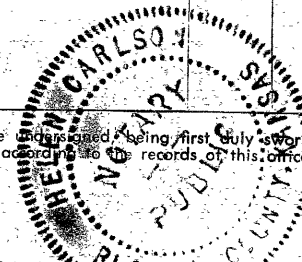

I, the undersigned, being first duly sworn upon oath, state that this well record is true, correct and complete according to the records of this office and to the best of my knowledge and belief.

John O. Farmer  
 Name and title of representative of company

Subscribed and sworn to before me this 16th day of August, 1972

My Commission expires 2-15-75

Helen Carlson  
 Notary Public.

15-163-20454-000

State of Kansas



State Corporation Commission

CONSERVATION DIVISION

(Oil, Gas and Water)

P. O. Box 17027 3830 S. Meridian  
WICHITA, KANSAS 67217

August 21, 1972

15-163-20454-00-00

WELL PLUGGING AUTHORITY

Well No.	2
Lease	Brobst
Description	C SE SW Sec. 8-6S-19W
County	Rooks
Total Depth	3695'
Plugging Contractor	Co. Tools

John O. Farmer, Inc.  
370 West Wichita Avenue  
Russell, Kansas 67665

Gentlemen:

This is your authority to plug the above subject well in accordance with the Rules and Regulations of the State Corporation Commission.

This authority is void after 90 days from the above date.

Yours very truly,

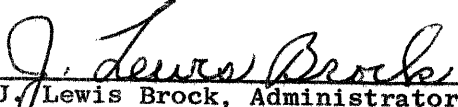
  
J. Lewis Brock, Administrator

Mr. Leo Massey, P. O. Box 582, Hays, Kansas 67601  
is hereby assigned to supervise the plugging of the above  
named well.