

EFFECTIVE DATE: 4-7-92  
DISTRICT # 2  
SGA7... Yes  No

State of Kansas  
NOTICE OF INTENTION TO DRILL

FORM MUST BE TYPED  
FORM MUST BE SIGNED  
ALL BLANKS MUST BE FILLED

*"DWWO"*

Must be approved by the K.C.C. five (5) days prior to commencing well

Expected Spud Date April 6 1992  
month day year

Spot 60'N East  
SE - SE - NW Sec 33 Twp 6 S. Rg 21 West

OPERATOR: License # 6176  
Name: Ivan Holt Well Servicing Inc.  
Address: P.O. Box 671  
City/State/Zip: Russell, Kansas 67665  
Contact Person: LeRoy Holt  
Phone: 913-483-2612

..... 2310 feet from ~~South~~ North line of Section  
..... 2310 feet from ~~East~~ West line of Section  
IS SECTION  REGULAR  IRREGULAR?

(NOTE: Locate well on the Section Plat on Reverse Side)  
County: Graham

CONTRACTOR: License #: 6176  
Name: Ivan Holt Well Servicing Inc.

Lease Name: Johnson B Well #: 1  
Field Name: N/A

Well Drilled For: Well Class: Type Equipment:  
 Oil ... Enh Rec ... Infield ... Mud Rotary ✓  
... Gas ... Storage  Pool Ext. ... Air Rotary ✓  
 OWWO ... Disposal ... Wildcat  Cable  
... Seismic; ... # of Holes ... Other

Is this a Prorated/Spaced Field? ... yes  no

Target Formation(s): Lansing, Kansas City

Nearest lease or unit boundary: 2310'

Ground Surface Elevation: 2238' feet MSL

Water well within one-quarter mile: ... yes  no

Public water supply well within one mile: ... yes  no

Depth to bottom of fresh water: 160'

Depth to bottom of usable water: 1160'

Surface Pipe by Alternate: ... 1  2

Length of Surface Pipe Planned to be set: 258'

Length of Conductor pipe required: N/A

Projected Total Depth: 3600'

Formation at Total Depth: Lansing - Kansas City

Water Source for Drilling Operations:

... well  farm pond ... other

DWR Permit #: N/A

Will Cores Be Taken? ... yes  no

If yes, proposed zone: .....

If OWWO: old well information as follows:  
Operator: K & E Drilling Inc.  
Well Name: Johnson B-1  
Comp. Date: Oct 1986 Old Total Depth 3831'

Directional, Deviated or Horizontal wellbore? ... yes  no

If yes, true vertical depth: .....

Bottom Hole Location: .....

AFFIDAVIT

The undersigned hereby affirms that the drilling, completion and eventual plugging of this well will comply with K.S.A. 55-101, et. seq.

It is agreed that the following minimum requirements will be met:

1. Notify the appropriate district office prior to spudding of well;
2. A copy of the approved notice of intent to drill shall be posted on each drilling rig;
3. The minimum amount of surface pipe as specified below shall be set by circulating cement to the top; in all cases surface pipe shall be set through all unconsolidated materials plus a minimum of 20 feet into the underlying formation;
4. If the well is dry hole, an agreement between the operator and the district office on plug length and placement is necessary prior to plugging;
5. The appropriate district office will be notified before well is either plugged or production casing is cemented in;
6. IF AN ALTERNATE II COMPLETION, PRODUCTION PIPE SHALL BE CEMENTED FROM BELOW ANY USABLE WATER TO SURFACE WITHIN 120 DAYS OF SPUD DATE. IN ALL CASES, NOTIFY DISTRICT OFFICE PRIOR TO ANY CEMENTING.

I hereby certify that the statements made herein are true and to the best of my knowledge and belief.

Date: 3-31-92 Signature of Operator or Agent: [Signature] Title: Sec. Agent

FOR KCC USE:  
 API # 15- 065-22323-00-01  
 Conductor pipe required 1000 feet  
 Minimum surface pipe required 200 feet per Alt. # 2  
 Approved by: [Signature] 4-7-92  
 This authorization expires: 10-2-92  
 (This authorization void if drilling not started within 6 months of effective date.)  
 Spud date: \_\_\_\_\_ Agent: \_\_\_\_\_

REMEMBER TO:

- File Drill Pit Application (form CDP-1) with Intent to Drill;
- File Completion Form ACO-1 within 120 days of spud date;
- File acreage attribution plat according to field proration orders;
- Notify appropriate district office 48 hours prior to workover or re-entry;
- Submit plugging report (CP-4) after plugging is completed;
- Obtain written approval before disposing or injecting salt water.

Mail to: Conservation Division, 200 Colorado Derby Building, 202 W. First St., Wichita, Kansas 67202-1286.

RECEIVED  
STATE CORPORATION COMMISSION  
APR 01 1992  
CONSERVATION DIVISION  
Wichita, Kansas

33  
6  
21W

IN ALL CASES PLOT THE INTENDED WELL ON THE PLAT BELOW

PLAT OF ACREAGE ATTRIBUTABLE TO A WELL IN A PRORATED OR SPACED FIELD

If the intended well is in a prorated or spaced field, please fully complete this side of the form. If the intended well is in a prorated or spaced field complete the plat below showing that the well will be properly located in relationship to other wells producing from the common source of supply. Please show all the wells within 1 mile of the boundaries of the proposed acreage attribution unit for gas wells and within 1/2 mile of the boundaries of the proposed acreage attribution unit for oil wells.

API NO. 15- N/A  
 OPERATOR Ivan Holt Well Servicing Inc.  
 LEASE Johnson B  
 WELL NUMBER 1  
 FIELD \_\_\_\_\_

LOCATION OF WELL: COUNTY Graham  
2310 feet from south/north line of section  
2310 feet from east/west line of section  
 SECTION 33 TWP 6 RG 21w

NUMBER OF ACRES ATTRIBUTABLE TO WELL 10  
 QTR/QTR/QTR OF ACREAGE \_\_\_\_\_

IS SECTION x REGULAR or \_\_\_\_\_ IRREGULAR  
IF SECTION IS IRREGULAR, LOCATE WELL FROM NEAREST CORNER BOUNDARY.

Section corner used: \_\_\_\_\_ NE \_\_\_\_\_ NW \_\_\_\_\_ SE \_\_\_\_\_ SW

**PLAT**

(Show location of the well and shade attributable acreage for prorated or spaced wells.)  
 (Show footage to the nearest lease or unit boundary line.)

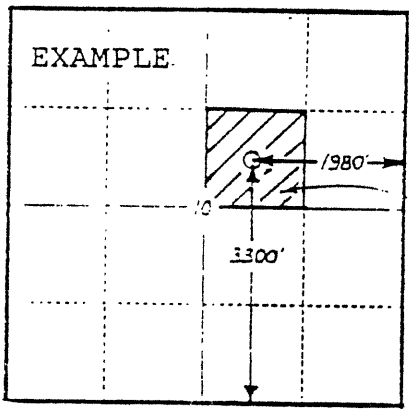
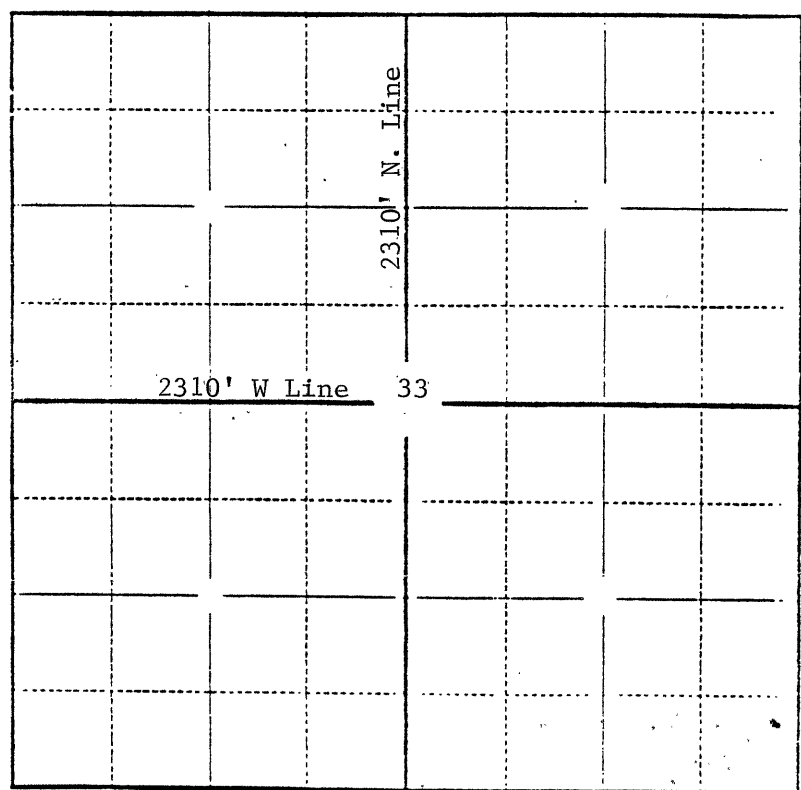

40  
ACRES

In plotting the proposed location of the well, you must show:

- 1) The manner in which you are using the depicted plat by identifying section lines, i.e. 1<sup>st</sup> section, 1<sup>st</sup> section with 8 surrounding sections, 4 sections, etc.;
- 2) the distance of the proposed drilling location from the section's south/north and east/west lines; and
- 3) the distance to the nearest lease or unit boundary line.