

Must be filed with the K.C.C. five (5) days prior to commencing well
 This card void if drilling not started within six (6) months of date received by K.C.C.

Important procedures to follow:

1. Notify District office before setting surface casing.
2. Set surface casing by circulating cement to the top.
3. File completion forms ACO-1 with K.C.C. within 120 days of well spud date, following instructions on ACO-1, side 1, and including copies of wireline logs.
4. Notify District office 48 hours prior to old well workover or re-entry.
5. Prior to filing Intent, prepare a proposed plugging plan in case well is D & A, then obtain approval of plan when calling district office prior to setting surface pipe.
6. Submit plugging report (CP-4) to K. C. C. after plugging is completed.
7. Obtain an approved injection docket number before disposing of salt water.
8. Notify K.C.C. within 10 days when injection commences or terminates.
9. If an alternate 2 completion, cement in the production pipe from below any usable water to surface within 120 days of spud date.

**A Regular Section of Land
 1 Mile = 5,280 Ft.**

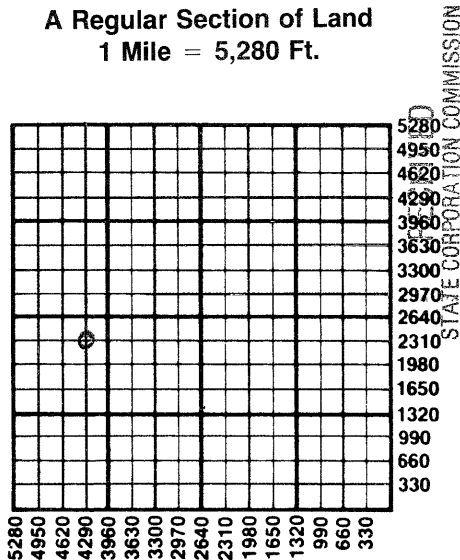

SEP 8 1987
 9-8-87
 CONSERVATION DIVISION
 Wichita, Kansas

State Corporation Commission of Kansas
 Conservation Division
 200 Colorado Derby Building
 Wichita, Kansas 67202-1212
 (316) 263-3238