

15-065-22287-00-00

CO-7
(Revised)

PLAT AND CERTIFICATION OF ACREAGE ATTRIBUTABLE TO AN OIL WELL

State Corporation Commission, Conservation Division
200 Colorado Derby Bldg. Wichita, Kansas 67202

OPERATOR PANCANADIAN PETROLEUM COMPANY

LOCATION OF WELL:

LEASE Pennington

660 feet from the East line

660 feet from the South line

WELL NUMBER 42-17 No. 2

Of the NE/4 of Sec 17 T.6S R.22W

FIELD Penn

COUNTY Graham

*NUMBER OF ACRES
ATTRIBUTABLE TO WELL 40

DESCRIPTION OF ACREAGE:
C SE NE Sec. 17, T6S, R22W

P L A T

(Show location of Well and outline attributable acreage)
(Show footage to nearest lease or unit boundary line)

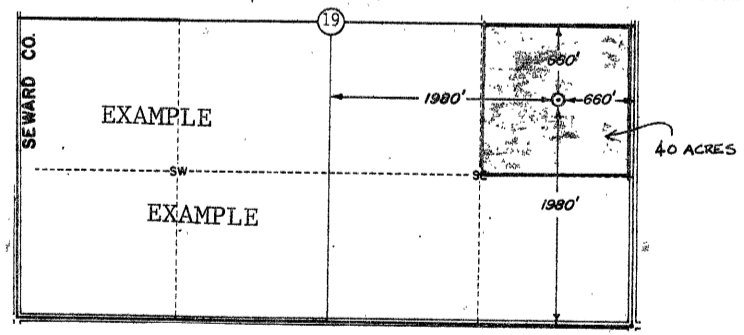
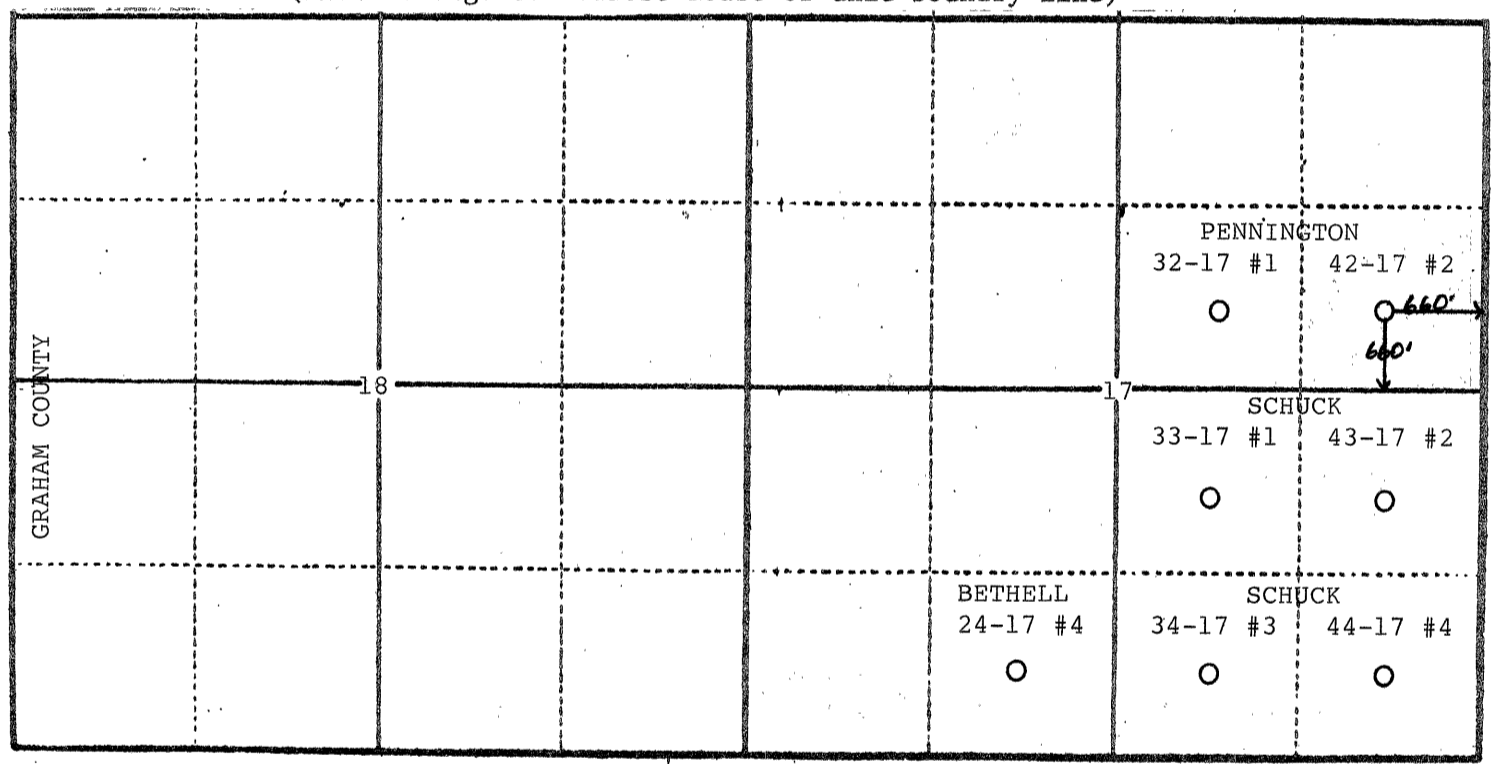

The undersigned hereby certifies that he is Coord., Eng. Operations U.S. for PANCANADIAN PETROLEUM COMPANY, a duly authorized agent, that all information shown hereon is true and correct to the best of his knowledge and belief, and that all acreage claimed as attributable to the well named herein is held by production from that well.

James D. Keisling
James D. Keisling

Suscribed and sworn to before me on this 3rd day of February, 1986.

Janet S. Rittenhouse
Notary Public

My Commission expires 10/14/88

RECEIVED
STATE CORPORATION COMMISSION

FEB 28 1986
04-28-86
CONSERVATION DIVISION