

EFFECTIVE DATE: 6-14-2000

DISTRICT # 4

SGA? ... Yes No

State of Kansas

PERMIT EXTENSION

NOTICE OF INTENTION TO DRILL

Must be approved by the K.C.C. five (5) days prior to commencing well

Expected Spud Date June 15th 2000
month day year

OPERATOR: License # 4767
Name: Ritchie Exploration, Inc.
Address: P.O. Box 783188
City/State/Zip: Wichita, KS 67278-3188
Contact Person: Rocky Milford
Phone: 316/691-9500

CONTRACTOR: License #: ADVISE ON ACO-1
Name: ADVISE ON ACO-1

Well Drilled For: Well Class: Type Equipment:
 Oil ... Enh Rec ... Infield Mud Rotary
... Gas ... Storage ... Pool Ext. ... Air Rotary
... OWMO ... Disposal Wildcat ... Cable
... Seismic; ... # of Holes ... Other

If OWMO: old well information as follows:
Operator: _____
Well Name: _____
Comp. Date: _____ Old Total Depth _____

Directional, Deviated or Horizontal wellbore? ... yes no
If yes, true vertical depth: _____
Bottom Hole Location: _____

Spot 30' N of
SE NW SW Sec 26 Twp 6 S, Rg 22 East
West

1680 feet from South North line of Section
990 feet from East / West line of Section

IS SECTION REGULAR _____ IRREGULAR?

(NOTE: Locate well on the Section Plat on Reverse Side)

County: Graham

Lease Name: McCauley Well #: 1

Field Name: _____

Is this a Prorated/Spaced Field? ... yes no

Target Formation(s): Toronto, LKC

Nearest lease or unit boundary: 960'

Ground Surface Elevation: est. 2310 feet MSL

Water well within one-quarter mile: ... yes no

Public water supply well within one mile: ... yes no

Depth to bottom of fresh water: 150'

Depth to bottom of usable water: 1,120'

Surface Pipe by Alternate: ... 1 2

Length of Surface Pipe Planned to be set: 200'

Length of Conductor pipe required: _____

Projected Total Depth: 3950'

Formation at Total Depth: Arbuckle

Water Source for Drilling Operations: _____

... well ... farm pond ... other

DWR Permit #: _____

Will Cores Be Taken? ... yes no

If yes, proposed zone: _____

AFFIDAVIT

The undersigned hereby affirms that the drilling, completion and eventual plugging of this well will comply with K.S.A. 55-101, et. seq.

It is agreed that the following minimum requirements will be met:

1. Notify the appropriate district office prior to spudding of well;
2. A copy of the approved notice of intent to drill shall be posted on each drilling rig;
3. The minimum amount of surface pipe as specified below shall be set by circulating cement to the top; in all cases surface pipe shall be set through all unconsolidated materials plus a minimum of 20 feet into the underlying formation;
4. If the well is dry hole, an agreement between the operator and the district office on plug length and placement is necessary prior to plugging;
5. The appropriate district office will be notified before well is either plugged or production casing is cemented in;
6. IF AN ALTERNATE II COMPLETION, PRODUCTION PIPE SHALL BE CEMENTED FROM BELOW ANY USABLE WATER TO SURFACE WITHIN 120 DAYS OF SPUD DATE. IN ALL CASES, NOTIFY DISTRICT OFFICE PRIOR TO ANY CEMENTING.

I hereby certify that the statements made herein are true and to the best of my knowledge and belief.

Date: June 2, 2000 Signature of Operator or Agent: [Signature] Title: President

FOR KCC USE:
 API # 15- 065-227980000
 Conductor pipe required NONE feet
 Minimum surface pipe required 200 feet per Alt. X(2)
 Approved by: JK 6-9-2000 EXT 11-21-2000 JK
 This authorization expires: 12-9-2000 EXP
 (This authorization void if drilling not started within 6 months of effective date.)
 Spud date: _____ Agent: _____

RECEIVED
STATE CORPORATION COMMISSION

6-9-2001 JUN 8 2000

CONSERVATION DIVISION
Wichita, Kansas

REMEMBER TO:

- File Drill Pit Application (form CDP-1) with Intent to Drill;
- File Completion Form ACO-1 within 120 days of spud date;
- File acreage attribution plat according to field proration orders;
- Notify appropriate district office 48 hours prior to workover or re-entry;
- Submit plugging report (CP-4) after plugging is completed;
- Obtain written approval before disposing or injecting salt water.

Mail to: Conservation Division, 200 Colorado Derby Building, 202 W. First St., Wichita, Kansas 67202-1286.

26
6
2210

IN ALL CASES PLOT THE INTENDED WELL ON THE PLAT BELOW

PLAT OF ACREAGE ATTRIBUTABLE TO A WELL IN A PRORATED OR SPACED FIELD

If the intended well is in a prorated or spaced field, please fully complete this side of the form. If the intended well is in a prorated or spaced field complete the plat below showing that the well will be properly located in relationship to other wells producing from the common source of supply. Please show all the wells within 1 mile of the boundaries of the proposed acreage attribution unit for gas wells and within 1/2 mile of the boundaries of the proposed acreage attribution unit for oil wells.

API NO. 15- _____
OPERATOR _____
LEASE _____
WELL NUMBER _____
FIELD _____

LOCATION OF WELL: COUNTY _____
_____ feet from south/north line of section
_____ feet from east/west line of section
SECTION _____ TWP _____ RG _____

NUMBER OF ACRES ATTRIBUTABLE TO WELL _____
QTR/QTR/QTR OF ACREAGE _____ - _____ - _____

IS SECTION _____ REGULAR or _____ IRREGULAR
IF SECTION IS IRREGULAR, LOCATE WELL FROM NEAREST CORNER BOUNDARY.

Section corner used: _____ NE _____ NW _____ SE _____ SW
PLAT

(Show location of the well and shade attributable acreage for prorated or spaced wells.)
(Show footage to the nearest lease or unit boundary line.)

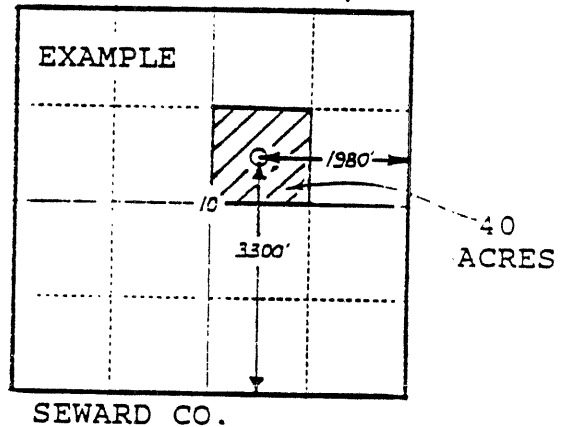
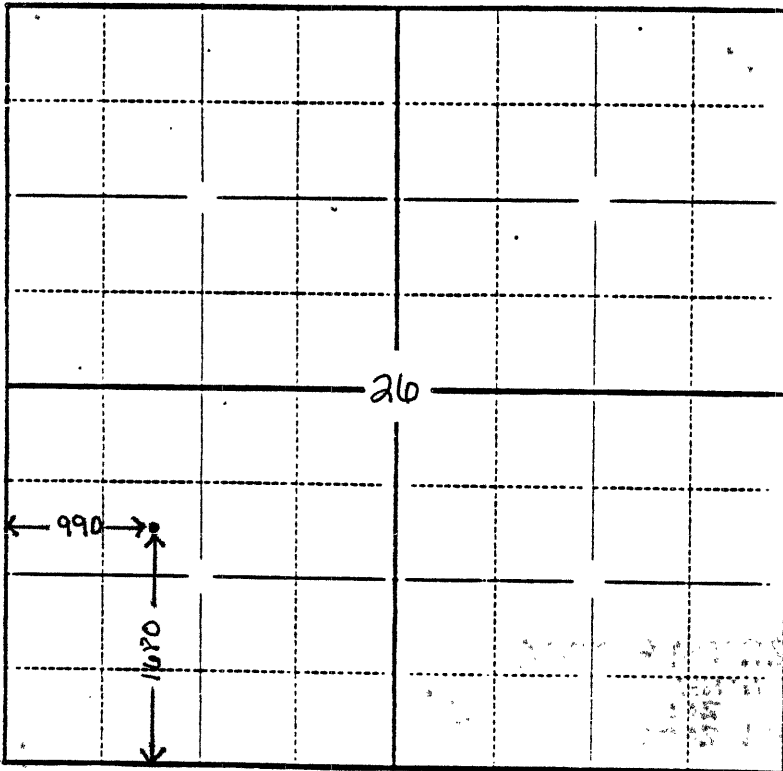

In plotting the proposed location of the well, you must show:

- 1) The manner in which you are using the depicted plat by identifying section lines, i.e. 1 section, 1 section with 8 surrounding sections, 4 sections, etc.;
- 2) the distance of the proposed drilling location from the section's south/north and east/west lines; and
- 3) the distance to the nearest lease or unit boundary line.



November 17, 2000

Kansas Corporation Commission
Mr. Jeff Klock, Environmental Geologist
Oil & Gas Conservation Division
Finney State Office Bldg.
130 S. Market, Room 2078
Wichita, KS 67202-3802

Dear Mr. Klock:

Ritchie Exploration, Inc. would like to request an extension of time on the Intent to Drill for our #1 McCauley well. This well is to be located approximately 30' north of the Southeast Quarter of the Northwest Quarter of the Southwest Quarter (30' N of SE NW SW) in Section 26, Township 6 South, Range 22 West, Graham County, Kansas. The approved intent for this well will expire on December 9, 2000 and gives this well API#15-065-227498,0000.

Thank you for your help with this and please let me know if any additional information is required in order to approve this extension.

Sincerely,

Andrea Perez
Geology Assistant

/ap

RECEIVED
STATE CORPORATION COMMISSION

NOV 20 2000

CONSERVATION DIVISION
Wichita, Kansas

P.O. Box 783188
Wichita, Kansas 67278-3188

(316) 691-9500
Fax (316) 691-9550
ritchieexp@feist.com

8100 E. 22nd St. N., Bldg. 700
Wichita, Kansas 67226-2328