

CARD MUST BE TYPED

State of Kansas
NOTICE OF INTENTION TO DRILL
HUGOTON INFILL

CARD MUST BE SIGNED

EFFECTIVE DATE 4-6-05

SGA-No

Starting Date MAY 01 2005
month day year

API Number 15- 093-21766.06.00
IS SECTION REGULAR IRREGULAR

OPERATOR: License # 5952
Name BP AMERICA PRODUCTION COMPANY
Address P. O. BOX 3092, WL1, RM 3.201
City/State/Zip HOUSTON, TX 77253-3092
Contact Person SUE SELLERS
Phone (281)366-2052

NE NE SW SW Sec 31 Twp 23 S, Rg 37 W
1250 S Ft. from South Line of Section
1250 W Ft. from East Line of Section

CONTRACTOR License # 5382
Name CHEYENNE DRILLING
City/State

Note: Attach acreage attribution plat locating both Chase (Hugoton) wells
Total number of acres attributed to unit 640

Well Drilled as: New Recompletion OWWO
Projected Total Depth 2850 feet
Formation

Nearest producing well from
same common source of supply 1737 feet
Nearest lease or unit boundary line 1250 feet

If OWWO or Recompletion: old well info as follows:
Operator
Well Name
Comp. Date Old Total Depth

County KEARNY
Lease Name HOENER Well # 3HI
Ground surface elevation 3311 feet MSL
Depth to bottom of fresh water 330
Depth to bottom of usable water 800
Surface pipe by Alternate: 1 2
Surface pipe planned to be set 350'
Water Source for Drilled Operations:
DWR Permit #: well farm pond other

I certify that well will comply with K.S.A. 55-101, et seq., plus eventually plugging hole to KCC specifications
Date MARCH 30, 2005 Signature of Operator or Agent [Signature] Title

REGULATORY STAFF
ASSISTANT

For KCC Use:
Conductor Pipe Required NONE feet; Minimum Surface Pipe Required 350 feet per Alt. 4 2
This Authorization Expires 10-2-05 Approved By RJP 4.1.05

9/95

Must be filed with K.C.C. five (5) days prior to commencing well
This card void if drilling not started within six (6) months of date received by K.C.C.

RECEIVED
KANSAS CORPORATION COMMISSION
APR 01 2005

CONSERVATION DIVISION
WICHITA, KS

A Regular Section of Land
1 Mile = 5,280 Ft.

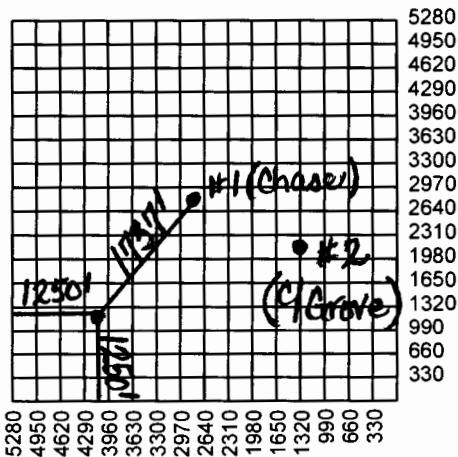

Important procedures to follow:

1. Notify District office before setting surface casing.
2. Set surface casing by circulating cement to the top.
3. File completion forms ACO-1 with K.C.C. within 120 days of well spud date, following instructions on ACO-1, side 1, and including copies of wireline logs.
4. Notify District office 48 hours prior to old well workover or re-entry.
5. Submit plugging report (CP-4) to K.C.C. after plugging is completed.
6. If an alternate 2 completion, cement in the production pipe from below any useable water to surface within 120 day of spud date.

State Corporation Commission of Kansas
Conservation Division
130 S. Market Room 2078
Wichita, Kansas 67202-1212
(316) 337-6231