

For KCC Use: 4.19.05  
Effective Date: \_\_\_\_\_  
District #: 1  
SGA?  Yes  No

KANSAS CORPORATION COMMISSION  
OIL & GAS CONSERVATION DIVISION

Form C-1  
September 1999  
Form must be Typed  
Form must be Signed  
All blanks must be Filled

**NOTICE OF INTENT TO DRILL**

Must be approved by KCC five (5) days prior to commencing well

Expected Spud Date May 1 2005  
month day year

Spot 150' W of  
S2 - NW - NW Sec 24 Twp. 17 S. R. 19  East  West  
990 feet from S  (circle one) Line of Section  
510 feet from E  (circle one) Line of Section  
Is SECTION  Regular  Irregular?

OPERATOR: License# 5003  
Name: McCoy Petroleum Corporation  
Address: 8080 E. Central, Suite #300  
City/State/Zip: Wichita, Kansas 67206  
Contact Person: Scott Hampel  
Phone: 316-636-2737

RECEIVED  
APR 14 2005

CONTRACTOR: License# 5142  
Name: Sterling Drilling Company

KCC WICHITA

Well Drilled For:  Oil  Gas  OWWO  Seismic; # of Holes  Other  
 Enh Rec  Storage  Disposal  
Well Class:  Infield  Pool Ext.  Wildcat  Other  
Type Equipment:  Mud Rotary  Air Rotary  Cable

(Note: Locate well on the Section Plat on reverse side)  
County: Rush  
Lease Name: Pechanec Trust A Well #: 1-24  
Field Name: Wildcat Schwinds

Is this a Prorated / Spaced Field?  Yes  No  
Target Information(s): Arbuckle  
Nearest Lease or unit boundary: 510'  
Ground Surface Elevation: 2144' feet MSL

Water well within Dne-quarter mile:  Yes  No  
Public water supply well within one mile:  Yes  No  
Depth to bottom of fresh water: 180'  
Depth to bottom of usable water: 700' Permian  
Surface Pipe by Alternate: 1  2  
Length of Surface Pipe Planned to be set: 200'+/-  
Length of Conductor Pipe required: None  
Projected Total Depth: 3900'  
Producing Formation Target: Arbuckle

If OWWO: old well information as follows:  
Operator: \_\_\_\_\_  
Well Name: \_\_\_\_\_  
Original Completion Date: \_\_\_\_\_ Original Total Depth: \_\_\_\_\_

Directional, Deviated or Horizontal wellbore?  Yes  No  
If Yes, true vertical depth: \_\_\_\_\_  
Bottom Hole Location: \_\_\_\_\_  
KCC DKT #: \_\_\_\_\_

Water Source for Drilling Operations:  Well  Farm Pond  Other  
DWR Permit #: \_\_\_\_\_  
(Note: Apply for Permit with DWR )  
Will Cores be taken?  Yes  No  
If Yes, proposed zone: \_\_\_\_\_

**AFFIDAVIT**

The undersigned hereby affirms that the drilling, completion and eventual plugging of this well will comply with K.S.A. 55-101, et. seq.  
It is agreed that the following minimum requirements will be met:

1. Notify the appropriate district office **prior** to spudding of well;
2. A copy of the approved notice of intent to drill **shall be** posted on each drilling rig;
3. The minimum amount of surface pipe as specified below **shall be set** by circulating cement to the top; in all cases surface pipe **shall be set** through all unconsolidated materials plus a minimum of 20 feet into the underlying formation.
4. If the well is dry hole, an agreement between the operator and the district office on plug length and placement is necessary **prior to plugging**;
5. The appropriate district office will be notified before well is either plugged or production casing is cemented in;
6. If an ALTERNATE 11 COMPLETION, production pipe shall be cemented from below any usable water to surface within **120 days** of spud date. **In all cases, NOTIFY district office** prior to any cementing.

I hereby certify that the statements made herein are true and to the best of my knowledge and belief.

Date: April 12, 2005 Signature of Operator or Agent: Scott Hampel Title: Engineering/Production Mgr.

For KCC Use ONLY  
API # 15 - 165-21778-00-00  
Conductor pipe required NONE feet  
Minimum surface pipe required 200 feet per Alt.   
Approved by: RSP 4.14.05  
This authorization expires: 10.14.05  
(This authorization void if drilling not started within 6 months of effective date.)  
Spud date: \_\_\_\_\_ Agent: \_\_\_\_\_

- Remember to -
- File Drill Pit Application (form CDP-1) with Intent to Drill;
  - File Completion Form ACO-1 within 120 days of spud date;
  - File acreage attribution plat according to field proration orders;
  - Notify appropriate district office 48 hours prior to workover or re-entry;
  - Submit plugging report (CP-4) after plugging is completed;
  - Obtain written approval before disposing or injecting salt water.

Mail to: KCC - Conservation Division, 130 S. Market - Room 2078, Wichita, Kansas 67202

24 17 19w

**IN ALL CASES PLOT THE INTENDED WELL ON THE PLAT BELOW**

*Plat of acreage attributable to a well in a prorated or spaced field*

*If the intended well is in a prorated or spaced field, please fully complete this side of the form.* If the intended well is in a prorated or spaced field complete the plat below showing that the well will be properly located in relationship to other wells producing from the common source of supply. Please show all the wells and within 1 mile of the boundaries of the proposed acreage attribution unit for gas wells and within 1/2 mile of the boundaries of the proposed acreage attribution unit for oil wells.

API No. 15 - \_\_\_\_\_  
 Operator: McCoy Petroleum Corporation  
 Lease: Pechanec Trust A  
 Well Number: 1-24  
 Field: Arbuckle  
 Number of Acres attributable to well: \_\_\_\_\_  
 QTR / QTR / QTR of acreage: S2 - NW - NW

Location of Well: County: Rush  
 \_\_\_\_\_  
 990 feet from S N (circle one) Line of Section  
 \_\_\_\_\_  
 510 feet from E W (circle one) Line of Section  
 Sec 24 Twp 17 S. R 19  East  West

Is Section X Regular or \_\_\_\_\_ Irregular

**If Section is Irregular, locate well from nearest corner boundary.**  
 Section corner used: \_\_\_ NE \_\_\_ NW - SE \_\_\_ SW

**PLAT**

*(Show location of the well and shade attributable acreage for prorated or spaced wells)  
 (Show footage to the nearest lease or unit boundary fine.)*

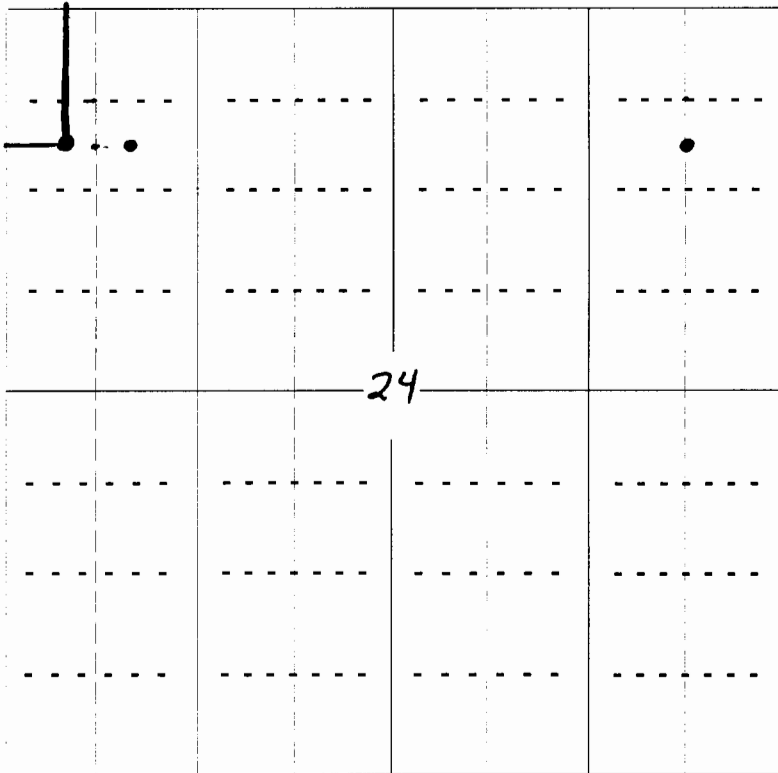

RECEIVED  
 APR 14 2005  
 KCC WICHITA

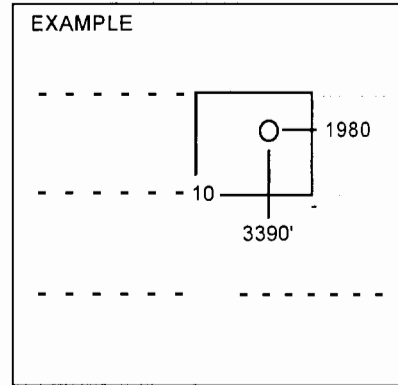

SEWARDCO.

**NOTE., In all cases locate the spot of the proposed drilling location.**

**In plotting the proposed location of the well, you must show.**

1. The manner in which you are using the depicted plat by identifying section lines, i.e. 1 section, 1 section with 8 surrounding sections, 4 sections, etc.
2. The distance of the proposed drilling location from the section's south / north and east / west.
3. The distance to the nearest lease or unit boundary line.
4. If proposed location is located within a prorated or spaced field a certificate of acreage attribution plat must be attached: (CO-7 for oil wells; CG-8 for gas wells).