

For KCC Use: 4.25.05  
 Effective Date: \_\_\_\_\_  
 District # \_\_\_\_\_  
 SGA?  Yes  No

KANSAS CORPORATION COMMISSION  
 OIL & GAS CONSERVATION DIVISION

Form C-1  
 December 2002  
**Form must be Typed**  
**Form must be Signed**  
**All blanks must be Filled**

**NOTICE OF INTENT TO DRILL**  
*Must be approved by KCC five (5) days prior to commencing well*

Expected Spud Date May 8 2005  
month day year

Spot  East  
S/2 S/2 SW Sec. 16 Twp. 29 S. R. 18  West  
330 feet from  N /  S Line of Section  
1320 feet from  E /  W Line of Section  
 Is SECTION  Regular  Irregular?

OPERATOR: License# 5004  
 Name: Vincent Oil Corporation  
 Address: 125 N. Market, Suite 1075  
 City/State/Zip: Wichita, Kansas 67202  
 Contact Person: Rick Hiebsch  
 Phone: 316-262-3573

(Note: Locate well on the Section Plat on reverse side)

County: Kiowa  
 Lease Name: Peters Well #: 1-16  
 Field Name: Nichols

CONTRACTOR: License# 4958  
 Name: Mallard JV, Inc.

Is this a Prorated / Spaced Field?  Yes  No

<b>Well Drilled For:</b>	<b>Well Class:</b>	<b>Type Equipment:</b>
<input checked="" type="checkbox"/> Oil	<input type="checkbox"/> Enh Rec	<input checked="" type="checkbox"/> Infield
<input checked="" type="checkbox"/> Gas	<input type="checkbox"/> Storage	<input checked="" type="checkbox"/> Mud Rotary
<input type="checkbox"/> OWWO	<input type="checkbox"/> Disposal	<input type="checkbox"/> Air Rotary
<input type="checkbox"/> Seismic; # of Holes _____	<input type="checkbox"/> Other _____	<input type="checkbox"/> Cable
<input type="checkbox"/> Other _____		

Target Formation(s): Mississippian  
 Nearest Lease or unit boundary: 330 ft.

If OWWO: old well information as follows:  
 Operator: \_\_\_\_\_  
 Well Name: \_\_\_\_\_  
 Original Completion Date: \_\_\_\_\_ Original Total Depth: \_\_\_\_\_

Ground Surface Elevation: 2235 feet MSL

Water well within one-quarter mile:  Yes  No

Public water supply well within one mile:  Yes  No

Depth to bottom of fresh water: 200

Depth to bottom of usable water: 325 300

Surface Pipe by Alternate:  1  2

Length of Surface Pipe Planned to be set: 400 ft.

Length of Conductor Pipe required: none

Projected Total Depth: 4950 ft.

Formation at Total Depth: Mississippian

Directional, Deviated or Horizontal wellbore?  Yes  No

Water Source for Drilling Operations:  
 Well  Farm Pond Other unknown

If Yes, true vertical depth: \_\_\_\_\_

DWR Permit #: \_\_\_\_\_

Bottom Hole Location: \_\_\_\_\_

(Note: Apply for Permit with DWR )

KCC DKT #: \_\_\_\_\_

Will Cores be taken?  Yes  No

If Yes, proposed zone: \_\_\_\_\_

**AFFIDAVIT**

The undersigned hereby affirms that the drilling, completion and eventual plugging of this well will comply with K.S.A. 55 et. seq.

It is agreed that the following minimum requirements will be met:

1. Notify the appropriate district office **prior** to spudding of well;
2. A copy of the approved notice of intent to drill **shall be** posted on each drilling rig;
3. The minimum amount of surface pipe as specified below **shall be set** by circulating cement to the top; in all cases surface pipe shall be cemented through all unconsolidated materials plus a minimum of 20 feet into the underlying formation.
4. If the well is dry hole, an agreement between the operator and the district office on plug length and placement is necessary **prior to plugging**;
5. The appropriate district office will be notified before well is either plugged or production casing is cemented in;
6. If an ALTERNATE II COMPLETION, production pipe shall be cemented from below any usable water to surface within **120 days** of spud date. Or pursuant to Appendix "B" - Eastern Kansas surface casing order #133,891-C, which applies to the KCC District 3 area, alternate II cementing must be completed within 30 days of the spud date or the well shall be plugged. **In all cases, NOTIFY district office** prior to any cementing.

I hereby certify that the statements made herein are true and to the best of my knowledge and belief.

Date: 4-18-05 Signature of Operator or Agent: Richard H. Hiebsch Title: President

RECEIVED  
 APR 19 2005  
 KCC WICHITA

**For KCC Use ONLY**  
 API # 15 - 097. 21566.00-00  
 Conductor pipe required NONE feet  
 Minimum surface pipe required 320 feet per Alt. 1  
 Approved by: RJP4-20.05  
 This authorization expires: 10-20-05  
 (This authorization void if drilling not started within 6 months of effective date.)  
 Spud date: \_\_\_\_\_ Agent: \_\_\_\_\_

**Remember to:**

- File Drill Pit Application (form CDP-1) with Intent to Drill;
- File Completion Form ACO-1 within 120 days of spud date;
- File acreage attribution plat according to field proration orders;
- Notify appropriate district office 48 hours prior to workover or re-entry;
- Submit plugging report (CP-4) after plugging is completed;
- Obtain written approval before disposing or injecting salt water.
- If this permit has expired (See: **authorized expiration date**) please check the box below and return to the address below.

**Well Not Drilled - Permit Expired**  
 Signature of Operator or Agent: \_\_\_\_\_  
 Date: \_\_\_\_\_

16  
 29  
 18W

Mall to: KCC - Conservation Division, 130 S. Market - Room 2078, Wichita, Kansas 67202

**IN ALL CASES PLOT THE INTENDED WELL ON THE PLAT BELOW**

*Plat of acreage attributable to a well in a prorated or spaced field*

**If the intended well is in a prorated or spaced field, please fully complete this side of the form.** If the intended well is in a prorated or spaced field complete the plat below showing that the well will be properly located in relationship to other wells producing from the common source of supply. Please show all the wells and within 1 mile of the boundaries of the proposed acreage attribution unit for gas wells and within 1/2 mile of the boundaries of the proposed acreage attribution unit for oil wells.

API No. 15 - \_\_\_\_\_  
 Operator: Vincent Oil Corporation  
 Lease: Peters  
 Well Number: 1-16  
 Field: Nichols  
 Number of Acres attributable to well: \_\_\_\_\_  
 QTR / QTR / QTR of acreage: S/2 - S/2 - SW

Location of Well: County: Kiowa  
 \_\_\_\_\_ 330 \_\_\_\_\_ feet from  N /  S Line of Section  
 \_\_\_\_\_ 1320 \_\_\_\_\_ feet from  E /  W Line of Section  
 Sec. 16 Twp. 29 S. R. 18  East  West

Is Section:  Regular or  Irregular

**If Section is irregular, locate well from nearest corner boundary.**  
 Section corner used:  NE  NW  SE  SW

**PLAT**

*(Show location of the well and shade attributable acreage for prorated or spaced wells.)  
 (Show footage to the nearest lease or unit boundary line.)*

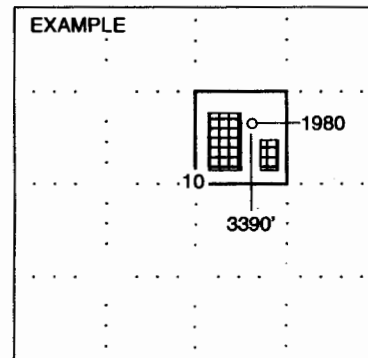
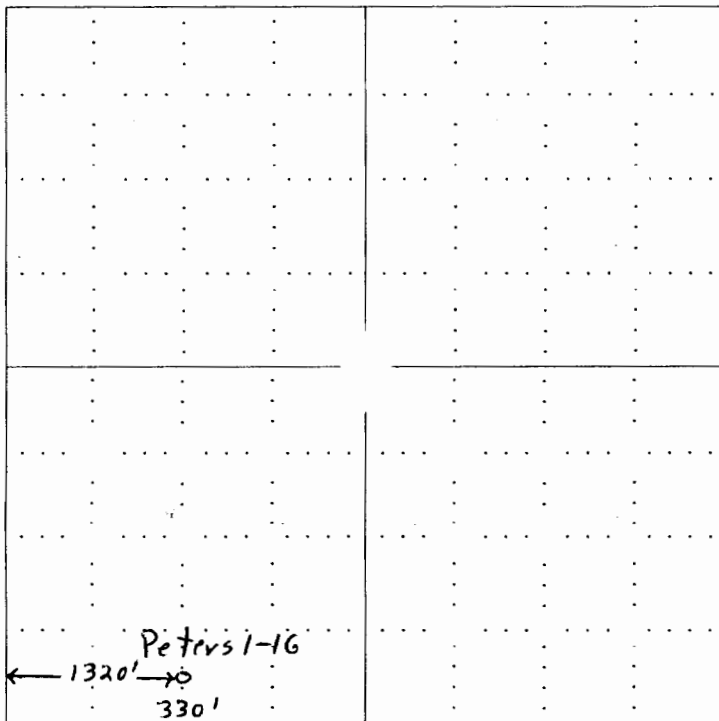

SEWARD CO.

**NOTE: In all cases locate the spot of the proposed drilling location.**

**In plotting the proposed location of the well, you must show:**

1. The manner in which you are using the depicted plat by identifying section lines, i.e. 1 section, 1 section with 8 surrounding sections, 4 sections, etc.
2. The distance of the proposed drilling location from the section's south / north and east / west.
3. The distance to the nearest lease or unit boundary line.
4. If proposed location is located within a prorated or spaced field a certificate of acreage attribution plat must be attached: (CO-7 for oil wells; CG-8 for gas wells).