

For KCC Use:

Effective Date:

District #

SGA? ☐ Yes ☒ NoKANSAS CORPORATION COMMISSION
OIL & GAS CONSERVATION DIVISION

NOTICE OF INTENT TO DRILL

Must be approved by KCC five (5) days prior to commencing well

Form C-1

September 1999

Form must be Typed

Form must be Signed

All blanks must be Filled

Expected Spud Date: 4-3-05
month day yearOPERATOR: License# 5137
Name: Donald & Jack Ensminger
Address: 1446-3000 St.
City/State/Zip: Moran, Kansas 66755
Contact Person: Donald Ensminger
Phone: (620) 496-2300 or 496-7181CONTRACTOR: License# 6137
Name: Donald & Jack Ensminger

Well Drilled For:	Well Class:	Type Equipment:
<input checked="" type="checkbox"/> Oil	<input type="checkbox"/> Enh Rec	<input checked="" type="checkbox"/> Infield
<input type="checkbox"/> Gas	<input type="checkbox"/> Storage	<input checked="" type="checkbox"/> Mud Rotary
<input type="checkbox"/> OWWO	<input type="checkbox"/> Disposal	<input type="checkbox"/> Pool Ext.
<input type="checkbox"/> Seismic; # of Holes	<input type="checkbox"/> Wildcat	<input type="checkbox"/> Air Rotary
<input type="checkbox"/> Other	<input type="checkbox"/> Other	<input type="checkbox"/> Cable

If OWWO: old well information as follows:

Operator: _____

Well Name: _____

Original Completion Date: _____ Original Total Depth: _____

Directional, Deviated or Horizontal wellbore? ☐ Yes ☒ No

If Yes, true vertical depth: _____

Bottom Hole Location: _____

KCC DKT #: _____

Spot: NE NE SW Sec. 14 Twp. 25 S. R. 19 ☒ East ☐ West
2420 feet from S N (circle one) Line of Section
2860 feet from E W (circle one) Line of Section
Is SECTION ☒ Regular ☐ Irregular?

(Note: Locate well on the Section Plat on reverse side)

County: AllenLease Name: Scott Well #: 21Field Name: MoranIs this a Prorated / Spaced Field? ☐ Yes ☒ NoTarget Formation(s): BartlesvilleNearest Lease or unit boundary: 220'Ground Surface Elevation: NA feet MSLWater well within one-quarter mile: ☐ Yes ☒ NoPublic water supply well within one mile: ☐ Yes ☒ NoDepth to bottom of fresh water: 100'Depth to bottom of usable water: 150'Surface Pipe by Alternate: 1 ☒ 2Length of Surface Pipe Planned to be set: 20'Length of Conductor Pipe required: NoneProjected Total Depth: 900'Formation at Total Depth: Bartlesville

Water Source for Drilling Operations:

Well ☐ Farm Pond ☒ Other ☐

DWR Permit #: _____

(Note: Apply for Permit with DWR ☐)Will Cores be taken? ☐ Yes ☒ No

If Yes, proposed zone: _____

AFFIDAVIT

The undersigned hereby affirms that the drilling, completion and eventual plugging of this well will comply with K.S.A. 55-101, et. seq.

It is agreed that the following minimum requirements will be met:

1. Notify the appropriate district office *prior* to spudding of well;
2. A copy of the approved notice of intent to drill *shall be* posted on each drilling rig;
3. The minimum amount of surface pipe as specified below *shall be set* by circulating cement to the top; in all cases surface pipe *shall be set* through all unconsolidated materials plus a minimum of 20 feet into the underlying formation.
4. If the well is dry hole, an agreement between the operator and the district office on plug length and placement is necessary *prior to plugging*;
5. The appropriate district office will be notified before well is either plugged or production casing is cemented in;
6. If an ALTERNATE II COMPLETION, production pipe shall be cemented from below any usable water to surface within **120 days** of spud date. *In all cases, NOTIFY district office prior to any cementing.*

I hereby certify that the statements made herein are true and to the best of my knowledge and belief.

Date: 3-28-05 Signature of Operator or Agent: Donald Ensminger Title: Owner

For KCC Use ONLY

API # 15 - 001-29215-00-00Conductor pipe required NONE feetMinimum surface pipe required 20 feet per Alt. 1 2Approved by: RJP3-30-05This authorization expires: 9-30-05

(This authorization void if drilling not started within 6 months of effective date.)

Spud date: _____ Agent: _____

Remember to:

- File Drill Pit Application (form CDP-1) with Intent to Drill;
- File Completion Form ACO-1 within 120 days of spud date;
- File acreage attribution plat according to field proration orders;
- Notify appropriate district office 48 hours prior to workover or re-entry;
- Submit plugging report (CP-4) after plugging is completed;
- Obtain written approval before disposing or injecting salt water.

Mail to: KCC - Conservation Division, 130 S. Market - Room 2078, Wichita, Kansas 67202

RECEIVED

MAR 30 2005

KCC WICHITA

IN ALL CASES PLOT THE INTENDED WELL ON THE PLAT BELOW

Plat of acreage attributable to a well in a prorated or spaced field

If the intended well is in a prorated or spaced field, please fully complete this side of the form. If the intended well is in a prorated or spaced field complete the plat below showing that the well will be properly located in relationship to other wells producing from the common source of supply. Please show all the wells and within 1 mile of the boundaries of the proposed acreage attribution unit for gas wells and within 1/2 mile of the boundaries of the proposed acreage attribution unit for oil wells.

API No. 15 - _____

Operator: _____

Lease: _____

Well Number: _____

Field: _____

Number of Acres attributable to well: _____

QTR / QTR / QTR of acreage: _____

Location of Well: County: Allen_____ 2420 = _____ feet from S / N (circle one) Line of Section_____ 2860 _____ feet from E / W (circle one) Line of SectionSec. 14 Twp. 25 S. R. 19 ☒ East ☐ WestIs Section XX Regular or _____ Irregular

If Section is Irregular, locate well from nearest corner boundary.

Section corner used: _____ NE _____ NW SE _____ SW

PLAT

(Show location of the well and shade attributable acreage for prorated or spaced wells.)

(Show footage to the nearest lease or unit boundary line.)

14-25-19

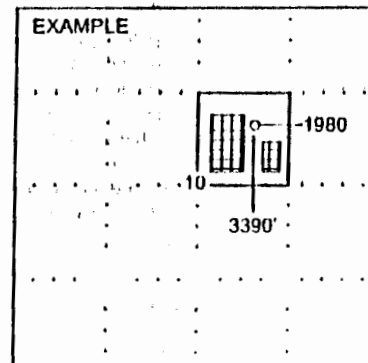
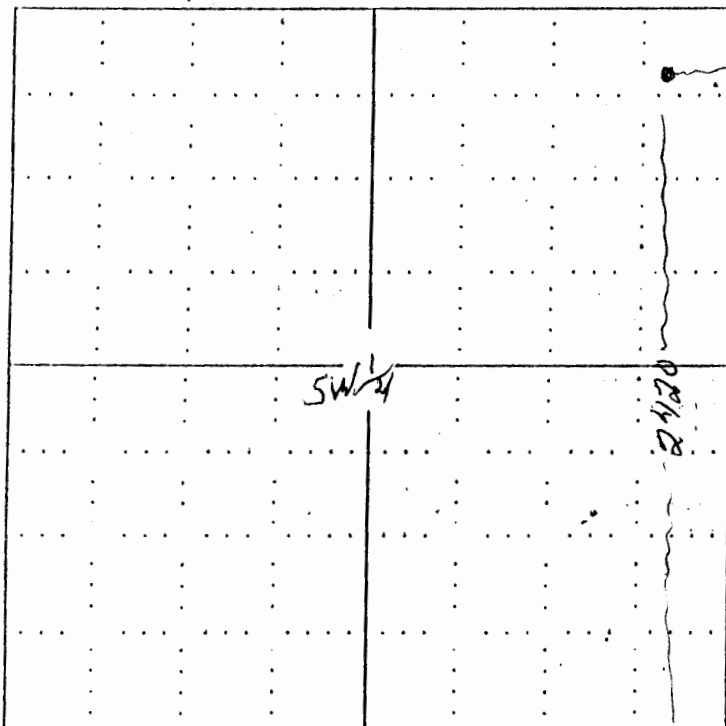

NOTE: In all cases locate the spot of the proposed drilling location.

In plotting the proposed location of the well, you must show:

1. The manner in which you are using the depicted plat by identifying section lines, i.e. 1 section, 1 section with 8 surrounding sections, 4 sections, etc.
2. The distance of the proposed drilling location from the section's south / north and east / west.
3. The distance to the nearest lease or unit boundary line.
4. If proposed location is located within a prorated or spaced field a certificate of acreage attribution plat must be attached: (CO-7 for oil wells; CG-8 for gas wells).