

STATE OF KANSAS  
STATE CORPORATION COMMISSION  
CONSERVATION DIVISION  
500 INSURANCE BUILDING  
212 NORTH MARKET  
WICHITA, KANSAS 67202

FORM CP-1

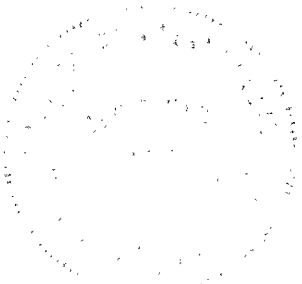

WELL PLUGGING APPLICATION FORM  
File One Copy

RECEIVED  
STATE CORPORATION COMMISSION  
FEB 9 1970  
CONSERVATION DIVISION  
Wichita, Kansas

2-9-70

15-065-20303-0000

Lease Owner John O. Farmer, Inc.

Address P.O. Box 352, Russell, Kansas 67665

Lease (Farm Name) Rogers Well No. 1

Well Location SW, NW, Sec. 30 Twp. 6s Rge. 22w (E) (W)

County Graham Field Name (If Any)

Total Depth 3855' Oil Well Gas Well Input Well SWD Well D & A X

Well Log filed with application Yes or Well Log filed with Plugging Supervisor

Date and hour plugging is desired to begin Completed: 1:30 P.M. 2/2/70

Plugging of the well will be done in accordance with the Rules and Regulations of the State Corporation Commission.

Name of company representative in charge of plugging operations Dale Buchheister

209 North Washington Address Plainville, Kansas 67665

Plugging Contractor John O. Farmer, Inc. License No.

Address P.O. Box 352, Russell, Kansas 67665

Invoice covering assessment for plugging this well should be sent to John O. Farmer, Inc.

P.O. Box 352 Address Russell, Kansas 67665

and payment will be guaranteed by applicant.

Signed: John O. Farmer

Applicant or Acting Agent  
President

Date: February 6, 1970

FARM NAME ROGERS WELL NO. 1 COUNTY Graham SEC. 30 TWP. 6S RGE. 22W

OPERATOR John O. Farmer, Inc.  
 ADDRESS P.O. Box 352, Russell, Ks.

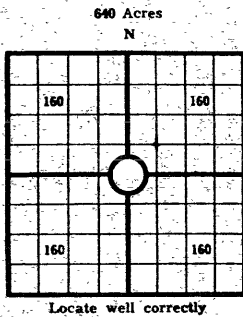

COUNTY Graham, SEC. 30, TWP. 6s, RGE. 22W  
 COMPANY OPERATING John O. Farmer, Inc.  
 OFFICE ADDRESS Box 352, Russell, Ks.  
 DRILLING STARTED 1/26 1970, DRILLING FINISHED 2/21 1970  
 DATE OF FIRST PRODUCTION \_\_\_\_\_ COMPLETED \_\_\_\_\_  
 WELL LOCATED SW 1/4 NW 1/4, North of South  
 Line and \_\_\_\_\_ ft. East of West Line of Quarter Section  
 Elevation (Relative to sea level) DERRICK FLOOR 2394 GROUND, 2391  
 CHARACTER OF WELL (Oil, gas or dryhole) Dryhole

OIL OR GAS SANDS OR ZONES

Name	From	To	Name	From	To
1			4		
2			5		
3			6		

Perforating Record If Any

Shot Record

Formation	From	To	No. of Shots	Formation	From	To	Size of Shot

CASING RECORD

Amount Set								Amount Pulled		Packer Record	
Size	Wt.	Thds.	Make	Ft.	In.	Ft.	In.	Size	Length	Depth Set	Make

Liner Record: Amount \_\_\_\_\_ Kind \_\_\_\_\_ Top \_\_\_\_\_ Bottom \_\_\_\_\_

CEMENTING AND MUDDING

Size	Amount Set		Sacks Cement	Chemical		Method of Cementing	Amount	Mudding Method	Results (See Note)
	Ft.	In.		Gal.	Make				
8 5/8"	232		150	sx.	cement				

Note: What method was used to protect sands if outer strings were pulled? \_\_\_\_\_

NOTE: Were bottom hole plugs used? \_\_\_\_\_ If so, state kind, depth set and results obtained \_\_\_\_\_

TOOLS USED

Rotary Tools were used from 0 feet to R.T.D. Cable tools were used from \_\_\_\_\_ feet to \_\_\_\_\_ feet, and from \_\_\_\_\_ feet to \_\_\_\_\_ feet, and from \_\_\_\_\_ feet to \_\_\_\_\_ feet  
 Type Rig Rotary

INITIAL PRODUCTION TEST

Describe initial test: whether by flow through tubing or casing or by pumping \_\_\_\_\_

Amount of Oil Production \_\_\_\_\_ bbls. Size of choke, if any \_\_\_\_\_ Length of test \_\_\_\_\_ Water

Production \_\_\_\_\_ bbls. Gravity of oil \_\_\_\_\_ Type of Pump if pump is used, describe \_\_\_\_\_

FORMATION RECORD

Give detailed description and thickness of all formation drilled through, contents of sand, whether dry, water, oil or gas.

Formation	Top	Bottom	Formation	Top	Bottom
Surface		232			
Shale	232	620			
Shale sand	620	1520			
Shale	1520	1610			
Sand	1610	1825			
Redbed	1825	2055			
Anhydrite	2055	2088			
Shale shells	2088	2615			
Shale lime	2615	2750			
Lime shale	2750	3150			
Shale lime	3150	3615			
Lime	3615	3830			
Shale lime	3830	3855			
			Sample Tops		Tops
			Heebner		3602'
			Toronto		3627'
			Lansing		3644'
			Base Kansas City		3842'
			Rotary T.D.		3855'

15-065-20303-00-00

RECEIVED  
 STATE CORPORATION COMMISSION  
 FEB 9 1970  
 WICHITA, KANSAS  
 CONSERVATION DIVISION

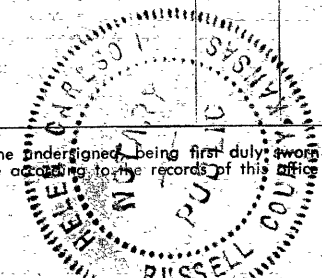

I, the undersigned, being first duly sworn upon oath, state that this well record is true, correct and complete according to the records of this office and to the best of my knowledge and belief.

John O. Farmer  
 Name and title of representative of company  
President

Subscribed and sworn to before me this 6th day of February, 1970

My Commission expires 2/15/71

Helen Carlson  
 Notary Public.



State Corporation Commission

CONSERVATION DIVISION

(Oil, Gas and Water)

500 Insurance Bldg.

212 N. Market

WICHITA, KANSAS 67202

February 6, 1970

WELL PLUGGING AUTHORITY

Well No.	C-1
Lease	Rogers
Description	SW NW 30-6-22W
County	Graham
Total Depth	3855
Plugging Contractor	Co. Tools

John O. Farmer, Inc.  
370 W. Wichita Ave.  
Russell, Kansas 67665

Gentlemen:

This is your authority to plug the above subject well in accordance with the Rules and Regulations of the State Corporation Commission.

This authority is void after 90 days from the above date.

Very truly yours,

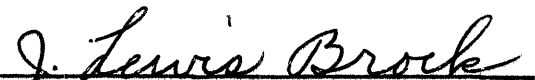
  
J. Lewis Brock, Administrator

Mr. W. L. Nichols Box 157 Morland, Kansas  
is hereby assigned to supervise the plugging of the above  
named well.