

STATE OF KANSAS  
STATE CORPORATION COMMISSION  
CONSERVATION DIVISION  
211 NORTH BROADWAY  
WICHITA, KANSAS

15-065-00939-00-00

WELL PLUGGING APPLICATION FORM  
File One Copy

Lease Owner Jones, Shelburne & Farmer, Inc. Address Russell, Kansas  
(Applicant)

Lease (Farm Name) BOWER Well No. 1

Well Location SE SE SW Sec. 10 Twp. 6 Rge. (E) (W) 23

County Graham Field Name (if any) Wildcat

Total Depth 4060 Oil \_\_\_\_\_ Gas \_\_\_\_\_ Dry Hole X

Was well log filed with application? yes If not, explain: \_\_\_\_\_

Date and hour plugging is desired to begin 10/23/57 5:00 AM

Plugging of the well will be done in accordance with the Rules and Regulations of the State Corporation Commission.

Name of the person on the lease in charge of well for owner \_\_\_\_\_

Dale Buchheister Address Plainville, Kansas

Plugging Contractor Jones, Shelburne & Farmer, Inc.

Plugging Contractor's License No. \_\_\_\_\_

Address Russell, Kansas

Invoice covering assessment for plugging this well should be sent to \_\_\_\_\_

Jones, Shelburne & Farmer, Inc. Address Russell, Kansas

and payment will be guaranteed by applicant.

RECEIVED  
STATE CORPORATION COMMISSION  
11-2-57  
NOV 2 1957  
CONSERVATION DIVISION  
Wichita, Kansas

John O. Farmer  
Applicant or Acting Agent

Date October 31, 1957

PLUGGING  
FILE SEC 10 T 6 R 23w  
BOOK PAGE 57 LINE 14

OPERATOR Jones, Shelburne & Farmer, Inc.ADDRESS Russell, Kansas

## FORMATION RECORD

Give detailed description and thickness of all formations drilled through; contents of sand, whether dry, water, oil or gas.

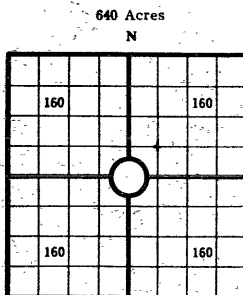

COUNTY Graham SEC. 10 TWP. 6 RGE. 23W  
 COMPANY OPERATING Jones, Shelburne & Farmer, Inc.  
 OFFICE ADDRESS Russell, Kansas  
 FARM NAME BOWER WELL NO. 1  
 DRILLING STARTED 10/12/57 DRILLING FINISHED 10/22/57  
 DATE OF FIRST PRODUCTION \_\_\_\_\_ COMPLETED \_\_\_\_\_  
 WELL LOCATED SE 1/4 SE 1/4 SW 1/4 North of South  
 Line and \_\_\_\_\_ ft. East of West Line of Quarter Section  
 Elevation (Relative to sea level) DERRICK FLOOR 2412 ROUND 2409  
 CHARACTER OF WELL (Oil, gas or dryhole) Dry

## OIL OR GAS SANDS OR ZONES

Name	From	To	Name	From	To
1			4		
2			5		
3			6		

## Perforating Record If Any

## Shot Record

Formation	From	To	No. of Shots	Formation	From	To	Size of Shot

## CASING RECORD

Amount Set				Amount Pulled				Packer Record			
Size	Wt.	Thds.	Make	Ft.	In.	Ft.	In.	Size	Length	Depth Set	Make
8-5/8				258							

Liner Record: Amount \_\_\_\_\_ Kind \_\_\_\_\_ Top \_\_\_\_\_ Bottom \_\_\_\_\_

## CEMENTING AND MUDDING

Size	Amount Set		Sacks Cement	Chemical		Method of Cementing	Amount	Mudding Method	Results (See Note)
	Ft.	In.		Gal.	Make				
8-5/8	258		175						

Note: What method was used to protect sands if outer strings were pulled? \_\_\_\_\_

NOTE: Were bottom hole plugs used? \_\_\_\_\_ If so, state kind, depth set and results obtained \_\_\_\_\_

## TOOLS USED

Rotary Tools were used from \_\_\_\_\_ feet to \_\_\_\_\_ Cable tools were used from \_\_\_\_\_ feet to \_\_\_\_\_  
feet, and from \_\_\_\_\_ feet to \_\_\_\_\_ feet, and from \_\_\_\_\_ feet to \_\_\_\_\_

Type Rig \_\_\_\_\_

## INITIAL PRODUCTION TEST

Describe initial test: whether by flow through tubing or casing or by pumping \_\_\_\_\_

Amount of Oil Production \_\_\_\_\_ bbls. Size of choke, if any \_\_\_\_\_ Length of test \_\_\_\_\_ Water

Production \_\_\_\_\_ bbls. Gravity of oil \_\_\_\_\_ Type of Pump if pump is used, describe \_\_\_\_\_

I, the undersigned, being first duly sworn upon oath, state that this well record is true, correct and complete according to the records of this office and to the best of my knowledge and belief.

Paul Farmer Resident  
 Name and title of representative of company

Subscribed and sworn to before me this 31st day of October, 1957.  
 My Commission expires 10/11/58  
Lewis L. Loney Notary Public.

Formation	Top	Bottom	Formation	Top	Bottom
Clay & sand	0	220			
Shale	220	460			
Shale, sand & shells	460	1760			
Shale & redbed	1760	2080	Elevation:	RB	2414
Anhydrite	2080	2112			
Shale & shells	2112	2525			
Shale & lime	2525	2645	SAMPLE TOPS:		
Shale & lime	2645	3660			
Lime & shale	3660	4060	Anhydrite		2080
T.D.		4060	Topeka		3415
			Heebner		3610
			Lansing		3652
			B/KC		3842
			Sandy Conglomerate		3976
			Arbuckle		4023
			R.T.D.		4060
			D & A		

PLUGGING  
 FILE SEC 10 T 6 R 23 W  
 SOCK PAGE 57 LINE 14

11-2-57  
 NOV 2 1957

COUNTY DIVISION  
 Russell, Kansas

15-065-00939-00-0

FARM NAME \_\_\_\_\_ COUNTY \_\_\_\_\_ TWP. \_\_\_\_\_ RGE. \_\_\_\_\_



15-065-00939-00-00

STATE OF KANSAS  
STATE CORPORATION COMMISSION  
CONSERVATION DIVISION  
211 NORTH BROADWAY  
WICHITA, KANSAS  
October 28, 1957

Well No.	1
Lease	Power
Description	SE SE SW 10-6-23W
County	Graham
File No.	57-24

Jones, Shelburne & Farmer, Inc.  
370 West Wichita Avenue  
Russell, Kansas

Gentlemen:

This letter is your authority to plug the above subject well, in accordance with the Rules and Regulations of the State Corporation Commission. When you are ready to plug this well, please contact our District Plugging Supervisor, Mr. Eldon Potty, Box 326, Hays, Kansas Ph. 8-3218

Very truly yours,

  
Jewel M. Ogden  
Director of Conservation Division

cc:  
District Plugging Supervisor