

15-065-02688-00-00

WELL PLUGGING RECORD

STATE OF KANSAS STATE CORPORATION COMMISSION

Give All Information Completely Make Required Affidavit Mail or Deliver Report to: Conservation Division State Corporation Commission 800 Bitting Building Wichita, Kansas

OR FORMATION PLUGGING RECORD

Strike out upper line when reporting plugging of formations.

Graham County. Sec. 2 Twp. 6 S Rge. (E) 23 (W) Location as "NE 1/4 NW 1/4 SW 1/4" or footage from lines SW 1/4 SW 1/4 SE 1/4 Lease Owner. Skelly Oil Company Lease Name. John E. Mills Well No. 1 Office Address. Box 391, Hutchinson, Kansas Character of Well (completed as Oil, Gas or Dry Hole) Dry Hole Date well completed. March 1 19 43 Application for plugging filed. March 2 19 43 Application for plugging approved. March 3 19 43 Plugging commenced. March 3 19 43 Plugging completed. March 3 19 43 Reason for abandonment of well or producing formation Dry Hole

NORTH

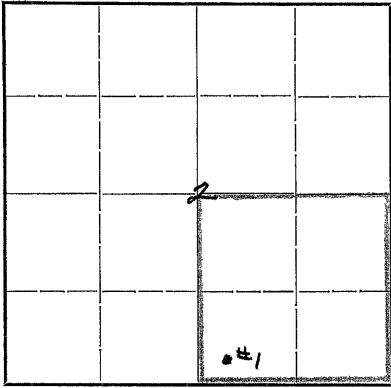

Locate well correctly on above Section Plat

If a producing well is abandoned, date of last production. 19 Was permission obtained from the Conservation Division or its agents before plugging was commenced? Yes

Name of Conservation Agent who supervised plugging of this well. C. T. Alexander Producing formation. Depth to top. Bottom. Total Depth of Well. 3996 Feet Show depth and thickness of all water, oil and gas formations.

OIL, GAS OR WATER RECORDS

CASING RECORD

Table with 7 columns: Formation, Content, From, To, Size, Put In, Pulled Out. Rows include Topeka Lime, Lansing Lime, and Arbuckle Lime.

Describe in detail the manner in which the well was plugged, indicating where the mud fluid was placed and the method or methods used in introducing it into the hole. If cement or other plugs were used, state the character of same and depth placed, from feet to feet for each plug set.

Filled hole with mud laden fluid and cotton seed hulls 3996' to 305' Wood plug set at 305' Filled with 80 sacks cement from 305' to 50' Mud laden fluid 50' to 28' Filled with 10 sacks cement from 28' to 8' Cellar filled with rock and surface soil 8' to Top

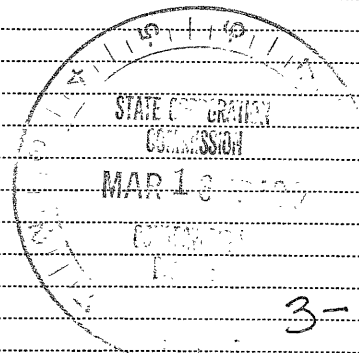

3-16-43

(If additional description is necessary, use BACK of this sheet) Correspondence regarding this well should be addressed to. H. E. Wamsley Address. Box 391, Hutchinson, Kansas

STATE OF Kansas, COUNTY OF Reno, ss. H. E. Wamsley (employee of owner or controller of the above-described well, being first duly sworn on oath, says: That I have knowledge of the facts, statements, and matters herein contained and the log of the above-described well as filed and that the same are true and correct. So help me God.

(Signature) [Signature] Box 391, Hutchinson, Kansas (Address)

SUBSCRIBED AND SWORN to before me this 10th day of March, 19 43

[Signature] Notary Public.

My commission expires June 22, 1945



15-069-02688-00-00

# SKELLY OIL COMPANY

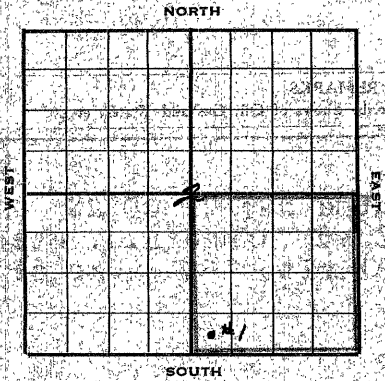

## Well Record

Lease Name and No. John B. Mills #18447 Well No. 1 Elev. 2384'  
 Lease Description Southeast Quarter (SE<sub>1</sub>) Section 2,  
Township 6 South, Range 23 West, Graham Co., Kansas  
 Location made January 12 1943 by Gould Randolph  
 feet from North line \_\_\_\_\_ feet from East line SE/4  
330 feet from South line 330' feet from West line of Sec. 2-6S-23W

Work com'd Jan. 16 1943 Rig comp'd Jan. 28 1943 Drlg. com'd Feb. 6 1943 Drlg. comp'd Mar. 1 1943

Rig Contractor Claude Wentworth Drilling Company  
 Drilling Contractor Claude Wentworth Drilling Company, Tulsa, Oklahoma

Rotary Drilling from Top to 3996' Cable Tool Drilling from \_\_\_\_\_ to \_\_\_\_\_

Commenced Producing Dry Hole 19 \_\_\_\_\_ { Initial Prod. before shot or acid \_\_\_\_\_ Bbls.  
 Initial Prod. after shot or acid \_\_\_\_\_ Bbls.

Dry Gas Well Press \_\_\_\_\_ Volume \_\_\_\_\_ Cu. ft.

Casing Head Gas Pressure \_\_\_\_\_ Volume \_\_\_\_\_ Cu. ft.

Braden Head ( \_\_\_\_\_ Size ) Gas Pressure \_\_\_\_\_ Volume \_\_\_\_\_ Cu. ft.

Braden Head ( \_\_\_\_\_ Size ) Gas Pressure \_\_\_\_\_ Volume \_\_\_\_\_ Cu. ft.

PRODUCING FORMATION Dry Hole (Name) Top \_\_\_\_\_ Bottom \_\_\_\_\_ TOTAL DEPTH 3996'

### CASING RECORD

Size	Wt.	Thds.	Where Set	PULLED OUT			LEFT IN			KIND	Cond'n	CEMENTING	
				Jts.	Feet	In.	Jts.	Feet	In.			Sacks Used	Method Employed
<u>8-5/8" OD 28#</u>	<u>80</u>	<u>305'</u>					<u>7</u>	<u>299'</u>	<u>9</u>	<u>Lapweld</u>	<u>A</u>	<u>150</u>	<u>Halliburton</u>
<u>(8-5/8" OD casing set 7' in cellar)</u>													

Liner Set at \_\_\_\_\_ Length \_\_\_\_\_ Perforated at \_\_\_\_\_

Liner Set at \_\_\_\_\_ Length \_\_\_\_\_ Perforated at \_\_\_\_\_

Packer Set at \_\_\_\_\_ Size and Kind \_\_\_\_\_

Packer Set at \_\_\_\_\_ Size and Kind \_\_\_\_\_

### SHOT OR ACID TREATMENT RECORD

Date	FIRST		SECOND		THIRD		FOURTH	
	Ft. and	Ft.	Ft. and	Ft.	Ft. and	Ft.	Ft. and	Ft.

### SIGNIFICANT GEOLOGICAL FORMATIONS

NAME	Top	Bottom	GAS		OIL		REMARKS
			From	To	From	To	
<u>Topeka Line</u>	<u>3395'</u>						
<u>Landing Line</u>	<u>3598'</u>						
<u>Arbuckle Line</u>	<u>3966'</u>				<u>3969'</u>	<u>3996'</u>	<u>probably water plugged and abandoned March 5, 1943.</u>

### CLEANING OUT RECORDS

	DATE COMMENCED	DATE COMPLETED	PROD. BEFORE	PROD. AFTER	REMARKS
1st					See Reverse for other detail
2nd					" " " " "
3rd					" " " " "
4th					" " " " "

### PLUGGING BACK AND DEEPENING RECORDS

	Date Commenced	Date Completed	No. Feet Plugged Back or Deepened	Prod. Before	Prod. After	REMARKS
1st						See Reverse for other detail
2nd						" " " " "
3rd						" " " " "
4th						" " " " "

(See Reverse for Record of Formation)

RECORD OF FORMATIONS

FORMATION	TOP	BOTTOM	REMARKS
			Indicate Casing Points, Describe Shows of Oil, Gas and Water, etc.
Surface soil, shale & sand	0	260	
Shale and shells	260	306	Set and cemented 8-5/8" OD 28' Range 2, B Round Thread L.W. Steel Casing at 305' with 150 sacks of cement.
Shale	306	750	
Sand and shale	750	990	
Sand, shale and shells	990	1390	
Anhydrite	1390	1450	
Shale and red bed	1450	1675	
Sand	1675	1750	
Shale	1750	1840	
Shale and shells	1840	2035	
Lime	2035	2070	
Broken lime	2070	2205	
Lime and shale	2205	2350	
Lime	2350	2615	
Shale	2615	2635	
Broken lime	2635	2690	
Lime	2690	2750	
Broken lime	2750	2820	
Lime and shale	2820	2910	
Broken lime	2910	2920	
Shale and shells	2920	2950	
Lime	2950	3005	
Broken lime and shale	3005	3055	
Lime	3055	3085	
Lime and shale	3085	3135	
Broken lime	3135	3330	
Lime	3330	3380	
Broken lime	3380	3404	Top Topoka Line 3395'
Lime	3404	3472	
Sand	3472	3488	
Lime	3488	3640	Top Lansing Line 3598'
Cherty lime	3640	3650	
Lime	3650	3695	
Lime and shale	3695	3725	
Lime	3725	3765	
Broken lime	3765	3794	
Lime and shale	3794	3848	
Lime	3848	3886	
Shale and lime	3886	3935	
Cherty lime and shale	3935	3963	
Red shale, sand and collitic chert	3963	3986	Top Arbuckle Line 3966'
Hard gray, finely crystalline dolomite	3966	3969	No porosity
Medium soft grey, coarsely crystalline dolomite	3969	3981	Probably water
Same	3981	3996	" "
TOTAL DEPTH		3996'	

Since the well did not show oil or gas in commercial quantities from any zones in drilling to the total depth of 3996', regular authority was granted on March 2, 1943, to plug and abandon the location.

On March 5, 1943, the well was plugged as follows:

Pilled hole with mud laden fluid and cotton seed hulls	3996' to 305'
Wood plug set at	305'
Cement (80 sacks)	305' to 50'
Mud laden fluid	50' to 28'
Cement (10 sacks)	28' to 8'
Surface soil and rock	8' to 0'

PLUGGING  
 2 6 28 1/2  
 6 29  
 6 29

