

PLAT AND CERTIFICATION OF ACREAGE ATTRIBUTABLE TO AN OIL WELL

State Corporation Commission, Conservation Division  
 200 Colorado Derby Bldg. Wichita, Kansas 67202

OPERATOR PANCANADIAN PETROLEUM COMPANY

LOCATION OF WELL:

LEASE Schuck

1980 feet from the South line

660 feet from the East line

WELL NUMBER 43-17 #2

Of the SE/4 of Sec 17 T. 6S R. 22W

FIELD Penn

COUNTY Graham

\*NUMBER OF ACRES  
 ATTRIBUTABLE TO WELL 40

DESCRIPTION OF ACREAGE:  
NE/4 SE/4 Section 17

PLAT

(Show location of Well and outline attributable acreage)  
 (Show footage to nearest lease or unit boundry line)

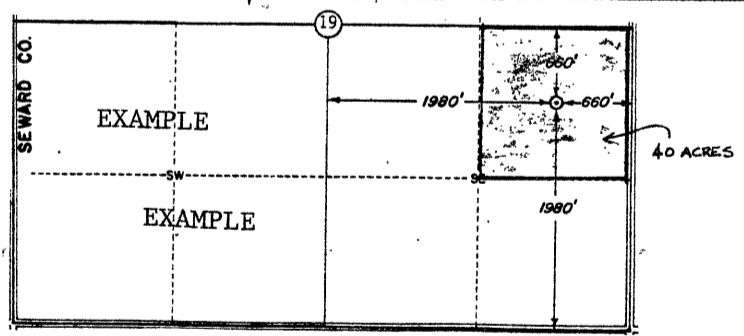
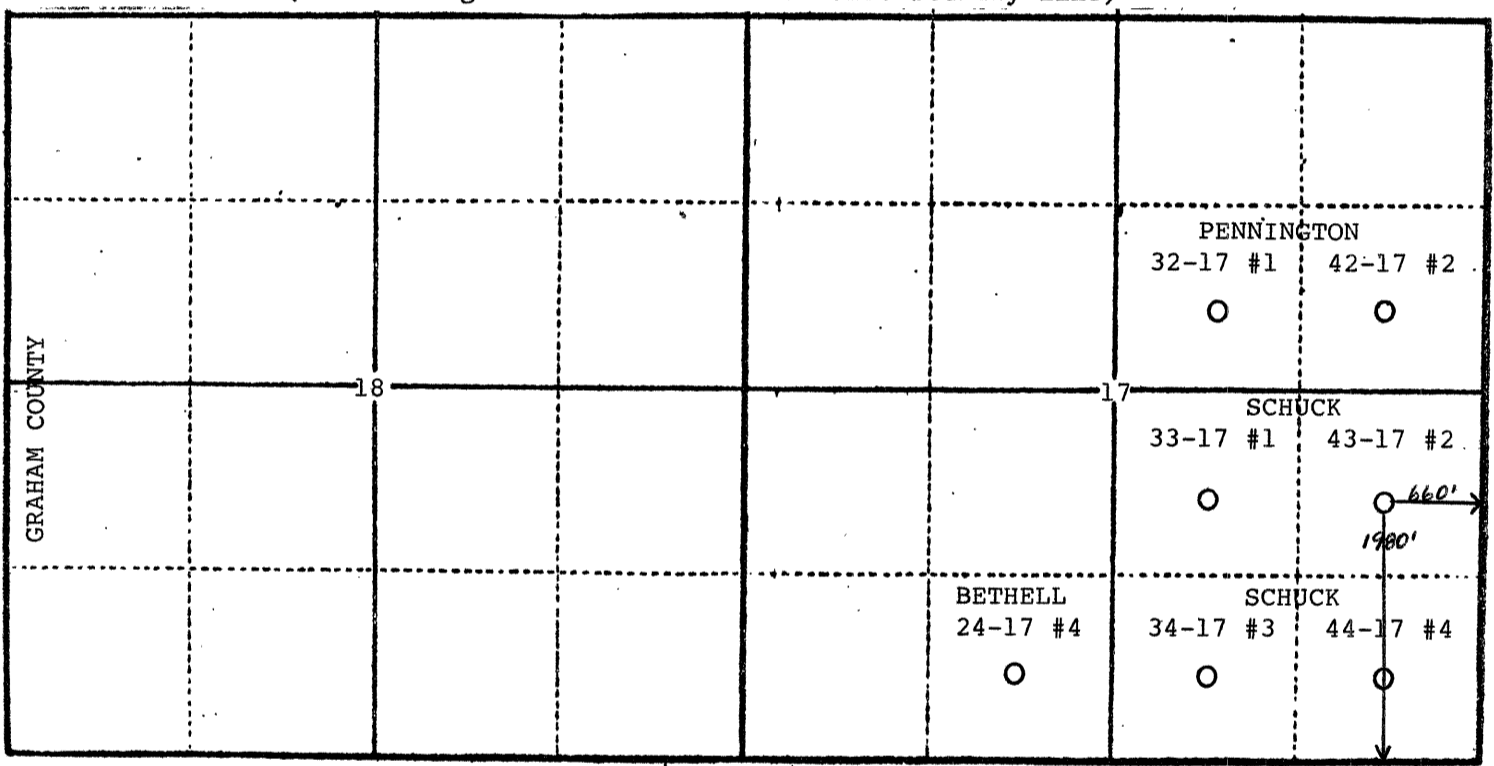

The undersigned hereby certifies that he is Coord., Eng. Operations U.S. for PANCANADIAN PETROLEUM COMPANY, a duly authorized agent, that all information shown hereon is true and correct to the best of his knowledge and belief, and that all acreage claimed as attributable to the well named herein is held by production from that well.

James D. Keisling  
 James D. Keisling

Suscribed and sworn to before me on this 3rd day of February, 1986.

Spert S. Rittenhouse  
 Notary Public  
 RECEIVED STATE CORPORATION COMMISSION

My Commission expires 10/14/88

FEB 23 1986  
 02-28-86  
 CONSERVATION DIVISION  
 Wichita, Kansas