

STATE OF KANSAS
STATE CORPORATION COMMISSION
CONSERVATION DIVISION
500 INSURANCE BUILDING
212 NORTH MARKET
WICHITA 2, KANSAS

RECEIVED
STATE CORPORATION COMMISSION

FEB 14 1964

2-14-64

CONSERVATION DIVISION
Wichita, Kansas

WELL PLUGGING APPLICATION FORM

File One Copy

15-065-19038-00-00

Lease Owner JOHN O. FARMER, INC., IRWIN KORNFELD & WM. GLICKMAN
(Applicant)
Address P.O. Box 352, Russell, Kansas; Denver Colorado; Wichita, Kansas

Lease (Farm Name) Ward Well No. # 1

Well Location NE SW SE Sec. 31 Twp. 6s Rge. 25w (E) (W)

County Graham Field Name (If any)

Total Depth 3902' Oil Well Gas Well Input Well SWD Well D & A

Was well log filed with application? Yes If not, explain:

Date and hour plugging is desired to begin 9:30 P.M. 2/11/64

Plugging of the well will be done in accordance with the Rules and Regulations of the State Corporation Commission.

Name of the person on the lease in charge of well owner Dale Buchheister
209 N Washington Address Plainville, Kansas

Plugging Contractor John O. Farmer, Inc. License No.

Address P.O. Box 352, Russell, Kansas

Invoice covering assessment for plugging this well should be sent to John O. Farmer, Inc.
P.O. Box 352 Address Russell, Kansas

and payment will be guaranteed by applicant.

Signed: John O. Farmer
Applicant or Acting Agent
President

Date: 2/13/64

OPERATOR John O. Farmer, Inc.

FORMATION RECORD

ADDRESS P.O. Box 352, Russell, Kansas

Give detailed description and thickness of all formation drilled through, contents of sand, whether dry, water, oil or gas.

WELL NO. # 1 COUNTY GRAHAM TWP. 6S SEC. 31 RGE. 25W

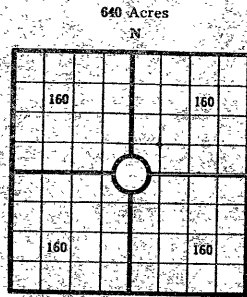

COUNTY Graham SEC. 31 TWP. 6s RGE. 25w
 COMPANY OPERATING John O. Farmer, Inc.
 OFFICE ADDRESS P.O. Box 352, Russell, Kansas
 DRILLING STARTED 2/3, 1964 DRILLING FINISHED 2/11, 1964
 DATE OF FIRST PRODUCTION _____ COMPLETED _____
 WELL LOCATED NE $\frac{1}{4}$ SW $\frac{1}{4}$ SE $\frac{1}{4}$ _____, North of South
 Line and _____ ft. East of West Line of Quarter Section
 Elevation (Relative to sea level) DERRICK FLOOR 2574' GROUND 2571'
 CHARACTER OF WELL (Oil, gas or dryhole) Dry

OIL OR GAS SANDS OR ZONES

Name	From	To	Name	From	To
1			4		
2			5		
3			6		

Perforating Record If Any

Shot Record

Formation	From	To	No. of Shots	Formation	From	To	Size of Shot

CASING RECORD

Amount Set						Amount Pulled				Packer Record	
Size	Wt.	Thds.	Make	Ft.	In.	Ft.	In.	Size	Length	Depth Set	Make

Liner Record: Amount _____ Kind _____ Top _____ Bottom _____

CEMENTING AND MUDDING

Size	Amount Set		Sacks Cement	Chemical		Method of Cementing	Amount	Mudding Method	Results (See Note)
	Ft.	In.		Gal.	Make				
8 5/8	265'		150	sx.					

Note: What method was used to protect sands if outer strings were pulled?

NOTE: Were bottom hole plugs used? _____ If so, state kind, depth set and results obtained _____

TOOLS USED

Rotary Tools were used from 0 feet to R.T.D. Cable tools were used from _____ feet to _____ feet, and from _____ feet to _____ feet, and from _____ feet to _____ feet.

Type Rig Rotary

INITIAL PRODUCTION TEST

Describe initial test: whether by flow through tubing or casing or by pumping _____

Amount of Oil Production _____ bbls. Size of choke, if any _____ Length of test _____ Water

Production _____ bbls. Gravity of oil _____ Type of Pump if pump is used, describe _____

Formation	Top	Bottom	Formation	Top	Bottom
Sub-surface		370			
Shale	370	1375			
Shale & Sand	1375	1745			
Red Bed	1745	2210			
Shale & Shells	2210	2725			
Shale & Lime	2725	3130			
Lime & Shale	3130	3705			
Lime	3705	3902			
T.D.	3902				

SAMPLE TOPS

Heebner	3657	(-1081)
Toronto	3679	(-1103)
Lansing-K. C.	3700	(-1124)
Base Kansas City	3892	(-1316)
R. T. D.	3902	(-1326)

RECEIVED
STATE CORPORATION COMMISSION

FEB 14 1964
2-14-64
CONSERVATION DIVISION
Wichita, Kansas

18-069-19038-00-00

I, the undersigned, being first duly sworn upon oath, state that this well record is true, correct and complete according to the records of this office and to the best of my knowledge and belief.

John O. Farmer
 Name and title of representative of company
 President

Subscribed and sworn to before me this 13th day of February, 1964

My Commission expires 2/15/67

Helen Carlson
 Notary Public.

Helen Carlson

State of Kansas



FORM - CP-8
Rev. 6-26-62

15-065-19038-00-00

State Corporation Commission

CONSERVATION DIVISION

(Oil, Gas and Water)

500 Insurance Bldg. 212 N. Market
WICHITA, KANSAS 67202

JOHN ANDERSON, Jr. Governor
WILLIAM L. MITCHELL Chairman
ALVIN F. GRAUERHOLZ Commissioner
HARRY G. WILES Commissioner
RAYMOND B. HARVEY Secretary
ROBT. C. LONDERHOLM Gen. Counsel

February 11, 1964

WELL PLUGGING AUTHORITY

Well No.
Lease
Description 1
County Ward
NE SW SE 31-6-25W
Graham

John O. Farmer Inc., Irwin Kornfeld & Wm. Glickman
Box 352
Dendale, Kansas

This is your authority to plug the above subject well in accordance with the Rules and Regulations of the State Corporation Commission.

This authority is void after 90 days from the above date.

Very truly yours,

P. Roberts, Administrator

Mr. _____
is hereby assigned to supervise the plugging of the above
named well. W. L. Nichols Morland, Kansas