

STATE OF KANSAS
STATE CORPORATION COMMISSION
CONSERVATION DIVISION
200 Colorado Derby Building
Wichita, Kansas 67202

FORM CP-1
Rev. 6/4/84

15-069-03250-00-00

WELL PLUGGING APPLICATION FORM
(File One Copy)

6/86

API NUMBER October 17, 1955 (of this well)
(This must be listed; if no API# was issued, please note drilling completion date.)

LEASE OPERATOR John O. Farmer, Inc. OPERATORS LICENSE NO. 5135

ADDRESS P.O. Box 352, Russell, KS 67665 PHONE # (913) 483-3144

LEASE (FARM) Tedro WELL NO. #1 WELL LOCATION NE NW NW COUNTY Graham

SEC. 30 TWP. 6S RGE. 25 ~~(E) or (W)~~ TOTAL DEPTH 3880' PLUG BACK TD 3870'

Check One:

OIL WELL GAS WELL _____ D & A _____ SWD or INJ WELL _____ DOCKET NO. _____

SURFACE CASING SIZE 8-5/8" SET AT 300' CEMENTED WITH 150 SACKS

CASING SIZE 5-1/2" SET AT 3879' CEMENTED WITH 125 SACKS

PERFORATED AT 3847-51', 3830-33', 3759-64', 3752-55'

CONDITION OF WELL: GOOD POOR _____ CASING LEAK _____ JUNK IN HOLE _____

OPERATOR'S SUGGESTED METHOD OF PLUGGING THIS WELL As recommended by KDHE

(If additional space is needed use back of form)

IS WELL LOG ATTACHED TO THIS APPLICATION AS REQUIRED? Yes IS ACO-1 FILED? Drilled prior
(If not, explain) to inception of ACO-1

DATE AND HOUR PLUGGING IS DESIRED TO BEGIN April 2, 1986

PLUGGING OF THIS WELL WILL BE DONE IN ACCORDANCE WITH K.S.A. 55-101 et seq AND THE RULES AND REGULATIONS OF THE STATE CORPORATION COMMISSION.

NAME OF COMPANY REPRESENTATIVE AUTHORIZED TO BE IN CHARGE OF PLUGGING OPERATIONS:

Slim Eichman PHONE # (913) 434-2444

ADDRESS Rt. 1, Box 123, Plainville, KS 67663

PLUGGING CONTRACTOR John O. Farmer, Inc. LICENSE NO. 5135

ADDRESS P.O. Box 352, Russell, KS 67665 PHONE # (913) 483-3144

PAYMENT WILL BE GUARANTEED BY OPERATOR OR AGENT SIGNED: John O. Farmer
STATE CORPORATION COMMISSION (Operator or Agent)

MAR 13 1986 DATE: March 12, 1986

6

OPERATOR Jones, Shelburne & Farmer, Inc.

ADDRESS Russell, Kansas

FORMATION RECORD

Give detailed description and thickness of all formations drilled through, contents of sand, whether dry, water, oil or gas.

FARM NAME Tedro WELL NO. 1 COUNTY Graham SEC. 30 TWP. 6 RGE. 25

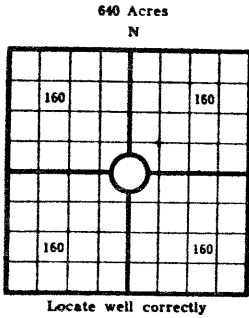

COUNTY Graham SEC. 30 TWP. 6 RGE. 25
 COMPANY OPERATING Jones, Shelburne & Farmer, Inc.
 OFFICE ADDRESS Russell, Kansas
 FARM NAME Tedro WELL NO. 1
 DRILLING STARTED 10-9-55 DRILLING FINISHED 10-17-55
 DATE OF FIRST PRODUCTION _____ COMPLETED _____
 WELL LOCATED NE 1/4 NW 1/4 North of South
 Line and _____ ft East of West Line of Quarter Section
 Elevation (Relative to sea level) DERRICK FLOOR 2610 GROUND _____
 CHARACTER OF WELL (Oil, gas or dryhole) Oil

OIL OR GAS SANDS OR ZONES

Name	From	To	Name	From	To
			4		
			5		
			6		

Perforating Record If Any

Shot Record

Formation	From	To	No of Shots	Formation	From	To	Size of Shot

CASING RECORD

Amount Set								Amount Pulled		Packer Record	
Size	Wt.	Thds.	Make	Ft.	In.	Ft.	In.	Size	Length	Depth Set	Make
8	5/8			300							
5	1/2			3879							

Liner Record: Amount _____ Kind _____ Top _____ Bottom _____

CEMENTING AND MUDDING

Size	Amount Set		Sacks Cement	Chemical		Method of Cementing	Amount	Mudding Method	Results (See Note)
	Ft.	In.		Gal.	Make				
5/8	300		150						
1/2	3879		125						

Note: What method was used to protect sands if outer strings were pulled? _____

NOTE: Were bottom hole plugs used? _____ If so, state kind, depth set and results obtained _____

TOOLS USED

Rotary Tools were used from _____ feet to _____ feet. Cable tools were used from _____ feet to _____ feet, and from _____ feet to _____ feet, and from _____ feet to _____ feet.

Type Rig _____

INITIAL PRODUCTION TEST

Describe initial test: whether by flow through tubing or casing or by pumping _____

Amount of Oil Production _____ bbls. Size of choke, if any _____ Length of test _____ Water Production _____ bbls. Gravity of oil _____ Type of Pump if pump is used, describe _____

Formation	Top	Bottom	Formation	Top	Bottom
Shale & sand	0	300			
Shale	300	950			
Shale & sand	950	1780			
Sand	1780	1920			
Shale & shells	1920	2178			
Anhydrite	2178	2212			
Shale & shells	2212	2540			
Lime & shale	2540	3754			
Lime	3754	3770			
Lime & shale	3770	3780			
Lime	3780	3815			
Lime & shale	3815	3835			
Lime	3835	3850			
Lime & shale	3850	3880			

15-065-03250-00-00

TOPS:

Elev 2610 R.B.
 Heebner 3642
 Toronto 3664
 Lansing 3680
 BKC 3870
 T.D. 3880

STATE CONFERENCE COMMISSION

MAR 13 1986

CONSERVATION DIVISION
Wichita, Kansas

I, the undersigned, being first duly sworn upon oath, state that this well record is true, correct and complete according to the records of this office and to the best of my knowledge and belief.

Shelburne Jones
 Vice-Pres.
 Name and title of representative of company

Subscribed and sworn to before me this 25th day of October, 1955
 My Commission expires July 14, 1958
Bernice Pratt
 Notary Public.



JOHN CARLIN
MICHAEL LENNEN
MARGALEE WRIGHT
KEITH R. HENLEY
JUDITH A. McCONNELL
BRIAN J. MOLINE

Governor
Chairman
Commissioner
Commissioner
Executive Secretary
General Counsel

State Corporation Commission

CONSERVATION DIVISION

(Oil, Gas and Water)
200 Colorado Derby Building
202 West 1st Street
WICHITA, KANSAS 67202-1286

THIS NOTICE

JUN 13 1986

EXPIRES

March 13, 1986

WELL PLUGGING NOTICE

Tedro #1
NE NW NW
Sec. 30-6S-25W
Graham County

John O. Farmer, Inc.
P. O. Box 352
Russell, KS 67665

Gentlemen:

This is your notice to plug the above subject well in accordance with the Rules and Regulations of the State Corporation Commission.

This notice is void after ninety (90) days from the above date.

Sincerely,

William R. Bryson, Director

Please submit your proposal for plugging the above captioned well to
DIST. #6 1014 Cody Hays, KS 67601 913-628-1200

five days prior to plugging the well (KAR-82-3-113).