

TO:
STATE CORPORATION COMMISSION
CONSERVATION DIVISION - PLUGGING
130 SOUTH MARKET, SUITE 2078
WICHITA, KANSAS 67202

API Well Number: 15-001-27647-00-01 *Correction*
Spot: NWNWSE Sec/Twnshp/Rge: 3-26S-18E
2145 feet from S Section Line, 2475 feet from E Section Line
Lease Name: FINNEY NORTH Well #: 61
County: ALLEN Total Vertical Depth: 855 feet

Operator License No.: 32902
Op Name: HOPEWELL OPERATING, INC.
Address: 4600 GREENVEILLE AVE., SUITE 200
DALLAS, TX 75206

PROD Size: 2.875 feet: 855
SURF Size: 6.25 feet: 20

Well Type: EOR UIC Docket No: E24521.4 Date/Time to Plug: 04/02/2005 10:30 AM
Plug Co. License No.: 5491 Plug Co. Name: W & W PRODUCTION COMPANY
Proposal Rcvd. from: MIKE WIMSETT Company: W & W PRODUCTION COMPANY Phone: (620) 431-4137

Proposed Plugging Method: THIS WELL CONSISTED OF 2 7/8" CASING TO 855' THAT HAD BEEN CEMENTED IN FROM BOTTOM TO TOP. THE PLUGGING PROPOSAL WAS TO SQUEEZE THE 2 7/8" CASING FULL OF CEMENT FROM SURFACE.

Plugging Proposal Received By: CLAYTON TITEL WitnessType: NONE
Date/Time Plugging Completed: 04/02/2005 11:00 AM KCC Agent: CLAYTON TITEL

Actual Plugging Report:

THE PUMP TRUCK WAS CONNECTED DIRECTLY TO THE 2 7/8" CASING. CEMENT WAS PUMPED INTO THE 2 7/8" CASING UNTIL THE WELL WOULD HOLD PRESSURE. THE WELL WAS THEN SHUT IN AT 250PSI. 37 SACKS OF CEMENT WERE PUMPED INTO THIS WELL.

Perfs:

Top	Bot	Thru	Comments
801	808	CSG	SURFACE

RECEIVED
APR 18 2005
KCC WICHITA

RECEIVED
KCC DISTRICT #3

APR 6 2005 CPT

CHANUTE, KS

Remarks:

Plugged through: CSG

District: 03

Signed Clayton P. Titel
(TECHNICIAN)

INVOICED
DATE 4-12-05
TEL. NO. 200 506 1398

CARD MUST BE TYPED

State of Kansas

CARD MUST BE SIGNED

NOTICE OF INTENTION TO DRILL

(see rules on reverse side)

J.C. 1-15-86

20

Starting Date .. December 18 1985

API Number 15- 001-27647

OPERATOR: License # 9086
Name MAXAM
Address 819 N. 14th
City/State/Zip Humboldt, Ks 66748
Contact Person Gary L. Laswell
Phone (316) 473-2845

NW NW SE Sec. 3 Twp. 26 S, Rg. 18
2145
2805 *
Should be 2475 FEL
(Note: Locate well on Section Plat on reverse side)

CONTRACTOR: License # 6115
Name Folk Bros. Drilling Co.
City/State Iola, Ks 66749

Nearest lease or unit boundary line 165 feet
County Allen
Lease Name N. Finney Well # 61
Ground surface elevation feet MSL
Domestic well within 330 feet: yes no
Municipal well within one mile: yes no
Surface pipe by Alternate: 1 2 X
Depth to bottom of fresh water 75
Depth to bottom of usable water 150
Surface pipe planned to be set 20
Projected Total Depth 900 feet
Formation Cattleman

Well Drilled For: Well Class: Type Equipment:
Oil SWD Infield Mud Rotary
Gas Inj Pool Ext Air Rotary
OWWO Expl Wildcat Cable

If OWWO: old well info as follows:

Operator
Well Name
Comp Date Old Total Depth

I certify that well will comply with K.S.A. 55-101, et seq., plus eventually plugging hole to KCC specifications.

cementing will be done immediately upon setting production casing.
Date 12/8/85 Signature of Operator or Agent Gary L. Laswell Title Geologist

For KCC Use:

Conductor Pipe Required feet; Minimum Surface Pipe Required feet per Act. 1 2
This Authorization Expires 6-13-86 Approved By 12-13-85

PLUGGING PROPOSAL IF ABOVE IS D & A

This plugging proposal will be reviewed and approved or revised at the time the district office is called prior to setting surface casing (call 7 a.m. to 5 p.m. workdays).

1st plug @ T.D. up 50 ft feet depth with 6 sxs of Portland A
2nd plug @ 450-500 feet depth with 6 sxs of Portland A
3rd plug @ 5-350 feet depth with 40 sxs of Portland A
4th plug @ feet depth with sxs of
5th plug @ feet depth with sxs of
(2) Rathole with sxs (b) Mousehole with sxs

NOTE: Agreement between operator and district office on plug placement and the amount of cement to be used is necessary prior to plugging. Important: Call district office after well is either plugged or production casing is cemented in.

(Call 7 a.m. to 5 p.m. workdays)

District office use only:

API #15- 001-27647
Legal, T, S, R
Surface casing of feet set with sxs at hours, 19
Alternate 1 or 2 surface pipe was used.
Alternate 2 cementing was completed @ ft. depth with sxs on, 19
Hole plugged, 19, agent

Form C-1 6/85

RECEIVED
APR 18 2005
KCC WICHITA

SE 1/4 of 3-26-18E. Allen County

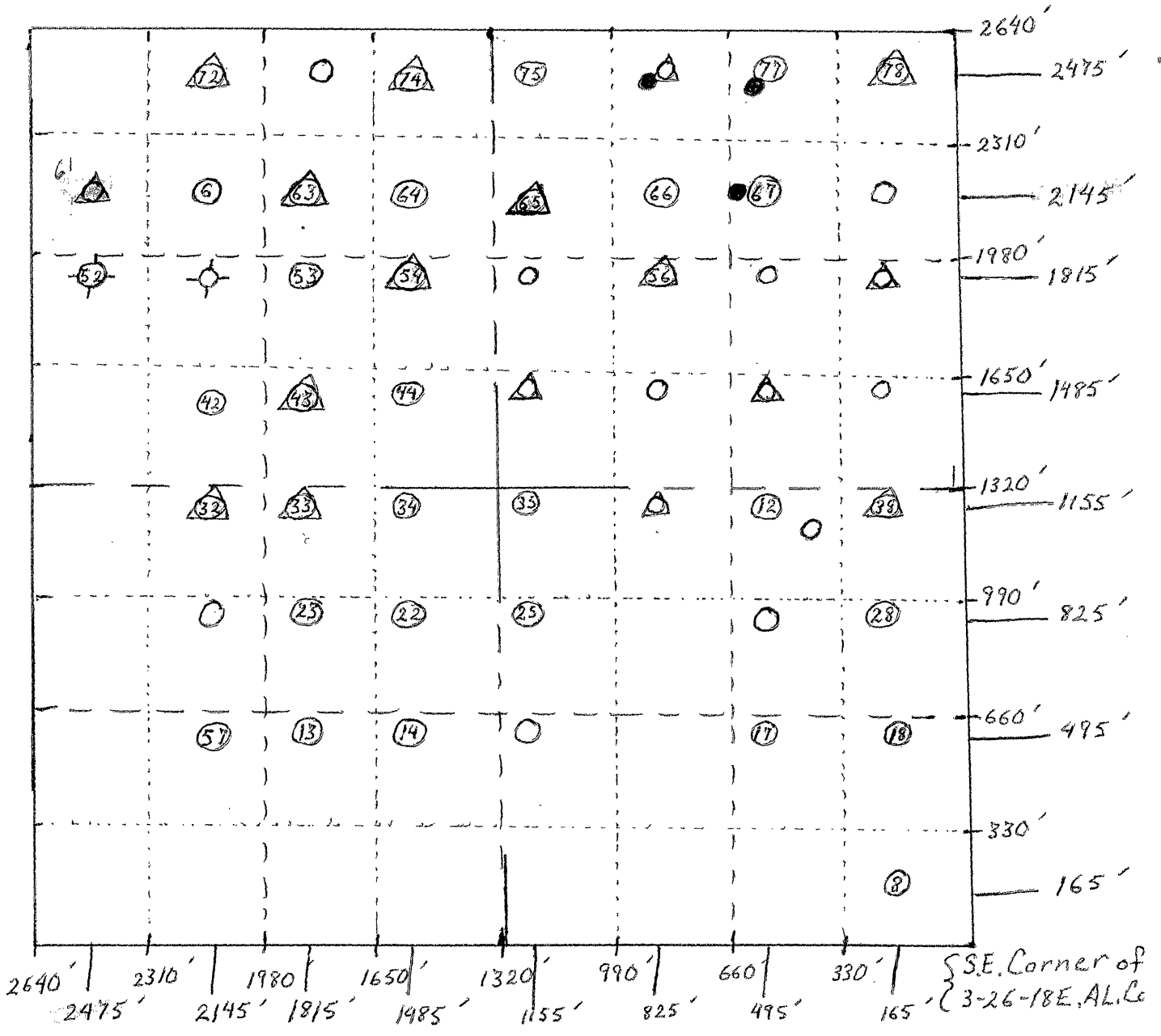
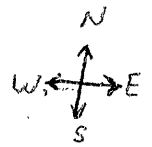

Well Locations From Lse. Insp.

- = Producer Well (No Intent-to-Drill Found)
- ⊙ = Producer Well & No. (Intent Found)
- ▲ = Injection Well (No Intent Found)
- ▲⊙ = Injection Well & No. (Intent Found)
- ⊕ = Unplugged, uncompleted well (& No. IF Intent Found)
- = Old abandoned well. (Some pipe in well)
(See lse. insp. dated 2/14/89 for details)

RECEIVED
APR 18 2005
KCC WICHITA

Computer Update

2:15 @ 85' ±
3:15 @ 83' ±

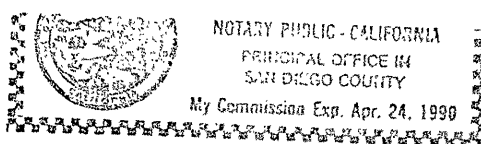

APR 18 1989

Chanute, KS

JIC application plat map or attach a copy of an equivalent map. Indicate
 (p, range, and appropriate section numbers. Then locate applicant injection
 , plus all producing wells, abandoned wells, plugged holes, and other wells
 thin a half mile radius. Also show lease boundaries, lease operators, well
 numbers, and producing wells producing formation tops.

Range 18 E W/E

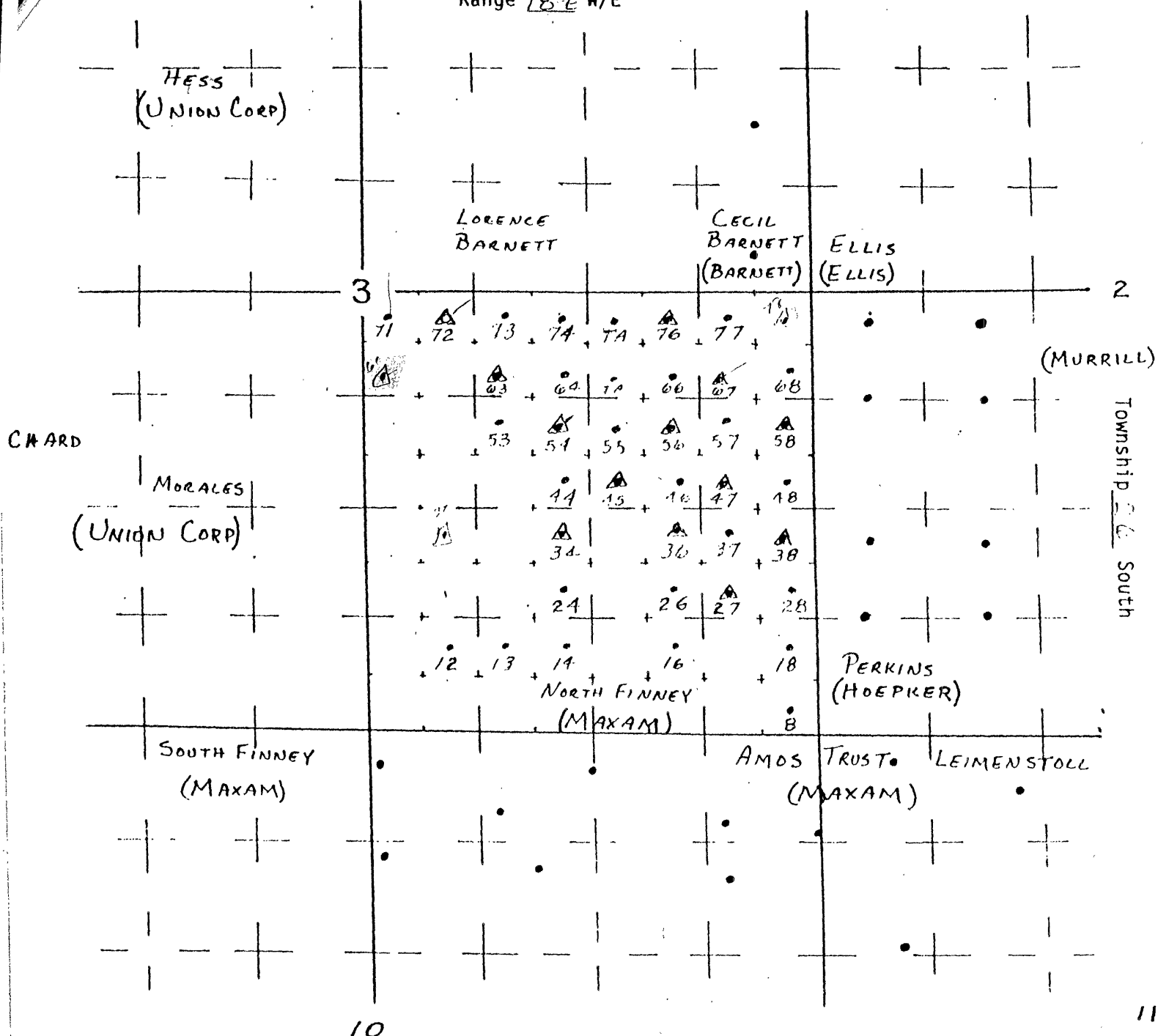

- applicant well
 - other injection wells (including disposal)
 - producing wells
 - temporary abandoned well
 - plugged producer
 - D & A well
 - plugged injection well
 - water supply well
- LANDOWNER
 LEASE - OWNER
 (OPERATOR)

RECEIVED
 APR 18 2005
 KCC WICHITA

Operator MAXAM, INC. Lease NORTH FINNEY County ALLEN