

STATE OF KANSAS
STATE CORPORATION COMMISSION
CONSERVATION DIVISION
500 INSURANCE BUILDING
212 NORTH MARKET
WICHITA 2, KANSAS

RECEIVED
STATE CORPORATION COMMISSION

JUL 21 1960

CONSERVATION DIVISION
Wichita, Kansas

7-21-60

WELL PLUGGING APPLICATION FORM
File One Copy

Lease Owner (Applicant) JOHN O. FARMER, INC. 15-179-00082-00-00
Address Russell, Kansas

Lease (Farm Name) WENTE Well No. 1

Well Location SW SE Sec. 36 Twp. 6S Rge. (E) (W) 26

County Sheridan Field Name (If any) _____

Total Depth 3945 Oil Well _____ Gas Well _____ Input Well _____ SWD Well _____ D & A X

Was well log filed with application? yes If not, explain: _____

Date and hour plugging is desired to begin 7/14/60 at 8:00 PM

Plugging of the well will be done in accordance with the Rules and Regulations of the State Corporation Commission.

Name of the person on the lease in charge of well owner _____

Dale Buchheiser Address Plainville, Kansas

Plugging Contractor JOHN O. FARMER, INC. License No. _____

Address Russell, Kansas

Invoice covering assessment for plugging this well should be sent to _____

JOHN O. FARMER, INC. Address P.O. Box 352, Russell, Kansas

and payment will be guaranteed by applicant.

Signed: John O. Farmer
Applicant or Acting Agent

Date: July 18, 1960

OPERATOR JOHN O. FARMER, INC. 15-179-00082-00-00

FORMATION RECORD

ADDRESS Russell, Kansas

Give detailed description and thickness of all formation drilled through, contents of sand, whether dry, water, oil or gas.

WELL NO. 1 COUNTY Sheridan SEC. 36 TWP. 6S RGE. 26W

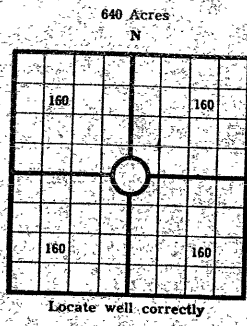

COUNTY Sheridan SEC. 36 TWP. 6S RGE. 26W
 COMPANY OPERATING JOHN O. FARMER, INC.
 OFFICE ADDRESS Russell, Kansas
 DRILLING STARTED 7/6 1960 DRILLING FINISHED 7/14 1960
 DATE OF FIRST PRODUCTION _____ COMPLETED _____
 WELL LOCATED SW 1/4 SE 1/4 _____ North of South
 Line and _____ ft. East of West Line of Quarter Section
 Elevation (Relative to sea level) DERRICK FLOOR 2604 GROUND 2601
 CHARACTER OF WELL (Oil, gas or dryhole) Dry

Formation	Top	Bottom	Formation	Top	Bottom
FARM NAME			<u>WENITE #1</u>		
Surface	0	305			
Shale	305	430			
Shale & sand	430	1300			
Shale & flint rock	1300	1590	ELEVATION: RB	2606	
Shale & shells	1590	1840	TOPS:		
Shale & lime	1840	2210		Sample Log	
Anhydrite	2210	2248			
Shale & shells	2248	2720	Anhydrite	2210	
Shale & lime	2720	2830	Heebner	3697	3688
Lime & shale	2830	2965	Toronto	3717	3710
Shale & lime	2965	3100	Lansing	3733	3726
Lime & shale	3100	3275	B/KC	3927	3927
Shale & lime	3275	3385	T.D.	3945	3940
Lime & shale	3385	3740			
Lime	3740	3920	D & A		
Lime & shale	3920	3945			
R.T.D.	3945	3945			

OIL OR GAS SANDS OR ZONES

Name	From	To	Name	From	To
1			4		
2			5		
3			6		

Perforating Record if Any

Shot Record

Formation	From	To	No. of Shots	Formation	From	To	Size of Shot

CASING RECORD

Amount Set								Amount Pulled		Packer Record	
Size	Wt.	Thds.	Make	Ft.	In.	Ft.	In.	Size	Length	Depth Set	Make
8-5/8				305							

Liner Record: Amount _____ Kind _____ Top _____ Bottom _____

CEMENTING AND MUDDING

Size	Amount Set		Sacks Cement	Chemical		Method of Cementing	Amount	Mudding Method	Results (See Note)
	Ft.	In.		Gal.	Make				
8-5/8	305		160						

Note: What method was used to protect sands if outer strings were pulled? _____

NOTE: Were bottom hole plugs used? _____ If so, state kind, depth set and results obtained _____

TOOLS USED

Rotary Tools were used from _____ feet to _____ Cable tools were used from _____ feet to _____ feet, and from _____ feet to _____ feet, and from _____ feet to _____ feet to _____

Type Rig _____

INITIAL PRODUCTION TEST

Describe initial test: whether by flow through tubing or casing or by pumping _____

Amount of Oil Production _____ bbls. Size of choke, if any _____ Length of test _____ Water Production _____ bbls. Gravity of oil _____ Type of Pump if pump is used, describe _____

I, the undersigned, being first duly sworn upon oath state that this well record is true, correct and complete according to the records of this office and to the best of my knowledge and belief.

John O. Farmer
 Name and title of representative of company

Subscribed and sworn to before me this 18th day of July, 1960

My Commission expires 10/11/62

Lucille Jones
 Notary Public



15-179-00082-00-00

GEORGE DOCKING Governor
 HARRY G. WILES Chairman
 MARION BEATTY Commissioner
 RICHARD C. BYRD Commissioner
 RAYMOND B. HARVEY Secretary
 J. ROBERT WILSON Counsel

State Corporation Commission

CONSERVATION DIVISION

(Oil, Gas and Water)

500 Insurance Bldg. 212 N. Market

WICHITA, KANSAS

JEWEL M. OGDEN, Director

WELL PLUGGING AUTHORITY

July 21, 1960

Well No. 1
 Lease Wente
 Description SW SE 36-6-26W
 County Sheridan

John O. Farmer Inc.
 370 W. Wichita
 Russell, Kansas

Gentlemen:

This is your authority to plug the above subject well in accordance with the Rules and Regulations of the State Corporation Commission.

This authority is void after 90 days from the above date.

Very truly yours,

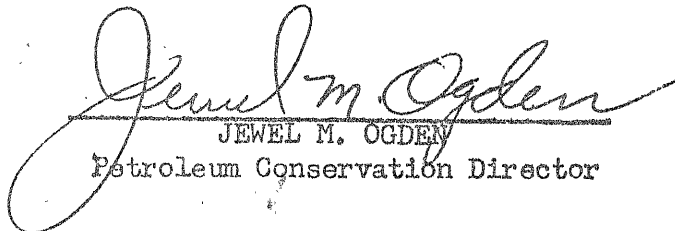
 JEWEL M. OGDEN
 Petroleum Conservation Director

Mr. Fabricius
 is hereby assigned to supervise the plugging of the above named well.

In the event you need any further information regarding this well feel free to write or call me at any time.

J. Lewis Brock
 Western Kansas Field Supervisor
 P. O. Box 569
 Great Bend, Kansas
 Phone: GL-33022