

STATE OF KANSAS  
STATE CORPORATION COMMISSION  
CONSERVATION DIVISION  
211 NORTH BROADWAY  
WICHITA, KANSAS

15-179-00115-00-00

WELL PLUGGING APPLICATION FORM  
File One Copy

Lease Owner Jones, Shelburne & Farmer, Inc. Address Russell, Kansas  
(Applicant)  
Lease (Farm Name) Shoemaker Well No. 1

Well Location NW NW SW Sec. 27 Twp. 6 Rge. (E) - (W) 26  
County Sheridan Field Name (if any) Wildcat

Total Depth 4325 Oil Gas Dry Hole X

Was well log filed with application? Yes If not, explain: \_\_\_\_\_

Date and hour plugging is desired to begin 10:00 PM 5-27-55

Plugging of the well will be done in accordance with the Rules and Regulations of the State Corporation Commission.

Name of the person on the lease in charge of well for owner \_\_\_\_\_

Dale Buchheister Address Plainville, Kansas

Plugging Contractor Jones, Shelburne & Farmer, Inc.

Plugging Contractor's License No. \_\_\_\_\_

Address Russell, Kansas

Invoice covering assessment for plugging this well should be sent to

Jones, Shelburne & Farmer, Inc. Address Russell, Kansas

and payment will be guaranteed by applicant.

RECORDED  
STATE CORPORATION COMMISSION  
JUN 4 - 1955  
CONSERVATION DIVISION  
Wichita, Kansas  
6-4-55

John D. Farmer  
Applicant or Acting Agent

Date June 3, 1955

**PLUGGING**  
FILE SEC 27 T 6 R 26W  
BOOK PAGE 124 LINE 2

OPERATOR Jones, Shelburne & Farmer, Inc.

FORMATION RECORD

ADDRESS Russell, Kansas

Give detailed description and thickness of all formations drilled through, contents of sand, whether dry, water, oil or gas.

FARM NAME Shoemaker WELL NO. 1 COUNTY Sheridan SEC. 27 TWP. 6 RGE. 26

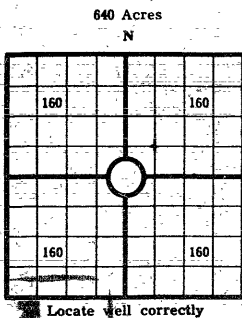

COUNTY Sheridan SEC. 27 TWP. 6 RGE. 26  
 COMPANY OPERATING Jones, Shelburne & Farmer, Inc.  
 OFFICE ADDRESS Russell, Kansas  
 FARM NAME Shoemaker WELL NO. 1  
 DRILLING STARTED 5-16-55 DRILLING FINISHED 5-27-55  
 DATE OF FIRST PRODUCTION \_\_\_\_\_ COMPLETED \_\_\_\_\_  
 WELL LOCATED NW 1/4 NW 1/4 SW 1/4 North of South  
 Line and \_\_\_\_\_ ft. East of West Line of Quarter Section  
 Elevation (Relative to sea level) DERRICK FLOOR 2648 GROUND 2643  
 CHARACTER OF WELL (Oil, gas or dryhole) Dry

Formation	Top	Bottom	Formation	Top	Bottom
Shale & sand	0	300			
Shale	300	900			
Shale & sand	900	1710			
Shale & shells	1710	1900			
Sand	1900	2025			
Shale & shells	2025	2284			
Anhydrite	2284	2320			
Shale & shells	2320	2560			
Shale & lime	2560	2750			
Lime & shale	2750	4035			
Shale & lime	4035	4110			
Lime & shale	4110	4250			
Lime & shale & Chert	4250	4290			
Lime & shale	4290	4325			
T.D.		4325			

TOPS:

Elevation KB 2650  
 Anhydrite 2284  
 Heebner 3759  
 Toronto 3781  
 Lansing 3798  
 Base/Kansas City 4009  
 Pennsylvania Sand 4224  
 Conglomerate 4256  
 Arbuckle 4294  
 T.D. 4325

15-179-0015-00-00

RECEIVED  
 THE COMMISSIONER OF GEORGE  
 JUN 17 1955

OIL OR GAS SANDS OR ZONES

Name	From	To	Name	From	To

Perforating Record if Any

Shot Record

Formation	From	To	No. of Shots	Formation	From	To	Size of Shot

CASING RECORD

Amount Set							Amount Pulled				Packer Record	
Size	Wt.	Thds.	Make	Ft.	In.	Ft.	In.	Size	Length	Depth Set	Make	
8-5/8				300								

Liner Record: Amount \_\_\_\_\_ Kind \_\_\_\_\_ Top \_\_\_\_\_ Bottom \_\_\_\_\_

CEMENTING AND MUDDING

Size	Amount Set		Sacks Cement	Chemical		Method of Cementing	Amount	Mudding Method	Results (See Note)
	Ft.	In.		Gal.	Make				
8-5/8	300		135						

Note: What method was used to protect sands if outer strings were pulled?

NOTE: Were bottom hole plugs used? \_\_\_\_\_ If so, state kind, depth set and results obtained \_\_\_\_\_

TOOLS USED

Rotary Tools were used from \_\_\_\_\_ feet to \_\_\_\_\_ feet to \_\_\_\_\_ feet, and from \_\_\_\_\_ feet to \_\_\_\_\_ feet, and from \_\_\_\_\_ feet to \_\_\_\_\_ feet.

Type Rig \_\_\_\_\_

INITIAL PRODUCTION TEST

Describe initial test: whether by flow through tubing or casing or by pumping \_\_\_\_\_

Amount of Oil Production \_\_\_\_\_ bbls. Size of choke, if any \_\_\_\_\_ Length of test \_\_\_\_\_ Water

Production \_\_\_\_\_ bbls. Gravity of oil \_\_\_\_\_ Type of Pump if pump is used, describe \_\_\_\_\_

I, the undersigned, being first duly sworn upon oath, state that this well record is true, correct and complete according to the records of this office and to the best of my knowledge and belief.

John W. Farmer  
 Name and title of representative of company

Subscribed and sworn to before me this 3rd day of June, 19 55  
 My Commission expires 10-11-58  
Lucille L. Loney  
 Notary Public



STATE OF KANSAS  
STATE CORPORATION COMMISSION  
CONSERVATION DIVISION  
~~300 EASTING BUILDING~~  
WICHITA 2, KANSAS

15-179-00115-00-00

211 N. Broadway

June 2, 1955

Well No.	1
Lease	Shoemaker
Description	NW NW SW 27-6-26W
County	Sheridan
File No.	12h-2

Jones, Shelburne, Farmer  
Russell  
Kansas

Gentlemen:

This letter is your authority to plug the above subject well, in accordance with the Rules and Regulations of the State Corporation Commission. When you are ready to plug this well, please contact our District Plugging Supervisor, Mr. Eldon Petty, Box 326, Nays, Kansas.

STATE CORPORATION COMMISSION  
CONSERVATION DIVISION

BY: J. P. Roberts  
J. P. ROBERTS

cc: District Plugging Supervisor