

OPERATOR JOHN O. FARMER, INC.

FORMATION RECORD

ADDRESS Russell, Kansas

Give detailed description and thickness of all formation drilled through, contents of sand, whether dry, water, oil or gas.

WELL NO. 1 COUNTY Graham TWP. 6S RGE. 25W

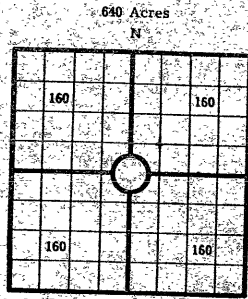

COUNTY Graham SEC. 8 TWP. 6S RGE. 25W
 COMPANY OPERATING John O. Farmer, Inc.
 OFFICE ADDRESS Russell, Kansas
 DRILLING STARTED 1/27, 19 59 DRILLING FINISHED 2/7, 19 59
 DATE OF FIRST PRODUCTION _____ COMPLETED _____
 WELL LOCATED NW 1/4 NW 1/4 SW 1/4, North of South Line and _____ ft. East of West Line of Quarter Section
 Elevation (Relative to sea level) DERRICK FLOOR 2534 GROUND 2531
 CHARACTER OF WELL (Oil, gas or dry hole) Dry

OIL OR GAS SANDS OR ZONES

Name	From	To	Name	From	To
1			4		
2			5		
3			6		

Perforating Record If Any

Shot Record

Formation	From	To	No. of Shots	Formation	From	To	Size of Shot

CASING RECORD

Size	Wt.	Thds.	Amount Set				Amount Pulled				Packer Record	
			Make	Ft.	In.	Ft.	In.	Size	Length	Depth Set	Make	
8-5/8"				210								

Liner Record: Amount _____ Kind _____ Top _____ Bottom _____

CEMENTING AND MUDDING

Size	Amount Set		Sacks Cement	Chemical		Method of Cementing	Amount	Mudding Method	Results (See Note)
	Ft.	In.		Gal.	Make				
8-5/8"	210		135						

Note: What method was used to protect sands if outer strings were pulled?

NOTE: Were bottom hole plugs used? _____ If so, state kind, depth set and results obtained _____

TOOLS USED

Rotary Tools were used from _____ feet to _____ feet. Cable tools were used from _____ feet to _____ feet, and from _____ feet to _____ feet, and from _____ feet to _____ feet.

INITIAL PRODUCTION TEST

Describe initial test: whether by flow through tubing or casing or by pumping _____

Amount of Oil Production _____ bbls. Size of choke, if any _____ Length of test _____ Water Production _____ bbls. Gravity of oil _____ Type of Pump if pump is used, describe _____

Formation	Top		Formation	Bottom	
	Top	Bottom		Top	Bottom
FARM NAME: #1 NOONE					
Shale & sand	0	212			
Shale	212	1035			
Shale & sand	1035	1720			
Redbed	1720	1940			
Shale & shells	1940	2125			
Anhydrite	2125	2160			
Shale & shells	2160	2530			
Shale & shells	2410	2665			
Shale & lime	2665	2905			
Lime & shale	2905	3295			
Shale & lime	3295	3390			
Lime & shale	3390	3560			
Shale & lime	3560	3630			
Lime & shale	3630	3658			
Lime	3658	3690			
Lime & shale	3690	3745			
Lime & shale	3745	4020			
Lime-shale-chert	4020	4045			
T.D.		4045			

15-065-00839000

PLUGGING
FILE SEC 8 T 6 R 25W
BOOK PAGE 15 LINE 32

ELEVATION: RB 8530
2536

SAMPLE TOPS:
Anhydrite 2125
Heebner 3584
Toronto 3613
Lansing 3625
B/KC 3809
Pennsylvanian Sand 3982
Conglomerate chert 4014
Arbuckle dolomite 4032
R.T.D. 4045

D & A
RECEIVED
STATE CORPORATION COMMISSION
FEB 13 1959
CONSERVATION DIVISION
Wichita, Kansas

I, the undersigned, being first duly sworn upon oath, state that this well record is true, correct and complete according to the records of this office and to the best of my knowledge and belief.

John O. Farmer
Name and title of representative of company

Subscribed and sworn to before me this 10th day of February, 19 59
My Commission expires 10/11/62

Lucille K...
Notary Public

State of Kansas



15-065-00839-00-00

State Corporation Commission

CONSERVATION DIVISION

(Oil, Gas and Water)

500 Insurance Bldg. 212 N. Market

WICHITA, KANSAS

JEWELL M. OGDEN, Director

GEORGE DOCKING Governor
MARION BEATTY Chairman
HARRY G. WILES Commissioner
RICHARD C. BYRD Commissioner
RAYMOND B. HARVEY Secretary
CLYDE E. MILLIGAN Counsel

Well No. 1
Lease Noone
Description NW NW SW 8-6-25W
County Graham
File No. 15-32

John O. Farmer, Inc.
Russell,
Kansas

Dear Sirs:

This is your authority to plug the above subject well in accordance with the Rules and Regulations of the State Corporation Commission.

Very truly yours,

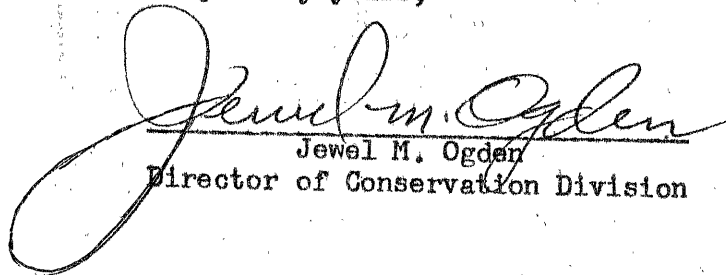
Jewel M. Ogden
Director of Conservation Division

Mr. Fabricius
is hereby assigned to supervise the plugging of the above named well.

In the event you need any further information regarding this well feel free to write or call me at any time.

J. Lewis Brock
Western Kansas Field Supervisor
P. O. Box 569
Great Bend, Kansas
Phone: GL-33022