

S, C

SIDE ONE

STATE CORPORATION COMMISSION OF KANSAS
OIL & GAS CONSERVATION DIVISION

WELL COMPLETION OR RECOMPLETION FORM
ACO-1 WELL HISTORY

DESCRIPTION OF WELL AND LEASE

Operator: License # 8000
Name PanCanadian Petroleum Company
Address 600 - 17th St., Suite 1800S
City/State/Zip Denver, CO 80202

Purchaser: Diamond Shamrock (transported by
Koch Oil Company)

Operator Contact Person Glen M. Jameson
Phone (303) 825-8371

Contractor: License # 6033
Name Murfin Drilling Company

Wellsite Geologist: Daniel Watterson
Phone (303) 825-8371

Designate Type of Completion

- New Well Re-Entry Workover
- Oil SWD Temp Abd
- Gas Inj Delayed Comp.
- Dry Other (Core, Water Supply etc.)

If OWWO: old well info as follows:

Operator
Well Name
Comp. Date Old Total Depth.....

WELL HISTORY

Drilling Method:

- Mud Rotary Air Rotary Cable

03-19-86 03-25-86 04-10-86
Spud Date Date Reached TD Completion Date
4040' 3993'
Total Depth PBDT

Amount of Surface Pipe Set and Cemented at 295 feet
Multiple Stage Cementing Collar Used? Yes No
If yes, show depth set 2-97 feet
If alternate 2 completion, cement circulated
from 2097 feet depth to surface / 375 SX cmt

API NO. 15-065-22311-0000

County: Graham

NE NE Sec 19 Twp 6S Rge 22 East West

660 Ft North from Southeast Corner of Section
4620 Ft West from Southeast Corner of Section
(Note: Locate well in section plat below)

Lease Name: Demuth 41-19 Well # 1

Field Name: Penn

Producing Formation: Lansing-Kansas City

Elevation: Ground 2415 KB 2420

Section Plat

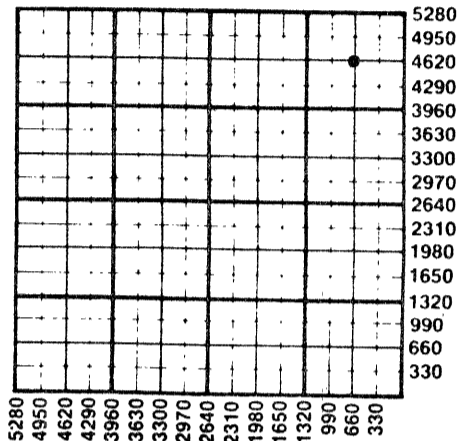

WATER SUPPLY INFORMATION

Disposition of Produced Water: Disposal Repressuring
Docket #

Questions on this portion of the ACO-1 call:
Water Resources Board (913) 296-3717

Source of Water:
Division of Water Resources Permit # T86-5824

Groundwater 4260 Ft North from Southeast Corner
(Well) 4260 Ft West from Southeast Corner of
Sec 20 Twp 6SRge 22 East West

Surface Water Ft North from Southeast Corner
(Stream, pond etc) Ft West from Southeast Corner
Sec Twp Rge East West

Other (explain)
(purchased from city, R.W.D. #)

INSTRUCTIONS: This form shall be completed in duplicate and filed with the Kansas Corporation Commission, 200 Colorado Derby Building, Wichita, Kansas 67202, within 90 days after completion or recompletion of any well. Rule 82-3-130 and 82-3-107 apply. Information on side two of this form will be held confidential for a period of 12 months if requested in writing and submitted with the form. See rule 82-3-107 for confidentiality in excess of 12 months. One copy of all wireline logs and drillers time log shall be attached with this form. Submit CP-4 form with all plugged wells. Submit CP-111 form with all temporarily abandoned wells.

All requirements of the statutes, rules and regulations promulgated to regulate the oil and gas industry have been fully complied with and the statements herein are complete and correct to the best of my knowledge.

Signature James D. Keisling
Title Coordinator, U.S. Operations Date 4-16-86

Subscribed and sworn to before me this 16th day of April 1986
Notary Public Barbara Wolf

Date Commission Expires February 29, 1988

K.C.C. OFFICE USE ONLY
 Letter of Confidentiality Attached
 Wireline Log Received
 Drillers Timelog Received
Distribution
 KCC SWD/Rep NGPA
 KGS Plug Other (Specify)

APR 21 1986

CONSERVATION DIVISION
Wichita, Kansas

4-21-86

Form ACO-1 (7-84)

Sec 19 Twp 6S Rge 22

SIDE TWO

Operator Name PanCanadian Petroleum Company Lease Name Demuth 41-19 Well # 1

Sec. 19 Twp. 6S Rge. 22 East West County Graham

WELL LOG

INSTRUCTIONS: Show important tops and base of formations penetrated. Detail all cores. Report all drill stem tests giving interval tested, time tool open and closed, flowing and shut-in pressures, whether shut-in pressure reached static level, hydrostatic pressures, bottom hole temperature, fluid recovery, and flow rates if gas to surface during test. Attach extra sheet if more space is needed. Attach copy of log.

Drill Stem Tests Taken	<input checked="" type="checkbox"/> Yes	<input type="checkbox"/> No	Formation Description <input checked="" type="checkbox"/> Log <input type="checkbox"/> Sample
Samples Sent to Geological Survey	<input checked="" type="checkbox"/> Yes	<input type="checkbox"/> No	
Cores Taken	<input checked="" type="checkbox"/> Yes	<input type="checkbox"/> No	
DST #1: 3789-3822. 10-45-60-90. Rec'd 640' GIP, 980' oil, 120' MCO (75% oil, 25% mud). SIP 846-846, HP 2100-2068, IFP 108-152, FFP 239-391 BHT = 114°.			Name Top Bottom STONE CORRAL ANHYDRITE 2063(+357) TOPEKA 3421(-1001) HEEBNER 3617(-1197) TORONTO 3643(-1223) LANSING-KANSAS CITY 3659(-1239) CONGLOMERATE 3913(-1493) ARBUCKLE 3985(-1565)
DST #2: 3821-3852. 15-45-60-90. Rec'd 5' mud. SIP 173-173, HP 2057-2046, IFP 21-21, FFP 21-21. BHT = 114°.			
CORE #1: 3791-3723 CORE #2: 3823-3852			
91-92 L.S., Grn. sh. 23-32 Red sh.			
92-99 Sh., Red&grn. 32-35 L.S.			
99-05 L.S., vuggy 35-36 L.S., vuggy			
05-11 Sh., Red&grn. 36-40 L.S. w/stylolites			
11-16 L.S., v. vuggy 40-45 L.S. w/stylolites,			
16-23 L.S., vuggy, 40-45 scattered porosity			
w/grn. sh. 45-49 L.S. A.A. w/fewer			
ptgs. 49-53 L.S. w/grn. sh.			

RELEASED
8-13-87
AUG 1 2 1987

FROM CONFIDENTIAL

CASING RECORD <input checked="" type="checkbox"/> New <input type="checkbox"/> Used Report all strings set-conductor, surface, intermediate, production, etc.							
Purpose of String	Size Hole Drilled	Size Casing Set (in O.D.)	Weight Lbs/Ft.	Setting Depth	Type of Cement	#Sacks Used	Type and Percent Additives
Surface	12 1/4"	8-5/8"	24.00	295'	Cl "A"	250 sx	2% gel, 3% cc
Production	7-7/8"	4 1/2"	10.50	4039'	Cl "A"	350 sx	3% cc
	7-7/8"	4 1/2"	10.50	DV 2097'	Lite	375 sx	-
PERFORATION RECORD Shots Per Foot Specify Footage of Each Interval Perforated				Acid, Fracture, Shot, Cement Squeeze Record (Amount and Kind of Material Used) Depth			
Two	Lansing-Kansas City "I" 3800-3804			1000 gal 15% MCA acid			
Two	Lansing-Kansas City "J" 3809-3820			2750 gal 15% MCA acid			
TUBING RECORD Size <u>2-3/8"</u> Set At <u>3868'</u> Packer at <u>none</u>				Liner Run <input type="checkbox"/> Yes <input checked="" type="checkbox"/> No			
Date of First Production		Producing Method					
04-10-86		<input type="checkbox"/> Flowing <input checked="" type="checkbox"/> Pumping <input type="checkbox"/> Gas Lift <input type="checkbox"/> Other (explain).....					
Estimated Production Per 24 Hours		Oil	Gas	Water	Gas-Oil Ratio	Gravity	
87 Bbls		TSTM MCF		0 Bbls	TSTM CFPB	38° API	

METHOD OF COMPLETION Production Interval

Disposition of gas: Vented Open Hole Perforation
 Sold Other (Specify) 3800'-3804'
 Used on Lease Dually Completed 3809'-3820'
 Commingled

15-065-22311-00-00

CO-7
(Revised) *file*

PLAT AND CERTIFICATION OF ACREAGE ATTRIBUTABLE TO AN OIL WELL

State Corporation Commission, Conservation Division
200 Colorado Derby Bldg. Wichita, Kansas 67202

OPERATOR PanCanadian Petroleum Company

LOCATION OF WELL:

LEASE Demuth

660 feet from the east line

WELL NUMBER 41-19 #1

660 feet from the north line

FIELD Penn

Of the NE corner of Sec 19 T. 6S R. 22W

*NUMBER OF ACRES
ATTRIBUTABLE TO WELL 40

COUNTY Graham

DESCRIPTION OF ACREAGE:

C NE/4 NE/4 Section 19-T6S-R22W

PLAT

(Show location of Well and outline attributable acreage)
(Show footage to nearest lease or unit boundary line)

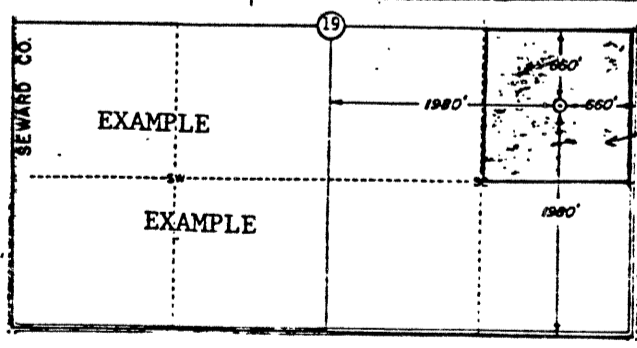
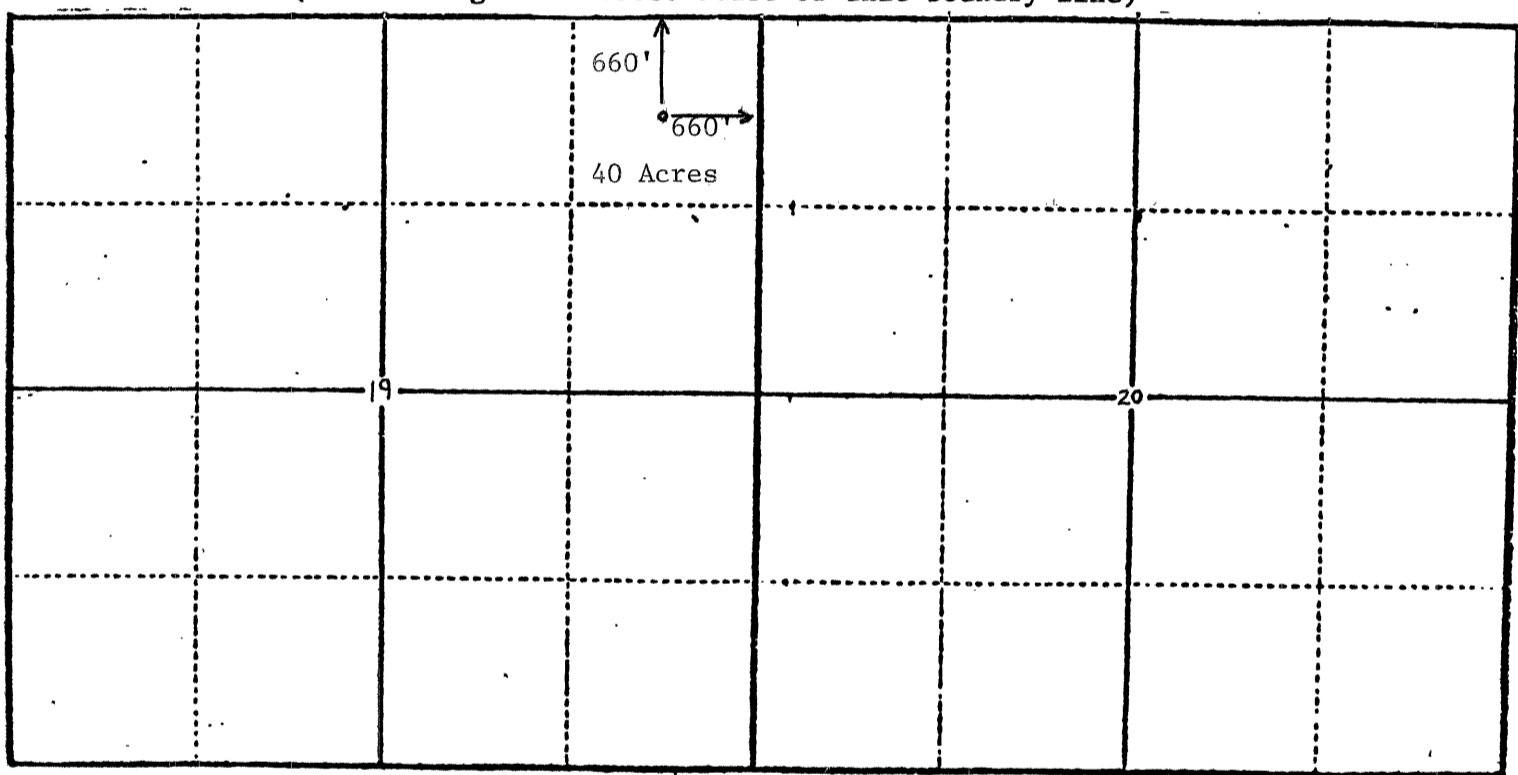

RECEIVED
STATE CORPORATION COMMISSION
APR 21 1986
CONSERVATION DIVISION
Wichita, Kansas
4-21-86

The undersigned hereby certifies that he is Coordinator U.S. Operations for PanCanadian Petroleum Company, a duly authorized agent, that all information shown hereon is true and correct to the best of his knowledge and belief, and that all acreage claimed as attributable to the well named herein is held by production from that well.

Suscribed and sworn to before me on this 17th day of April, 19 86

James D. Keisling
James D. Keisling
Barbara Wolf
Notary Public

My Commission Expires
February 29, 1988

My Commission expires _____

15-065-22311-00-00

CO-7
(Revised)

PLAT AND CERTIFICATION OF ACREAGE ATTRIBUTABLE TO AN OIL WELL

State Corporation Commission, Conservation Division
200 Colorado Derby Bldg. Wichita, Kansas 67202

OPERATOR PanCanadian Petroleum Company

LOCATION OF WELL:

LEASE Demuth

660 feet from the east line
660 feet from the north line

WELL NUMBER 41-19 #1

Of the NE corner of Sec 19 T. 6S R. 22W

FIELD Penn

COUNTY Graham

*NUMBER OF ACRES
ATTRIBUTABLE TO WELL 40

DESCRIPTION OF ACREAGE:

C NE/4 NE/4 Section 19-T6S-R22W

PLAT

(Show location of Well and outline attributable acreage)
(Show footage to nearest lease or unit boundary line)

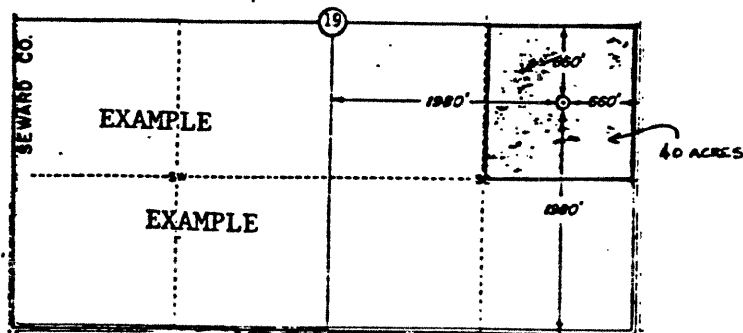
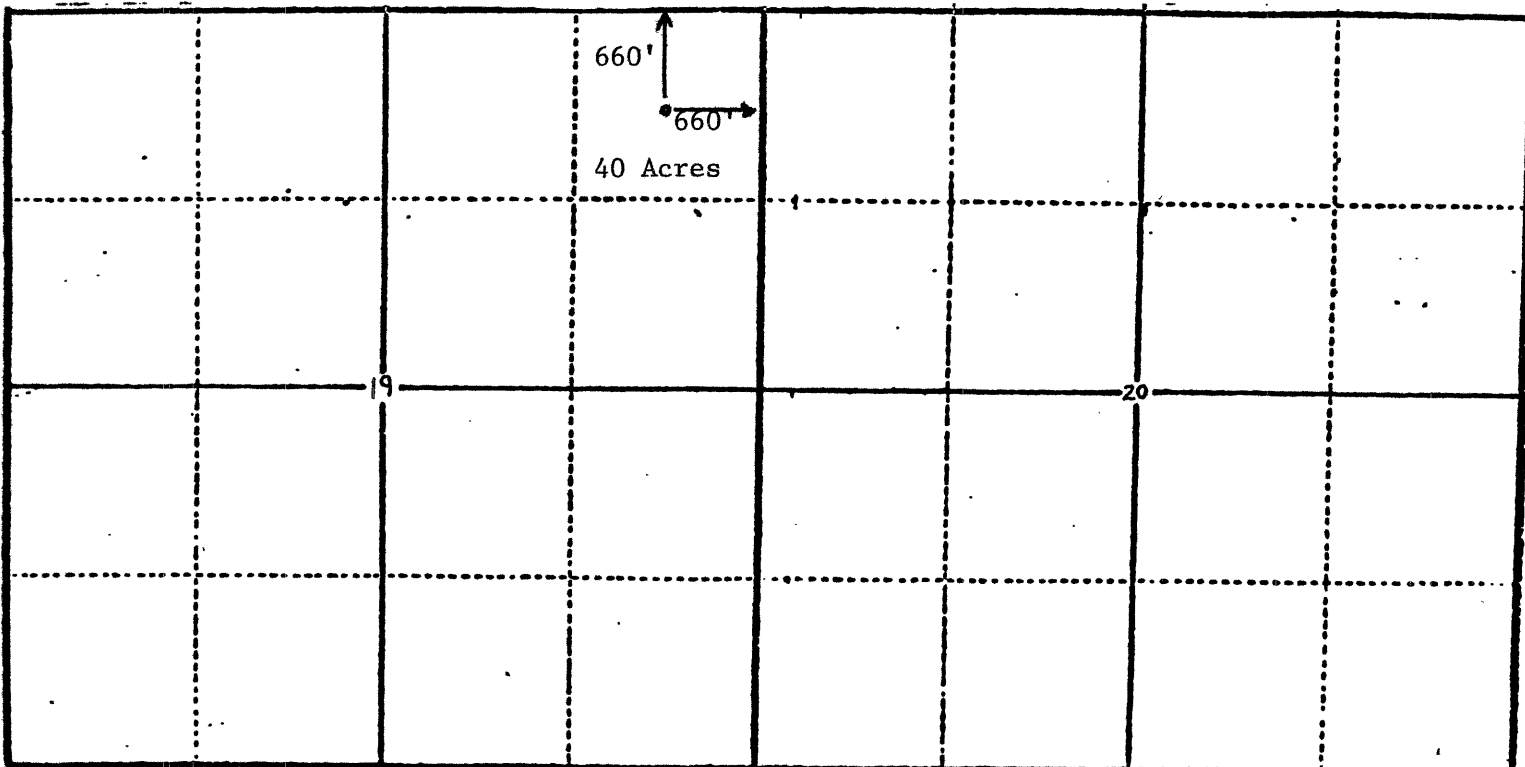

The undersigned hereby certifies that he is Coordinator U.S. Operations for PanCanadian Petroleum Company, a duly authorized agent, that all information shown hereon is true and correct to the best of his knowledge and belief, and that all acreage claimed as attributable to the well named herein is held by production from that well.

Suscribed and sworn to before me on this 17th day of April, 19 86

James D. Keisling
James D. Keisling

RECEIVED
STATE CORPORATION COMMISSION

Barbara Wolf
Notary Public

My Commission Expires APR 21 1986
February 29, 1988

My Commission expires _____

CONSERVATION DIVISION
Wichita, Kansas

4-21-86