

STATE CORPORATION COMMISSION OF KANSAS
OIL & GAS CONSERVATION DIVISION
WELL COMPLETION OR RECOMPLETION FORM
ACO-1 WELL HISTORY
DESCRIPTION OF WELL AND LEASE

API NO. 15-065-22,470-00-00
County Graham
NE NE SW Sec 24 Twp 6S Rge 22 East
West

Operator: License # 4767
Name Ritchie Exploration, Inc.
Address 125 N. Market, Suite 1000
City/State/Zip Wichita, KS 67202

2310 Ft North from Southeast Corner of Section
2970 Ft West from Southeast Corner of Section
(Note: Locate well in section plat below)

Purchaser N/A

Lease Name Keiswetter-24C Well # 1

Operator Contact Person Jeff Christian
Phone 316/267-4375

Field Name

Producing Formation N/A

Contractor: License # 6033
Name Murfin Drilling Co.

Elevation: Ground 2288! KB 2293!

Wellsite Geologist Bob Mathiesen
Phone 316/267-4375

PLEASE KEEP THIS
INFORMATION
CONFIDENTIAL

Section Plat

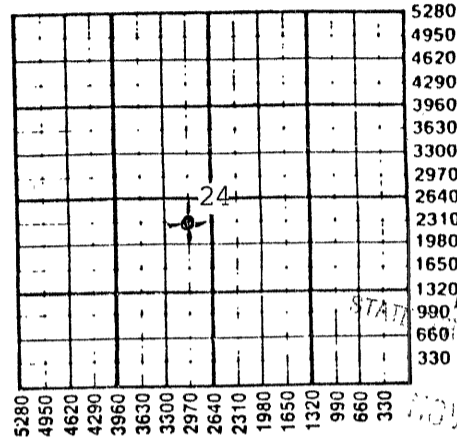

RECEIVED
CORPORATION COMMISSION

NOV 5 1988
11-3-88

CONSERVATION DIVISION
Wichita Kansas

Designate Type of Completion
 New Well Re-Entry Workover
 Oil SWD Temp Abd
 Gas Inj Delayed Comp.
 Dry Other (Core, Water Supply etc.)

WATER SUPPLY INFORMATION

Disposition of Produced Water: Disposal Repressuring
Docket # N/A

If ONWO: old well info as follows:
Operator
Well Name
Comp. Date Old Total Depth

WELL HISTORY

Drilling Method:
 Mud Rotary Air Rotary Cable
7/11/88 7/18/88 7/18/88
Spud Date Date Reached TD Completion Date
3895' N/A
Total Depth PBD
8-5/8" @ 245'
Amount of Surface Pipe Set and Cemented at...feet
Multiple Stage Cementing Collar Used? Yes No
If yes, show depth set...feet
If alternate 2 completion, cement circulated
from...feet depth to...w/...SX cmt
Cement Company Name
Invoice # A-I-D D&D

Questions on this portion of the ACO-1 call:
Water Resources Board (913) 296-3717

Source of Water:
Division of Water Resources Permit #
 Groundwater...Ft North from Southeast Corner
(Well)Ft West from Southeast Corner of
Sec Twp Rge East West
 Surface Water...Ft North from Southeast Corner
(Stream, pond etc).....Ft West from Southeast Corner
Sec Twp Rge East West
 Other (explain) Water hauled.
(purchased from city, R.W.D. #)

INSTRUCTIONS: This form shall be completed in triplicate and filed with the Kansas Corporation Commission, 200 Colorado Derby Building, Wichita, Kansas 67202, within 120 days of the spud date of any well. Rule 82-3-130, 82-3-107 and 82-3-106 apply. Information on side two of this form will be held confidential for a period of 12 months if requested in writing and submitted with the form. See rule 82-3-107 for confidentiality in excess of 12 months. One copy of all wireline logs and drillers time log shall be attached with this form. Submit CP-4 form with all plugged wells. Submit CP-111 form with all temporarily abandoned wells.

All requirements of the statutes, rules and regulations promulgated to regulate the oil and gas industry have been fully complied with and the statements herein are complete and correct to the best of my knowledge.

Signature [Signature]
Title Vice President Date 9/28/88

Subscribed and sworn to before me this 28th day of September 1988
Notary Public Ponda K. Rice

Date Commission Expires

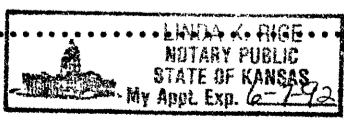

K.C.C. OFFICE USE ONLY
 Letter of Confidentiality Attached
 Wireline Log Received
 Drillers Timelog Received
Distribution
 KCC SWD/Rep NGPA
 KGS Plug Other
(Specify)
11-3-88
Form ACO-1 (5-86)

Section 21 Twp. 6 S. Rge. 22 E.

SIDE TWO

Operator Name Ritchie Exploration, Inc. Lease Name Keiswetter-24C Well # 1

RELEASED

Sec. 24 Twp. 6S Rge. 22W County Graham

East
 West

MAR 07 1990

3-7-90
FROM CONFIDENTIAL

WELL LOG

INSTRUCTIONS: Show important tops and base of formations penetrated. Detail all cores. Report all drill stem tests giving interval tested, time tool open and closed, flowing and shut-in pressures, whether shut-in pressure reached static level, hydrostatic pressures, bottom hole temperature, fluid recovery, and flow rates if gas to surface during test. Attach extra sheet if more space is needed. Attach copy of log.

Drill Stem Tests Taken Yes No
Samples Sent to Geological Survey Yes No
Cores Taken Yes No

Formation Description
 Log Sample

DST #1 3496'-3564' (Toronto & Top zone). Rec. 40' of mud w/a few oil specks.
IFP: 32-32#/30"; ISIP: 1034#/30";
FFP: 32-32#/30"; FSIP: 1002#/30".

DST #2 3645'-3748' (140'-220'). Rec. 20' of slightly oil cut mud (10% oil, 90% mud).
IFP: 21-21#/30"; ISIP: 787#/30";
FFP: 32-32#/30"; FSIP: 443#/30".

DST #3 (w/straddle packers) 3580'-3614' (50'-90' zones). Recovered 320' of muddy water w/a few oil specks.
IFP: 75-118#/30"; ISIP: 1151#/30";
FFP: 162-194#/30"; FSIP: 1151#/30".

Name	Top	Bottom
Anhydrite	1945' (+ 348)	
B/Anhydrite	1976' (+ 317)	
Topeka	3299' (-1006)	
Heebner	3504' (-1211)	
Toronto	3527' (-1234)	
Lansing	3545' (-1252)	
B/KC	3736' (-1443)	
Cong. zone	3787' (-1494)	
Arbuckle	3863' (-1570)	
LTD	3892' (-1599)	

PLEASE KEEP THIS INFORMATION CONFIDENTIAL

CASING RECORD <input checked="" type="checkbox"/> New <input type="checkbox"/> Used							
Report all strings set-conductor, surface, intermediate, production, etc.							
Purpose of String	Size Hole Drilled	Size Casing Set (In O.D.)	Weight Lbs/Ft.	Setting Depth	Type of Cement	#Sacks Used	Type and Percent Additives
Surface	12 1/2"	8-5/8"	24#	245'	60/40poz	175	2% cel., 3% CC
PERFORATION RECORD				Acid, Fracture, Shot, Cement Squeeze Record			
Shots Per Foot	Specify Footage of Each Interval Perforated			(Amount and Kind of Material Used)		Depth	
TUBING RECORD				Liner Run	<input type="checkbox"/> Yes <input type="checkbox"/> No		
Date of First Production	Producing Method <input type="checkbox"/> Flowing <input type="checkbox"/> Pumping <input type="checkbox"/> Gas Lift <input type="checkbox"/> Other (explain).....						
Estimated Production Per 24 Hours	Oil	Gas	Water	Gas-Oil Ratio	Gravity		
	Bbls	MCF	Bbls	CFPB			

METHOD OF COMPLETION

Production Interval

Disposition of gas: Vented Open Hole Perforation
 Sold Other (Specify)
 Used on Lease Dually Completed
 Commingled