

*** AMENDED**
STATE CORPORATION COMMISSION OF KANSAS
OIL & GAS CONSERVATION DIVISION
WELL COMPLETION OR RECOMPLETION FORM
ACO-1 WELL HISTORY
DESCRIPTION OF WELL AND LEASE

API NO. 15-065-22,440-00-00
County.....Graham
.....C.....SE.....NW.....Sec. 19.....Twp. 6S.....Rge. 22.....East
.....X.....West

Operator: License # 8000
Name PanCanadian Petroleum Company
Address P.O. Box 929
City/State/Zip Denver, CO 80201

* 3630 Ft North from Southeast Corner of Section
3194 2970 Ft West from Southeast Corner of Section
(Note: Locate well in section plat below)

Purchaser N/A

Lease Name Jacobs 22-19 Well # 1

Operator Contact Person Forrest Moore
Phone (303) 825-8371

Field Name Pen

Producing Formation N/A

Contractor: License # 5422
Name Abercrombie Drilling

Elevation: Ground 2428 KB 2433

Wellsite Geologist Dan Watterson
Phone (303) 825-8371

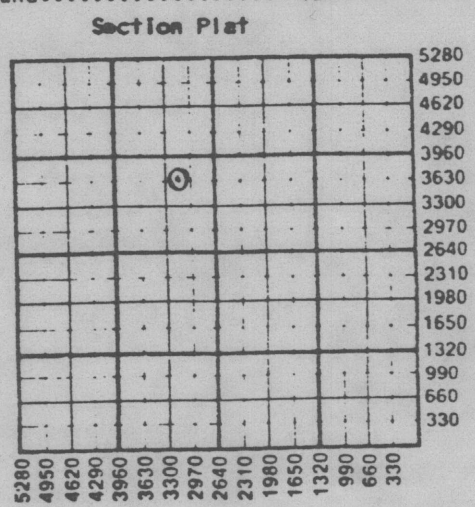

Designate Type of Completion
 New Well Re-Entry Workover
 Oil SWD Temp Abd
 Gas Inj Delayed Comp.
 Dry Other (Core, Water Supply etc.)

If ONNO: old well info as follows:
Operator
Well Name
Comp. Date Old Total Depth

WATER SUPPLY INFORMATION
Disposition of Produced Water: N/A Disposal
Docket # Repressuring

WELL HISTORY

Drilling Method:
 Mud Rotary Air Rotary Cable
3-2-88 3-8-88 3-9-88
Spud Date Date Reached TD Completion Date
3950 3901
Total Depth PBTD
Amount of Surface Pipe Set and Cemented at 312 feet
Multiple Stage Cementing Collar Used? Yes No
If yes, show depth set 2165 feet
If alternate 2 completion, cement circulated from 2165 feet depth to 0 w/ 425 SX cmt
Cement Company Name Halliburton
Invoice # 613827
8-15-88

Questions on this portion of the ACO-1 call:
Water Resources Board (913) 296-3717
Source of Water:
Division of Water Resources Permit #
 Groundwater.....Ft North from Southeast Corner
(Well)Ft West from Southeast Corner of
Sec Twp Rge East West
 Surface Water 2970 Ft North from Southeast Corner
(Stream, pond etc) 3960 Ft West from Southeast Corner
Sec 7 Twp 6S Rge East 20 West
 Other (explain)
(purchased from city, R.W.D. #)

INSTRUCTIONS: This form shall be completed in triplicate and filed with the Kansas Corporation Commission, 200 Colorado Derby Building, Wichita, Kansas 67202, within 120 days of the spud date of any well. Rule 82-3-130, 82-3-107 and 82-3-106 apply. Information on side two of this form will be held confidential for a period of 12 months if requested in writing and submitted with the form. See rule 82-3-107 for confidentiality in excess of 12 months. One copy of all wireline logs and drillers time log shall be attached with this form. Submit CP-4 form with all plugged wells. Submit CP-111 form with all temporarily abandoned wells.

All requirements of the statutes, rules and regulations promulgated to regulate the oil and gas industry have been fully complied with and the statements herein are complete and correct to the best of my knowledge.

Signature James D. Keisling
Title Coordinator, Eng. Opers. U.S. Date 5/19/88

Subscribed and sworn to before me this 19th day of June 1988
Notary Public
Date Commission Expires

K.C.C. OFFICE USE ONLY
 Letter of Confidentiality Attached
 Wireline Log Received
 Drillers Timelog Received
Distribution
 SWD/Rep NGPA
 Plug Other (Specify)
RECEIVED JUN 13 1988
6-13-88
Form ACO-1 (5-86)

Sec 19, Twp 6S, Rge 22W

JOB LOG

FORM 2013 R-2

WELL NO. 22-19 LEASE Jacobs TICKET NO. 613887
 CUSTOMER PAN CANADIAN PETRO PAGE NO. 1
 JOB TYPE Long string - D.U. DATE MAR 8, 1988

CHART NO.	TIME	RATE (BPM)	VOLUME (BBL)	PUMPS		PRESSURE (PSI)		DESCRIPTION OF OPERATION AND MATERIALS
				T	C	TUBING	CASING	
	0115							CALLS OUT
	0515							ON LOC.
								Rig Running csg w/BAKER Float 30 centralizers, 12 scratch pins 2 wt bsk, Float shoe D.U TOOL @ 2165F
	0800							Fin csg
	0805							Hook to BAKER float cont.
	0825							ST. circ - work pipe
								Fin circ
								Hook to Pump Truck
	0828				1		200	START 500 gal mud flush - work pipe
	0831		12		1		200	Fin mud flush
	0834	7			1		200	START mix 430 sks standard cont w/2% cc / 100 flocc
			60		1		200	STOP WORKING PIPE
	0846	7	95		1		300	Fin cont
								WASHUP Pump & Lines
	0847				1		200	ST A 20 Disp
			25		1		200	Fin A 20 Disp - ST mud disp
		7	29		1		400	ST LIFTING CONT
					1		1100	circ pressure
	0900	7	63		1		1700	Fin Disp -
	0910		10		1		700	OPEN D.U. TOOL
	0915							START circ w/mud Pump.
	1155							Finish circ
								Hook to 4 1/2" csg & PTA Rat hole
	1200	8			1		300	START mixing 425 sks HLC w/ 1/4" flocc
	1225	8	149		1		300	Finish mixing - 1 BBL H2O Behind cont
	1225	8			1		300	START Disp
	1229	8			1		700	Cont circ w/28 BBLs Disp rd app. 25 sks
	1230	8	34.5		1		1800	Disp In - Plug landed
	1233							Release psi & Stage Collar - HELD
	1235							Job Complete

RECEIVED
 STATE CORPORATION COMMISSION
 AUG - 1 1988
 CONSERVATION DIVISION
 Wichita, Kansas

Thanks - John, Ron, Mike & Terry

ORIGINAL
VOICE
INVOICE



A DIVISION OF HALLIBURTON COMPANY

REMIT TO:
P.O. BOX 651046
DALLAS, TX 75265

V840263

INVOICE NO. 613827
DATE 03/08/1988

WELL LEASE NO. JACOBS 22 19		WELL LOCATION GRAHAM		STATE KS	WELL OWNER PAN CANADIAN	
SERVICE LOCATION OBERLIN		CONTRACTOR ABERCROMBIE 4	JOB PURPOSE CEMENT PRODUCTION CASING		TICKET DATE 03/08/1988	
ACCT. NO. 664410	CUSTOMER AGENT JOE RUSNAK	VENDOR NO.	CUSTOMER P.O. NUMBER	SHIPPED VIA COMPANY TRUCK	FILE NO. 54947	

PAN CANADIAN PETROLEUM CO.
P O BOX 929
DENVER, CO 80201

RECEIVED
STATE CORPORATION COMMISSION
AUG - 1 1988

DIRECT CORRESPONDENCE TO:
SUITE 600
COLORADO DERBY BUILDING
WICHITA, KS 67202-0000

LINE REF NO	DESCRIPTION	QUANTITY	U/M	UNIT PRICE	AMOUNT
000-117	MILEAGE	50	MI	2.10	105.00
		1	UNT		
007-013	MULT STAGE CEMENTING 1ST STAGE	3972	FT	977.00	977.00
001-016		1	UNT		
007-161	MULT STAGE CEMENTING ADD STAGE	1	STG	660.00	660.00
		1	UNT		
213-009	MUD FLUSH	500	GAL	.45	225.00
504-308	STANDARD CEMENT	450	SK	6.75	3,037.50 *
509-406	ANHYDROUS CALCIUM CHLORIDE	9	SK	25.75	231.75 *
507-210	FLOCELE	113	LB	1.21	136.73 *
504-118	HALLIBURTON LIGHT CEMENT	425	SK	5.99	2,545.75 *
507-210	FLOCELE	107	LB	1.21	129.47 *
500-207	BULK SERVICE CHARGE	893	CPT	.95	848.35 *
500-306	MILEAGE	2057.88	TMI	.70	1,440.52 *
INVOICE SUBTOTAL					10,337.07
DISCOUNT (BID)					2,170.78
INVOICE BID AMOUNT					8,166.29
* KANSAS STATE SALES TAX					264.42
* DECATUR COUNTY SALES TAX					66.10
INVOICE TOTAL - PLEASE PAY THIS AMOUNT					8,496.81

REVIEWED
MAR 29 1988
TREASURY

APPROVED FOR PAYMENT
Sam Hillman
PROJECT # 230-261
0302506
DO NOT INVOICE PARTNERS

REC'D ACCT.
MAR 14 1988
DENVER

PAN CANADIAN PETROLEUM COMPANY
RECEIVED
MAR 14 1988
DENVER, COLORADO