

15-065-01052-00-00

STATE OF KANSAS  
STATE CORPORATION COMMISSION

Give All Information Completely  
Make Required Affidavit  
Mail or Deliver Report to:  
Conservation Division  
State Corporation Commission  
212 North Market, Insurance Bldg.  
Wichita, Kansas

WELL PLUGGING RECORD

NORTH

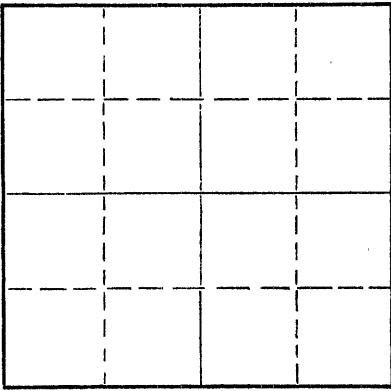

Locate well correctly on above  
Section Plat

Graham County. Sec. 5 Twp. 6s Rge. 24w (E) (W)

Location as "NE/CNWxSWx" or footage from lines C NE SW

Lease Owner John O. Farmer, Inc.

Lease Name Peterson Well No. # 1

Office Address P.O. Box 352, Russell, Kansas

Character of Well (completed as Oil, Gas or Dry Hole) Dry

Date well completed 11/21 19 63

Application for plugging filed 11/21 19 63

Application for plugging approved 11/21 19 63

Plugging commenced 11/21 19 63

Plugging completed 5:30 P.M. 11/21 19 63

Reason for abandonment of well or producing formation Dry

If a producing well is abandoned, date of last production \_\_\_\_\_ 19 \_\_\_\_\_

Was permission obtained from the Conservation Division or its agents before plugging was commenced? Yes

Name of Conservation Agent who supervised plugging of this well W. L. Nichols

Producing formation \_\_\_\_\_ Depth to top \_\_\_\_\_ Bottom \_\_\_\_\_ Total Depth of Well 3805' Feet

Show depth and thickness of all water, oil and gas formations.

OIL, GAS OR WATER RECORDS

CASING RECORD

FORMATION	CONTENT	FROM	TO	SIZE	PUT IN	PULLED OUT

Describe in detail the manner in which the well was plugged, indicating where the mud fluid was placed and the method or methods used in introducing it into the hole. If cement or other plugs were used, state the character of same and depth placed, from \_\_\_\_\_ feet to \_\_\_\_\_ feet for each plug set.

Plug # 1 540' 20 sx cement  
# 2 190' 20 sx cement  
# 3 40' 10 sx cement

Completed: 5:30 P.M. 11/21/63

RECEIVED  
STATE CORPORATION COMMISSION

DEC 2 1963

CONSERVATION DIVISION  
Wichita, Kansas

12-2-63

Name of Plugging Contractor John O. Farmer, Inc.  
Address P.O. Box 352, Russell, Kansas

STATE OF KANSAS, COUNTY OF RUSSELL, ss.  
JOHN O. FARMER (employee of owner) or (owner or operator) of the above-described

well, being first duly sworn on oath, says: That I have knowledge of the facts, statements, and matters herein contained and the log of the above-described well as filed and that the same are true and correct. So help me, God.

(Signature) John O. Farmer

P.O. Box 352, Russell, Kansas  
(Address)

SUBSCRIBED AND SWORN to before me this 26 day of November, 19 63

My commission expires February 15, 1967

Helen Carlson  
Helen Carlson Notary Public.

OPERATOR John O. Farmer, Inc.

FORMATION RECORD

ADDRESS P.O. Box 352, Russell, Kansas

Give detailed description and thickness of all formation drilled through, contents of sand, whether dry, water, oil or gas.

WELL NO. # 1 COUNTY Graham TWP 6S RGE 24W

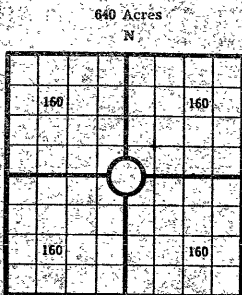

COUNTY Graham, SEC. 5, TWP. 6S, RGE. 24W  
 COMPANY OPERATING John O. Farmer, Inc.  
 OFFICE ADDRESS P.O. Box 352, Russell, Kansas  
 DRILLING STARTED 11/12 1963 DRILLING FINISHED 11/21 1963  
 DATE OF FIRST PRODUCTION \_\_\_\_\_ COMPLETED \_\_\_\_\_  
 WELL LOCATED C 1/4 NE 1/4 SW 1/4, North of South  
 Line and \_\_\_\_\_ ft. East of West Line of Quarter Section  
 Elevation (Relative to sea level) DERRICK FLOOR 2439 GROUND, 2436  
 CHARACTER OF WELL (Oil, gas or dryhole) Dry

Formation	Top	Bottom	Formation	Top	Bottom
Shale		600'			
Shale & Sand	600	2150'			
Shale & Shells	2150	2650'			
Shale & Lime	2650	3062'			
Lime & Shale	3062	3770'			
Lime	3770	3805'			

OIL OR GAS SANDS OR ZONES

Name	From	To	Name	From	To
1			4		
2			5		
3			6		

Perforating Record If Any

Formation	From	To	No. of Shots

Shot Record

Formation	From	To	Size of Shot

CASING RECORD

Amount Set						Amount Pulled		Packer Record	
Size	Wt.	Thds.	Make	Ft.	In.	Size	Length	Depth Set	Make

Liner Record: Amount \_\_\_\_\_ Kind \_\_\_\_\_ Top \_\_\_\_\_ Bottom \_\_\_\_\_

CEMENTING AND MUDDING

Size	Amount Set	Sacks	Chemical	Method of	Mudding	Results
	Ft.	Cement	Gal.	Make	Method	(See Note)
8 5/8	204'	140	sx.			

Note: What method was used to protect sands if outer strings were pulled? \_\_\_\_\_

NOTE: Were bottom hole plugs used? \_\_\_\_\_ If so, state kind, depth set and results obtained \_\_\_\_\_

TOOLS USED  
 Rotary Tools were used from 0 feet to R.T.D. Cable tools were used from \_\_\_\_\_ feet to \_\_\_\_\_ feet, and from \_\_\_\_\_ feet to \_\_\_\_\_ feet, and from \_\_\_\_\_ feet to \_\_\_\_\_ feet  
 Type Rig: Rotary

INITIAL PRODUCTION TEST  
 Describe initial test: whether by flow through tubing or casing or by pumping \_\_\_\_\_  
 Amount of Oil Production \_\_\_\_\_ bbls. Size of choke, if any \_\_\_\_\_ Length of test \_\_\_\_\_ Water  
 Production \_\_\_\_\_ bbls. Gravity of oil \_\_\_\_\_ Type of Pump if pump is used, describe \_\_\_\_\_

Log Tops

Heebner	3568	(-1127)
Toronto	3592	(-1151)
Lansing KC	3608	(-1167)
Base of K.O.	3790	(-1349)
T. D.	3808	(-1367)

RECEIVED  
 STATE CORPORATION COMMISSION  
 DEC 2 1963  
 CONSERVATION DIVISION  
 Wichita, Kansas

15-065-01052-00-00

I, the undersigned, being first duly sworn upon oath, state that this well record is true, correct and complete according to the records of this office and to the best of my knowledge and belief.

John O. Farmer  
 Name and title of representative of company  
 President

Subscribed and sworn to before me this 26 day of November, 1963

My Commission expires 2/15/67  
Helen Carlson  
 Notary Public

FARM NAME: PETERSON