

For KCC Use:  
Effective Date: 5-30-05  
District # 1  
SGA?  Yes  No

\* BLOW-OUT PREVENTOR REQUIRED.

KANSAS CORPORATION COMMISSION  
OIL & GAS CONSERVATION DIVISION  
**NOTICE OF INTENT TO DRILL**

Gas Storage Field

Form C-1  
December 2002  
Form must be Typed  
Form must be signed  
All blanks must be Filled

Must be approved by KCC five (5) days prior to commencing well

Expected Spud Date 07/11/05  
month day year

Spot:  East  West  
SW - NW - SE - SW Sec. 9 Twp. 33S R. 42

OPERATOR: License # 5447

1800 feet from  N /  S Line of Section

Name: OXY USA Inc.

330 feet from  E /  W Line of Section

Address: P.O. Box 2528  
City/State/Zip: Liberal, KS 67905

RECEIVED  
APR 28 2005  
KCC WICHITA

Is SECTION X Regular \_\_\_\_\_ Irregular?

Contact Person: Greg Rowe  
Phone: (620) 629-4200

(Note: Locate well on the Section Plat on reverse side)

CONTRACTOR: License # 30606

County: Morton

Name: Murfin Drilling Co., Inc.

Lease Name: Austin A Well #: 4

Field Name: MUSTANG EAST

Well Drilled For: Well Class: Type Equipment:  
 Oil  Enh Rec  Infield  Mud Rotary  
 Gas  Storage  Pool Ext  Air Rotary  
 OWWO  Disposal  Wildcat  Cable  
 Seismic: # of Holes  Other Step Out Well  
 Other

Is this a Prorated / Spaced Field?  Yes  No

Target Formation(s): St. Louis

Nearest Lease or unit Boundary: 330

Ground Surface Elevation: 3505 feet MSL

Water well within one-quarter mile  Yes  No

Public water supply well within one mile:  Yes  No

Depth to bottom of fresh water: 300

Depth to bottom of usable water: 420

Surface Pipe by Alternate:  1  2

Length of Surface Pipe Planned to be set: 1750

Length of Conductor Pipe Required: NONE

Projected Total Depth: 5100

Formation at Total Depth: St. Louis

Water Source for Drilling Operations:  
 Well  Farm Pond Other \_\_\_\_\_

DWR Permit # \_\_\_\_\_

(Note: Apply for Permit with DWR )

Will Cores be Taken?  Yes  No

If Yes, Proposed zone: within Boehm Gas Storage Field

If OWWO: old well information as follows:  
Operator: \_\_\_\_\_  
Well Name: \_\_\_\_\_  
Original Completion Date: \_\_\_\_\_ Original Total Depth: \_\_\_\_\_

Directional, Deviated or Horizontal wellbore?  Yes  No

If Yes, true vertical depth \_\_\_\_\_

Bottom Hole Location \_\_\_\_\_

KCC DKT #: \_\_\_\_\_

\* Prorated & Spaced  
Hugoton & Greenwood Zones

AFFIDAVIT

The undersigned hereby affirms that the drilling, completion and eventual plugging of this well will comply with K.S.A. 55-101 et. Seq. It is agreed that the following minimum requirements will be met:

Gas Storage Area -  
Blowout Preventer Required

1. Notify the appropriate district office prior to spudding of well;
2. A copy of the approved notice of intent to drill shall be posted on each drilling rig;
3. The minimum amount of surface pipe as specified below shall be set by circulating cement to the top; in all cases surface pipe shall be set through all unconsolidated materials plus a minimum of 20 feet into the underlying formation.
4. If the well is dry hole, an agreement between the operator and the district office on plug length and placement is necessary prior to plugging;
5. The appropriate district office will be notified before well is either plugged or production casing is cemented in;
6. If an ALTERNATE II COMPLETION, production pipe shall be cemented from below any usable water to surface within 120 days of spud date. Or pursuant to Appendix "B" - Eastern Kansas surface casing order #133,891-C, which applies to the KCC District 3 area, alternate II cementing must be completed within 30 days of the spud date or the well shall be plugged. In all cases, NOTIFY district office prior to any cementing.

I hereby certify that the statements made herein are true and to the best of my knowledge and belief.

Date: April 26, 2005 Signature of Operator or Agent: Walter Gardner Title: Capital Project

**For KCC Use ONLY**  
API # 15 - 129. 21756.00.00  
Conductor pipe required NONE feet  
Minimum Surface pipe required 440 feet per Alt. ①  
Approved by: RJP 5-25-05  
This authorization expires: 11-25-05  
(This authorization void if drilling not started within 6 months of effective date.)  
Spud date: \_\_\_\_\_ Agent: \_\_\_\_\_

Remember to:  
- File Drill Pit Application (form CDP-1) with Intent to Drill;  
- File Completion Form ACO-1 within 120 days of spud date;  
- File acreage attribution plat according to field proation orders;  
- Notify appropriate district office 48 hours prior to workover or re-entry;  
- Submit plugging report (CP-4) after plugging is completed;  
- Obtain written approval before disposing or injecting salt water.  
- If this permit has expired (see: authorized expiration date) please check the box below and return to the address below.  
 Well Not Drilled - Permit Expired  
Signature of Operator or Agent: \_\_\_\_\_  
Date: \_\_\_\_\_

9  
33  
42W

Mail to: KCC - Conservation Division, 130 S. Market - Room 2078, Wichita, Kansas 67202

**IN ALL CASES PLOT THE INTENDED WELL ON THE PLAT BELOW**

*Plat of acreage attributable to a well in a prorated or spaced field*

**If the intended well is in a prorated or spaced field, please fully complete this side of the form.** If the intended well is in a prorated or spaced field complete the plat below showing that the well will be properly located in relationship to other wells producing from the common source of supply. Please show all the wells and within 1 mile of the boundaries of the proposed acreage attribution unit for gas wells and within 1/2 mile of the boundaries of the proposed acreage attribution unit for oil wells.

API No. 15 - \_\_\_\_\_  
 Operator: \_\_\_\_\_  
 Lease: \_\_\_\_\_  
 Well Number: \_\_\_\_\_  
 Field: \_\_\_\_\_

Location of Well: County \_\_\_\_\_  
 \_\_\_\_\_ feet from  N /  S Line of Section  
 \_\_\_\_\_ feet from  E /  W Line of Section  
 Sec. \_\_\_\_\_ Twp. \_\_\_\_\_ R. \_\_\_\_\_  East  West

Number of Acres attributable to well: \_\_\_\_\_  
 QTR / QTR / QTR of acreage: \_\_\_\_\_ - \_\_\_\_\_ - \_\_\_\_\_

Is Section  Regular or  Irregular

**IF Section is Irregular, locate well from nearest corner boundary.**

Section corner used:  NE  NW  SE  SW

**PLAT**

*(Show location of the well and shade attributable acreage for prorated or spaced wells.)  
 (Show footage to the nearest lease or unit boundary line.)*

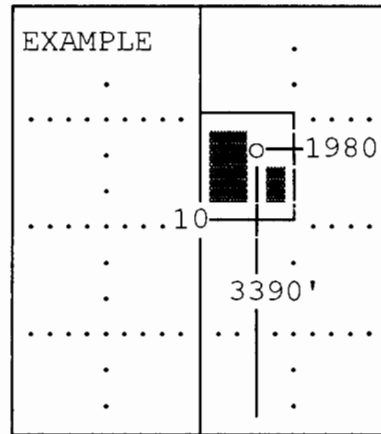
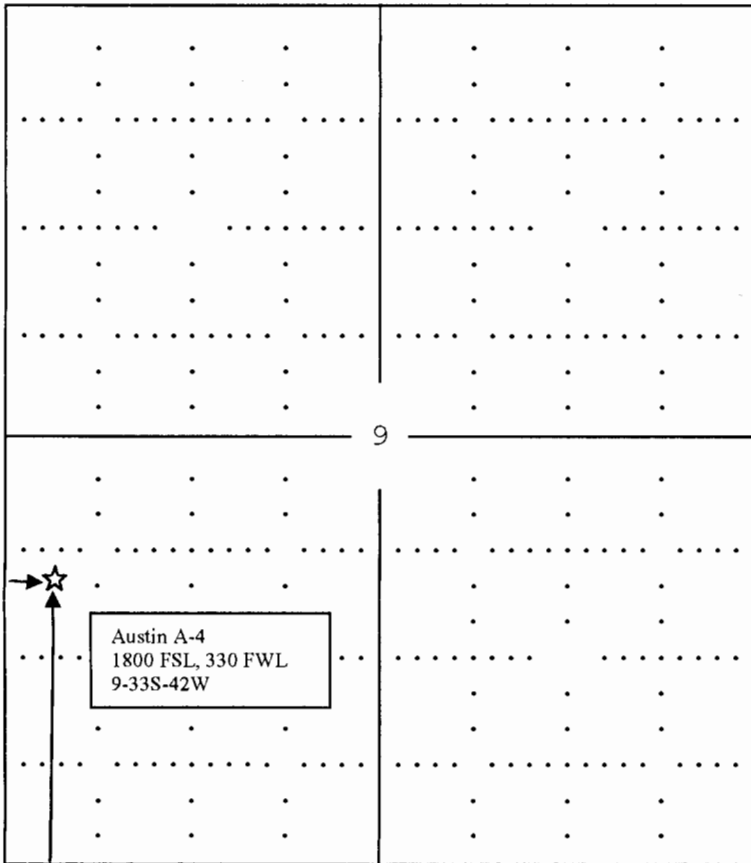

SEWARD CO.

**Note: In all cases locate the spot of the proposed drilling location.**

Morton County

**In plotting the proposed location of the well, you must show:**

1. The manner in which you are using the depicted plat by identifying section lines, i.e. 1 section, 1 section with 8 surrounding sections, 4 sections, etc.
2. The distance of the proposed drilling location from the sections south / north and east / west.
3. The distance to the nearest lease or unit boundary line.
4. If proposed location is located within a prorated or spaced field a certificate of acreage attribution plat must be attached: (CO-7 for oil wells; CG-8 for gas wells).