

**OWWO**  
KANSAS CORPORATION COMMISSION  
OIL & GAS CONSERVATION DIVISION

MAY 13 2005

**NOTICE OF INTENT TO DRILL**

Must be approved by KCC five (5) days prior to commencing well

Form C-1  
December 2002  
Form must be Typed  
Form must be Signed  
All blanks must be Filled

For KCC Use:  
Effective Date: 5-18-05  
District # 1  
SGA?  Yes  No

Expected Spud Date 05 20 2005  
month day year

OPERATOR: License# 32334  
Name: Chesapeake Operating, Inc.  
Address: P. O. Box 18496  
City/State/Zip: Oklahoma City, OK 73154-0496  
Contact Person: Jim Gowens, Barbara Bale  
Phone: (405) 848-8000

CONTRACTOR: License# Wi-1 Advise on ACO-1  
Name: \_\_\_\_\_

Well Drilled For:	Well Class:	Type Equipment:
<input checked="" type="checkbox"/> Oil	<input type="checkbox"/> Enh Rec	<input checked="" type="checkbox"/> Infield
<input type="checkbox"/> Gas	<input type="checkbox"/> Storage	<input type="checkbox"/> Pool Ext.
<input checked="" type="checkbox"/> OWWO	<input type="checkbox"/> Disposal	<input type="checkbox"/> Wildcat
<input type="checkbox"/> Seismic; # of Holes _____	<input type="checkbox"/> Other _____	<input type="checkbox"/> Cable
<input type="checkbox"/> Other _____		

If OWWO: old well information as follows:  
Operator: Chesapeake Operating, Inc.  
Well Name: MLP Anthony A #1-15  
Original Completion Date: 01/17/02 Original Total Depth: 5500'

Directional, Deviated or Horizontal wellbore?  Yes  No  
If Yes, true vertical depth: \_\_\_\_\_  
Bottom Hole Location: \_\_\_\_\_  
KCC DKT #: \_\_\_\_\_

OWWO: Old API #15-081-21435-0000

\* Prorated & Spaced Hugoton & Panoma

**AFFIDAVIT**

The undersigned hereby affirms that the drilling, completion and eventual plugging of this well will comply with K.S.A. 55 et. seq.

It is agreed that the following minimum requirements will be met:

1. Notify the appropriate district office *prior* to spudding of well;
2. A copy of the approved notice of intent to drill *shall be* posted on each drilling rig;
3. The minimum amount of surface pipe as specified below *shall be set* by circulating cement to the top; in all cases surface pipe *shall be set* through all unconsolidated materials plus a minimum of 20 feet into the underlying formation.
4. If the well is dry hole, an agreement between the operator and the district office on plug length and placement is necessary *prior to plugging*;
5. The appropriate district office will be notified before well is either plugged or production casing is cemented in;
6. If an ALTERNATE II COMPLETION, production pipe shall be cemented from below any usable water to surface within **120 days** of spud date. Or pursuant to Appendix "B" - Eastern Kansas surface casing order #133,891-C, which applies to the KCC District 3 area, alternate II cementing must be completed within 30 days of the spud date or the well shall be plugged. **In all cases, NOTIFY district office** prior to any cementing.

I hereby certify that the statements made herein are true and to the best of my knowledge and belief.

Date: 05/12/05 Signature of Operator or Agent: Barbara J. Bale Title: Regulatory Analyst

**For KCC Use ONLY**

API # 15 - 081-21435-00-01  
Conductor pipe required NONE feet  
Minimum surface pipe required 1833' feet per Alt. ①  
Approved by: RJS-13-05  
This authorization expires: 11-13-05  
(This authorization void if drilling not started within 6 months of effective date.)  
Spud date: \_\_\_\_\_ Agent: \_\_\_\_\_

**Remember to:**

- File Drill Pit Application (form CDP-1) with Intent to Drill;
  - File Completion Form ACO-1 within 120 days of spud date;
  - File acreage attribution plat according to field proration orders;
  - Notify appropriate district office 48 hours prior to workover or re-entry;
  - Submit plugging report (CP-4) after plugging is completed;
  - Obtain written approval before disposing or injecting salt water.
- If this permit has expired (See: authorized expiration date) please check the box below and return to the address below.

Well Not Drilled - Permit Expired

Signature of Operator or Agent: \_\_\_\_\_  
Date: \_\_\_\_\_

Mall to: KCC - Conservation Division, 130 S. Market - Room 2078, Wichita, Kansas 67202

15  
29  
34

**IN ALL CASES PLOT THE INTENDED WELL ON THE PLAT BELOW**

*Plat of acreage attributable to a well in a prorated or spaced field*

**If the intended well is in a prorated or spaced field, please fully complete this side of the form.** If the intended well is in a prorated or spaced field complete the plat below showing that the well will be properly located in relationship to other wells producing from the common source of supply. Please show all the wells and within 1 mile of the boundaries of the proposed acreage attribution unit for gas wells and within 1/2 mile of the boundaries of the proposed acreage attribution unit for oil wells.

API No. 15 - \_\_\_\_\_  
 Operator: Chesapeake Operating, Inc.  
 Lease: MLP Anthony "A"  
 Well Number: 1-15R  
 Field: Eubank

Number of Acres attributable to well: 40  
 QTR / QTR / QTR of acreage: \_\_\_\_\_ - NE - SW

Location of Well: County: Haskell  
2160 feet from  N /  S Line of Section  
2310 feet from  E /  W Line of Section  
 Sec. 15 Twp. 29 S. R. 34  East  West

Is Section:  Regular or  Irregular

**If Section is Irregular, locate well from nearest corner boundary.**

Section corner used:  NE  NW  SE  SW

**PLAT**

*(Show location of the well and shade attributable acreage for prorated or spaced wells.)*

*(Show footage to the nearest lease or unit boundary line.)*

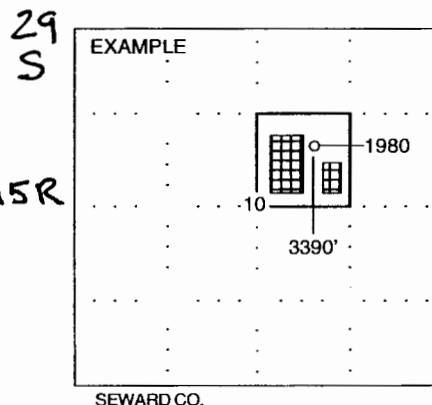
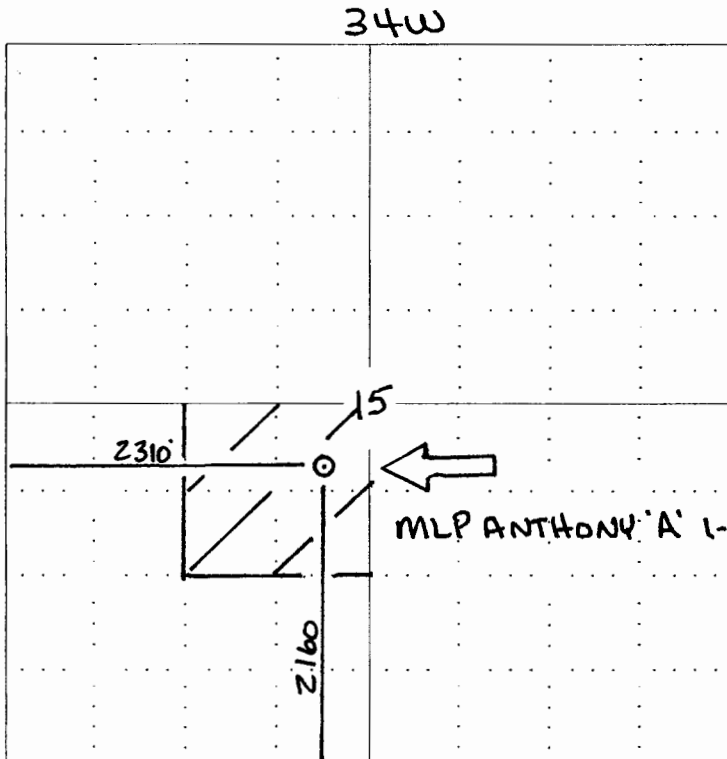

**NOTE: In all cases locate the spot of the proposed drilling location.**

**In plotting the proposed location of the well, you must show:**

1. The manner in which you are using the depicted plat by identifying section lines, i.e. 1 section, 1 section with 8 surrounding sections, 4 sections, etc.
2. The distance of the proposed drilling location from the section's south / north and east / west.
3. The distance to the nearest lease or unit boundary line.
4. If proposed location is located within a prorated or spaced field a certificate of acreage attribution plat must be attached: (CO-7 for oil wells; CG-8 for gas wells).