

KCC DIST. #1

CARD MUST BE TYPED

State of Kansas

CARD MUST BE SIGNED

NOTICE OF INTENTION TO DRILL HUGOTON INFILL

SEA-No

EFFECTIVE DATE 5-30-05

Starting Date MAY 01 2005 month day year

API Number 15- 055-21877-00-00

IS SECTION X REGULAR IRREGULAR

OPERATOR: License # 5952 (6-30-05) Name BP AMERICA PRODUCTION COMPANY Address P. O. BOX 3092, WLL, RM 3.201 City/State/Zip HOUSTON, TX 77253-3092 Contact Person SUE SELLERS Phone (281) 366-2052

NW NW SW Sec 09 Twp 23 S. Rg 33 W W 2310 FSL Ft. from South Line of Section 300 FWL Ft. from East Line of Section

CONTRACTOR License # 33375 Name CHEYENNE DRILLING LP (2-28-06) City/State

Note: Attach acreage attribution plat locating both Chase (Hugoton) wells Total number of acres attributed to unit 640

Well Drilled as: X New Recompletion OWWO Projected Total Depth 2800 feet

Nearest producing well from same common source of supply 2377 feet Nearest lease or unit boundary line 300 feet

Formation If OWWO or Recompletion: old well info as follows: Operator Well Name Comp. Date Old Total Depth

County FINNEY Lease Name MILTON C Well # 2HI Ground surface elevation 2885 feet MSL Depth to bottom of fresh water 340 Depth to bottom of usable water 1150

Surface pipe by Alternate: 1 2 X Surface pipe planned to be set 360 Min. Water Source for Drilled Operations: well farm pond X other DWR Permit #:

I certify that well will comply with K.S.A. 55-101, et seq., plus eventually plugging hole to KCC specifications.

Date APRIL 20, 2005 Signature of Operator or Agent Lou Barry

PERMITTING COORDINATOR

For KCC Use:

Conductor Pipe Required NONE feet; Minimum Surface Pipe Required 360 feet per Alt. + (2) This Authorization Expires 11-25-05 Approved By RJP 5-25-05

9/95

WELL LOCATION EXCEPTION GRANTED 5-19-05

RECEIVED KANSAS CORPORATION COMMISSION

APR 22 2005

Must be filed with K.C.C. five (5) days prior to commencing well This card void if drilling not started within six (6) months of date received by K.C.C.

CONSERVATION DIVISION WICHITA, KS

WILE OS CONS. 248 CWLE

A Regular Section of Land 1 Mile = 5,280 Ft.

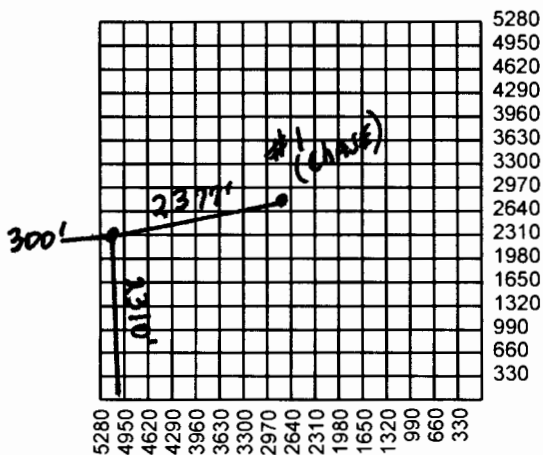

Important procedures to follow:

- 1. Notify District office before setting surface casing.
2. Set surface casing by circulating cement to the top.
3. File completion forms ACO-1 with K.C.C. within 120 days of well spud date, following instructions on ACO-1, side 1, and including copies of wireline logs.
4. Notify District office 48 hours prior to old well workover or re-entry.
5. Submit plugging report (CP-4) to K.C.C. after plugging is completed.
6. If an alternate 2 completion, cement in the production pipe from below any useable water to surface within 120 day of spud date.

State Corporation Commission of Kansas Conservation Division 130 S. Market Room 2078 Wichita, Kansas 67202-1212 (316) 337-6231