

For KCC Use: 5.22.05  
 Effective Date: \_\_\_\_\_  
 District # 4  
 SGA?  Yes  No

KANSAS CORPORATION COMMISSION  
 OIL & GAS CONSERVATION DIVISION  
**NOTICE OF INTENT TO DRILL**

Form C-1  
 December 2002  
**Form must be Typed**  
**Form must be Signed**  
**All blanks must be Filled**

Must be approved by KCC five (5) days prior to commencing well

Expected Spud Date July 1 2005  
month day year

Spot 50' north of \_\_\_\_\_  East  
SE NE NW Sec. 16 Twp. 14 S. R. 20  West  
4340 feet from  N /  S Line of Section  
2970 feet from  E /  W Line of Section  
 Is SECTION  Regular  Irregular?

OPERATOR: License# 5252  
 Name: R.P. Nixon Oper., Inc.  
 Address: 207 West 12th Street  
 City/State/Zip: Hays, KS 67601  
 Contact Person: Dan Nixon  
 Phone: 785-628-3834

CONTRACTOR: License# 5184  
 Name: Shields Oil Producers, Inc.

<b>Well Drilled For:</b>	<b>Well Class:</b>	<b>Type Equipment:</b>
<input checked="" type="checkbox"/> Oil	<input type="checkbox"/> Enh Rec	<input checked="" type="checkbox"/> Infield
<input type="checkbox"/> Gas	<input type="checkbox"/> Storage	<input type="checkbox"/> Pool Ext.
<input type="checkbox"/> OWWO	<input type="checkbox"/> Disposal	<input type="checkbox"/> Wildcat
<input type="checkbox"/> Seismic; _____ # of Holes	<input type="checkbox"/> Other	<input type="checkbox"/> Cable
<input type="checkbox"/> Other		

(Note: Locate well on the Section Plat on reverse side)  
 County: Ellis  
 Lease Name: Neely Well #: 3  
 Field Name: Ed Seibel

Is this a Prorated / Spaced Field?  Yes  No  
 Target Formation(s): L/KC, Reagan Sand  
 Nearest Lease or unit boundary: 330'  
 Ground Surface Elevation: 2180' estimated \_\_\_\_\_ feet MSL  
 Water well within one-quarter mile:  Yes  No  
 Public water supply well within one mile:  Yes  No  
 Depth to bottom of fresh water: 180  
 Depth to bottom of usable water: 720  
 Surface Pipe by Alternate:  1  2

If OWWO: old well information as follows:  
 Operator: \_\_\_\_\_  
 Well Name: \_\_\_\_\_  
 Original Completion Date: \_\_\_\_\_ Original Total Depth: \_\_\_\_\_

Length of Surface Pipe Planned to be set: 200'  
 Length of Conductor Pipe required: none  
 Projected Total Depth: 3840'  
 Formation at Total Depth: Reagan Sand

Directional, Deviated or Horizontal wellbore?  Yes  No

Water Source for Drilling Operations:  
 Well  Farm Pond Other  \_\_\_\_\_  
 DWR Permit #: \_\_\_\_\_

If Yes, true vertical depth: \_\_\_\_\_  
 Bottom Hole Location: \_\_\_\_\_  
 KCC DKT #: \_\_\_\_\_

(Note: Apply for Permit with DWR )  
 Will Cores be taken?  Yes  No  
 If Yes, proposed zone: \_\_\_\_\_

**AFFIDAVIT**

The undersigned hereby affirms that the drilling, completion and eventual plugging of this well will comply with K.S.A. 55 et. seq.  
 It is agreed that the following minimum requirements will be met:

1. Notify the appropriate district office **prior** to spudding of well;
2. A copy of the approved notice of intent to drill **shall be** posted on each drilling rig;
3. The minimum amount of surface pipe as specified below **shall be set** by circulating cement to the top; in all cases surface pipe **shall be set** through all unconsolidated materials plus a minimum of 20 feet into the underlying formation.
4. If the well is dry hole, an agreement between the operator and the district office on plug length and placement is necessary **prior to plugging**;
5. The appropriate district office will be notified before well is either plugged or production casing is cemented in;
6. If an ALTERNATE II COMPLETION, production pipe shall be cemented from below any usable water to surface within **120 days** of spud date.  
 Or pursuant to Appendix "B" - Eastern Kansas surface casing order #133,891-C, which applies to the KCC District 3 area, alternate II cementing must be completed within 30 days of the spud date or the well shall be plugged. **In all cases, NOTIFY district office** prior to any cementing.

RECEIVED  
 MAY 18 2005  
 KCC WICHITA

I hereby certify that the statements made herein are true and to the best of my knowledge and belief.  
 Date: May 13th, 2005 Signature of Operator or Agent: \_\_\_\_\_ Title: President

**Remember to:**

- File Drill Pit Application (form CDP-1) with Intent to Drill;
- File Completion Form ACO-1 within 120 days of spud date;
- File acreage attribution plat according to field proration orders;
- Notify appropriate district office 48 hours prior to workover or re-entry;
- Submit plugging report (CP-4) after plugging is completed;
- Obtain written approval before disposing or injecting salt water.

- If this permit has expired (See: authorized expiration date) please check the box below and return to the address below.  
 Well Not Drilled - Permit Expired  
 Signature of Operator or Agent: \_\_\_\_\_  
 Date: \_\_\_\_\_

**For KCC Use ONLY**  
 API # 15 - 051-25419.00.00  
 Conductor pipe required NONE feet  
 Minimum surface pipe required 200 feet per Alt. + (2)  
 Approved by: RJP S-17-05  
 This authorization expires: 11-17-05  
 (This authorization void if drilling not started within 6 months of effective date.)  
 Spud date: \_\_\_\_\_ Agent: \_\_\_\_\_

Mall to: KCC - Conservation Division, 130 S. Market - Room 2078, Wichita, Kansas 67202

16  
 14  
 2005

**IN ALL CASES PLOT THE INTENDED WELL ON THE PLAT BELOW**

*Plat of acreage attributable to a well in a prorated or spaced field*

**If the intended well is in a prorated or spaced field, please fully complete this side of the form.** If the intended well is in a prorated or spaced field complete the plat below showing that the well will be properly located in relationship to other wells producing from the common source of supply. Please show all the wells and within 1 mile of the boundaries of the proposed acreage attribution unit for gas wells and within 1/2 mile of the boundaries of the proposed acreage attribution unit for oil wells.

API No. 15 - \_\_\_\_\_  
 Operator: R.P. Nixon Oper., Inc.  
 Lease: Neely  
 Well Number: 3  
 Field: Ed Seibel

Location of Well: County: Ellis  
4340 feet from  N /  S Line of Section  
2970 feet from  E /  W Line of Section  
 Sec. 16 Twp. 14 S. R. 20  East  West

Number of Acres attributable to well: \_\_\_\_\_  
 QTR / QTR / QTR of acreage: SE - NE - NW

Is Section:  Regular or  Irregular

**If Section Is Irregular, locate well from nearest corner boundary.**

Section corner used:  NE  NW  SE  SW

**PLAT**

*(Show location of the well and shade attributable acreage for prorated or spaced wells.)  
 (Show footage to the nearest lease or unit boundary line.)*

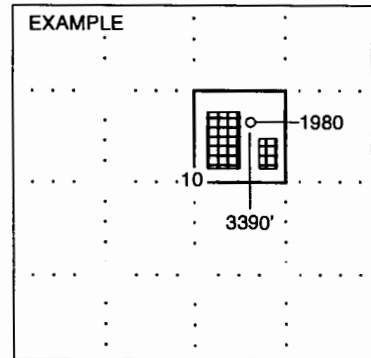
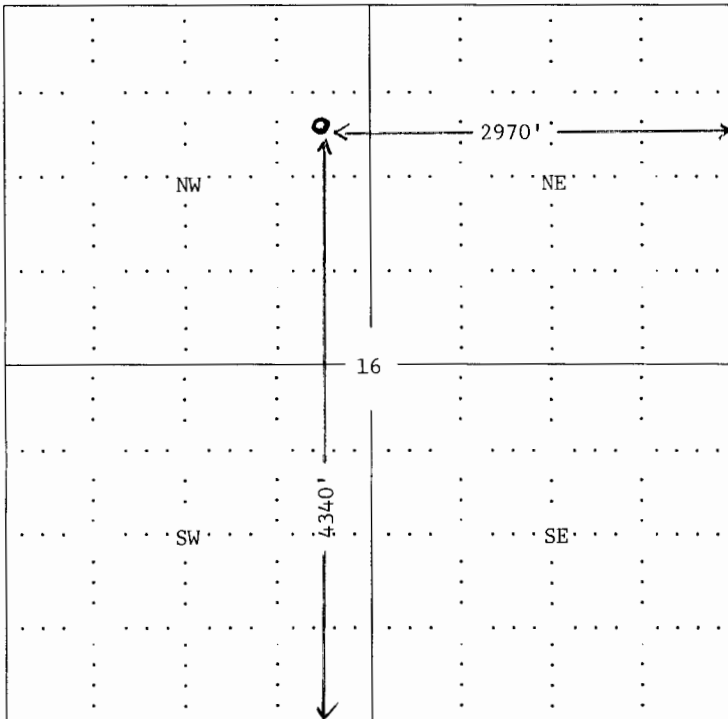

**NOTE: In all cases locate the spot of the proposed drilling locaton.**

**In plotting the proposed location of the well, you must show:**

1. The manner in which you are using the depicted plat by identifying section lines, i.e. 1 section, 1 section with 8 surrounding sections, 4 sections, etc.
2. The distance of the proposed drilling location from the section's south / north and east / west.
3. The distance to the nearest lease or unit boundary line.
4. If proposed location is located within a prorated or spaced field a certificate of acreage attribution plat must be attached: (CO-7 for oil wells; CG-8 for gas wells).

RECEIVED  
 MAY 16 2005  
 KCC WICHITA