

FOR KCC USE:

FORM CB-1 12/93

FORM MUST BE TYPED

FORM MUST BE SIGNED

ALL BLANKS MUST BE FILLED IN

EFFECTIVE DATE: 5-9-2005

State of Kansas

DISTRICT # 1

CATHODIC PROTECTION BOREHOLE INTENT

SGA? Yes No

Must be approved by the K.C.C. sixty (60) days prior to commencing well.

Expected Spud (Starting) Date 5-16-05

Spot (Location) 0/0/0 NE NW SW NW Sec 1 Twp 32S Rg 33W East

OPERATOR: License # 32119 (6:30:05)

..... 3889' feet from South ~~North~~ line of Section
..... 570' feet from ~~East~~ West line of Section

Name: Northern Natural Gas Co.

(Circle directions from nearest outside corner boundaries)

Address: 1111 South 103rd Street

IS SECTION X REGULAR _____ IRREGULAR?

City/State/Zip: Omaha, NE 68013

(Spot well on the Section Plat on Reverse Side)

Contact Person: Duane Moody

County: Seward

Phone: (402) 398-7843

Lease Name: Sublette Station #2

CONTRACTOR: License #: 32775

Facility Name: Sublette Station Well #2

Name: McLean's C.P. Installation, Inc.

Ground Surface Elevation: _____ MSL.
Cathodic Borehole Total Depth 220' ft.
Depth to Bedrock 540' ft.

Type Drilling Equipment: XX Mud Rotary Cable
..... Air Rotary Other

WATER INFORMATION:

CONSTRUCTION FEATURES

Length of Cathodic Surface (Non-Metallic) Casing 20'

Aquifer Penetration: X None Single Multiple

Planned to be set: _____ ft.

Depth to bottom of fresh water: 240' to top 1340'

Length of Conductor pipe (if any?): _____ ft.

Depth to bottom of usable water: 606'

Size of the borehole (I.D.): _____ inches

Water well within one-quarter mile: yes X no

Cathodic surface casing size: _____ inches

Public water supply well within one mile: yes X no

Cathodic surface casing centralizers set at depths of: 20...

Water Source for Drilling Operations:

Cathodic surface casing will terminate at:

.... well farm pond stream X other

... Above surface ... Surface Vault X Below Surface Vault

Water Well Location: _____

Pitless casing adaptor will be used: ... Yes No at Depth _____ ft.

DWR Permit #: _____

Anode installation depths are: 208; 199; 190; 181;

Standard Dimension Ratio (SDR) is = 26

172; 163; 156; 145; 136; 127; 118; 109; 100;

(cathodic surface OD csg. in inches / MWT in inches = SDR)

91 82 73 64 55 46 37

Annular space between borehole and casing will be grouted

X NON-AQUIFER COMPLETION

with: Concrete Bentonite Cement

DO NOT PENETRATE GROUNDWATER

XX Neat cement Bentonite clay

The undersigned hereby affirms that the drilling, completion and eventual plugging of this well will comply with K.S.A. 55-101, et. seq. It is agreed that the following minimum requirements will be met:

Anode vent pipe will be set at: 3 ft. above surface

1. Notify the appropriate district office prior to spudding of and again before plugging well;

Anode conductor (backfill) material TYPE: SC2

2. A copy of the approved notice of intent to drill shall be posted on each drilling rig;

Depth to BASE of Backfill installation material: 220'

3. The minimum amount of cathodic surface casing as specified below shall be set by grouting to the top.

Depth to TOP of Backfill installation material: 25'

4. An agreement between the operator and the district office on plugs and placement is necessary prior to plugging;

BORING MUST BE A MIN. OF 20'

5. The appropriate district office will be notified before well is either plugged or casing is grouted in;

ABOVE TOP OF GROUNDWATER

6. IN ALL CASES, NOTIFY DISTRICT OFFICE PRIOR TO ANY CEMENTING.

MAX TD = 220

I hereby certify that the statements made herein are true and to the best of my knowledge and belief.
Date: 5/2/05 Signature of Operator or Agent: [Signature] Title: Office

FOR KCC USE: 175-21986-000A11-3
 API # 15- _____
 Conductor pipe required NONE feet
 Minimum cathodic surface casing required 20 feet
 Approved by: RJP 5-4-05
 This authorization expires: 11-4-05
 (This authorization void if drilling not started within 6 months of effective date.)
 Spud date: _____ Agent: _____

RECEIVED
 KANSAS CORPORATION COMMISSION
 MAY 03 2005
 CONSERVATION DIVISION
 WICHITA KS

- REMEMBER TO:
- File Drill Pit Application (form CDP-1) with Intent to Install;
 - File Completion Form CB-2 within 30 days of spud date;
 - Notify appropriate district office 48 hours prior to workover or re-entry;
 - Submit plugging report (CB-4) within 30 days after plugging is completed.

Mail to: KCC - Conservation Division, 130 S. Market - Room 2078, Wichita, Kansas 67202-1286.

IN ALL CASES PLOT THE INTENDED WELL ON THE PLAT BELOW

Show the relationship to other wells or facilities proposed to be serviced by the intended cathodic borehole. Please show all the wells, existing cathodic boreholes, pipelines or facilities within 1/2 mile of the proposed borehole.

API NO. 15- _____
 OPERATOR Northern Natural Gas Co. LOCATION OF WELL: COUNTY Seward
 LEASE Sublette Station 3889' feet from South north line of section
 WELL NUMBER #2 570' feet from east West line of section
 FACILITY NAME Sublette Station Well #2 SECTION 1 TWP 32S RG 33W

SPOT: QTR/QTR/QTR/QTR OF ACREAGE _____ IS SECTION X REGULAR or _____ IRREGULAR
 - NW - SW - NW IF SECTION IS IRREGULAR, LOCATE WELL FROM NEAREST CORNER BOUNDARY.
 Section corner used: _____ NE _____ NW _____ SE _____ SW

PLAT

(Show location of intended cathodic borehole.)

(Show footage from nearest lease, unit or outside section boundary line.)

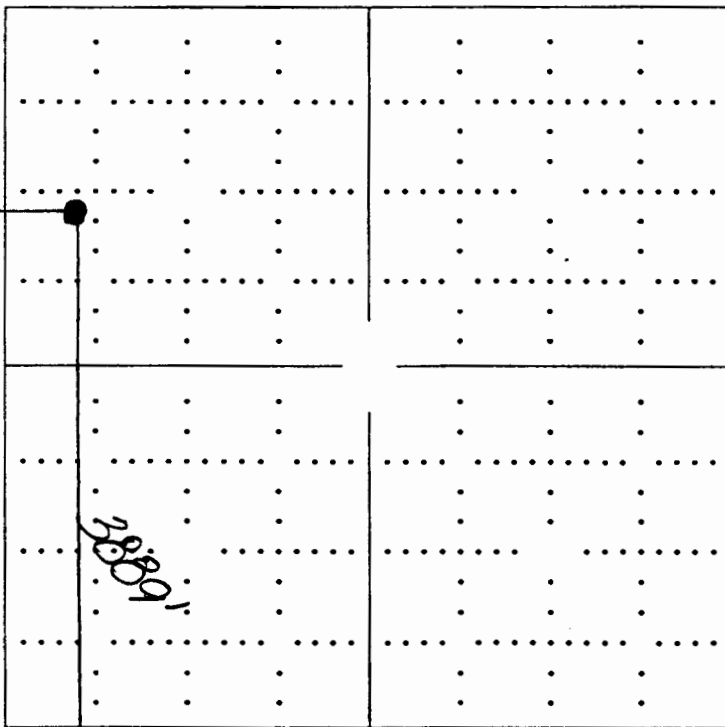

Section 1

RECEIVED
KANSAS CORPORATION COMMISSION

MAY 03 2005

CONSERVATION DIVISION
 WICHITA, KS

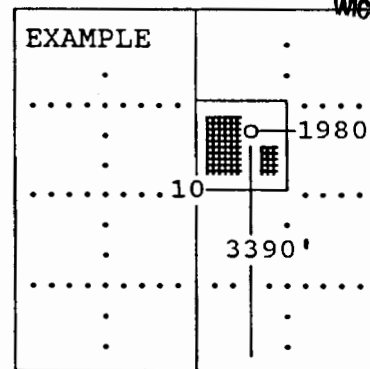

SEWARD CO.

In plotting the proposed location of the well, you must show:

- 1) The manner in which you are using the depicted plat by identifying section lines, i.e. 1 section, 1 section with 8 surrounding sections, 4 sections, etc.;
- 2) the distance of the proposed drilling location from the section's south/north and east/west; and
- 3) the distance to the nearest lease, unit or outside section boundary line.

KANSAS

CORPORATION COMMISSION

KATHLEEN SEBELIUS, GOVERNOR
BRIAN J. MOLINE, CHAIR
ROBERT E. KREHBIEL, COMMISSIONER
MICHAEL C. MOFFET, COMMISSIONER

May 3, 2005

Mr. Duane Moody
Northern Natural Gas Co.
1111 South 103rd St
Omaha, NE 68013

RE: Drilling Pit Application
Sublette Station Lease Well No. 2
NW/4 Sec. 01-32S-33W
Seward County, Kansas

Dear Mr. Moody:

This office has been informed that steel pits are to be used at this location. Please inform the Commission in writing as to which disposal well you will utilize to dispose of the contents in the steel pits and the amount of fluid which will be disposed.

Should a haul-off pit be necessary, please complete the enclosed CDP-1. This location will have to be inspected prior to approval of the haul-off pit application.

Sincerely,

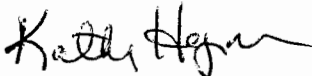

Kathy Haynes
Environmental Protection and Remediation Department

cc: S Durrant