

first
CORRECTED

For KCC Use: 6-7-05
Effective Date: _____
District # _____
SGA? Yes No

**KANSAS CORPORATION COMMISSION
OIL & GAS CONSERVATION DIVISION
NOTICE OF INTENT TO DRILL**
Must be approved by KCC five (5) days prior to commencing well

Form C-1
December 2002
Form must be Typed
Form must be Signed
All blanks must be Filled

Expected Spud Date JUNE 6th 2005
month day year

Spot East
NW/4 NW/4 SE/4 Sec. 10 Twp. 32 S. R. 31 West
2,475 feet from N / S Line of Section
2,475 feet from E / W Line of Section
Is SECTION Regular Irregular?

OPERATOR: License# 33596 (5.3006) **
Name: Unit Petroleum Company
Address: P.O. Box 702500
City/State/Zip: Tulsa, OK 74170
Contact Person: Mike Earnest
Phone: (918)-493-7700

(Note: Locate well on the Section Plat on reverse side)
County: Seward
Lease Name: Reiss Well #: 1
Field Name: Wildcat
Is this a Prorated / Spaced Field? Yes No

CONTRACTOR: License# 5822 (6.3005)
Name: Val Drilling

Well Drilled For: Oil Enh Rec Infield Mud Rotary
 Gas Storage Pool Ext. Air Rotary
 OWWO Disposal Wildcat Cable
Seismic: _____ # of Holes Other

Nearest Lease or unit boundary: 2,475'
Ground Surface Elevation: 2,785' feet MSL
Water well within one-quarter mile: Yes No
Public water supply well within one mile: Yes No
Depth to bottom of fresh water: 580'
Depth to bottom of usable water: 620'
Surface Pipe by Alternate: 1 2
Length of Surface Pipe Planned to be set: 1,500
Length of Conductor Pipe required: None
Projected Total Depth: 6,000
Formation at Total Depth: ST. LOUIS
Water Source for Drilling Operations:
 Well Farm Pond Other _____
DWR Permit #: applying for
(Note: Apply for Permit with DWR)
Will Cores be taken? Yes No
If Yes, proposed zone: _____

If OWWO: old well information as follows:
Operator: _____
Well Name: _____
Original Completion Date: _____ Original Total Depth: _____

Directional, Deviated or Horizontal wellbore? Yes No
If Yes, true vertical depth: _____
Bottom Hole Location: _____
KCC DKT #: _____

*** WRONG TOWNSHIP!**
WAS: 10-33-31W IS: 10-32-31W

AFFIDAVIT ** Prorated if spaced location

The undersigned hereby affirms that the drilling, completion and eventual plugging of this well will comply with K.S.A. 55 et. seq.

It is agreed that the following minimum requirements will be met: ** Unit information received

1. Notify the appropriate district office **prior** to spudding of well;
2. A copy of the approved notice of intent to drill **shall be** posted on each drilling rig;
3. The minimum amount of surface pipe as specified below **shall be set** by circulating cement to the top; in all cases surface pipe **shall be set** through all unconsolidated materials plus a minimum of 20 feet into the underlying formation.
4. If the well is dry hole, an agreement between the operator and the district office on plug length and placement is necessary **prior to plugging**;
5. The appropriate district office will be notified before well is either plugged or production casing is cemented in;
6. If an ALTERNATE II COMPLETION, production pipe shall be cemented from below any usable water to surface within **120 days** of spud date. Or pursuant to Appendix "B" - Eastern Kansas surface casing order #133,891-C, which applies to the KCC District 3 area, alternate II cementing must be completed within 30 days of the spud date or the well shall be plugged. **In all cases, NOTIFY district office** prior to any cementing.

I hereby certify that the statements made herein are true and to the best of my knowledge and belief.

Date: 5/26/05 Signature of Operator or Agent: [Signature] Title: ENGINEER

For KCC Use ONLY
API # 15 - 175-21988-00-00
Conductor pipe required NONE feet
Minimum surface pipe required 640 feet per Alt. 1
Approved by: RJP 6-2-05/RJP 6-13-05
This authorization expires: 12-2-05
(This authorization void if drilling not started within 6 months of effective date.)
Spud date: _____ Agent: _____

Remember to:
- File Drill Pit Application (form CDP-1) with Intent to Drill;
- File Completion Form ACO-1 within 120 days of spud date;
- File acreage attribution plat according to field prorotation orders;
- Notify appropriate district office 48 hours prior to workover or re-entry;
- Submit plugging report (CP-4) after plugging is completed;
- Obtain written approval before disposing or injecting salt water.
- If this permit has expired (See: authorized expiration date) please check the box below and return to the address below.
 Well Not Drilled - Permit Expired
Signature of Operator or Agent: _____
Date: _____

Mail to: KCC - Conservation Division, 130 S. Market - Room 2078, Wichita, Kansas 67202

RECEIVED
KANSAS CORPORATION COMMISSION
JUN 13 2005
CONSERVATION DIVISION
WICHITA, KS

10
32
31W

IN ALL CASES PLOT THE INTENDED WELL ON THE PLAT BELOW

Plat of acreage attributable to a well in a prorated or spaced field

If the intended well is in a prorated or spaced field, please fully complete this side of the form. If the intended well is in a prorated or spaced field complete the plat below showing that the well will be properly located in relationship to other wells producing from the common source of supply. Please show all the wells and within 1 mile of the boundaries of the proposed acreage attribution unit for gas wells and within 1/2 mile of the boundaries of the proposed acreage attribution unit for oil wells.

API No. 15 - _____
 Operator: Unit Petroleum Company
 Lease: Reiss
 Well Number: 1
 Field: Wildcat
 Number of Acres attributable to well: 640
 QTR / QTR / QTR of acreage: NW/4 - NW/4 - SE/4

Location of Well: County: Seward
 _____ 2,475 feet from N / S Line of Section
 _____ 2,475 feet from E / W Line of Section
 Sec. 10 Twp. 32 S. R. 31 East West
 Is Section: Regular or Irregular
If Section is Irregular, locate well from nearest corner boundary.
 Section corner used: NE NW SE SW

PLAT

*(Show location of the well and shade attributable acreage for prorated or spaced wells.)
 (Show footage to the nearest lease or unit boundary line.)*

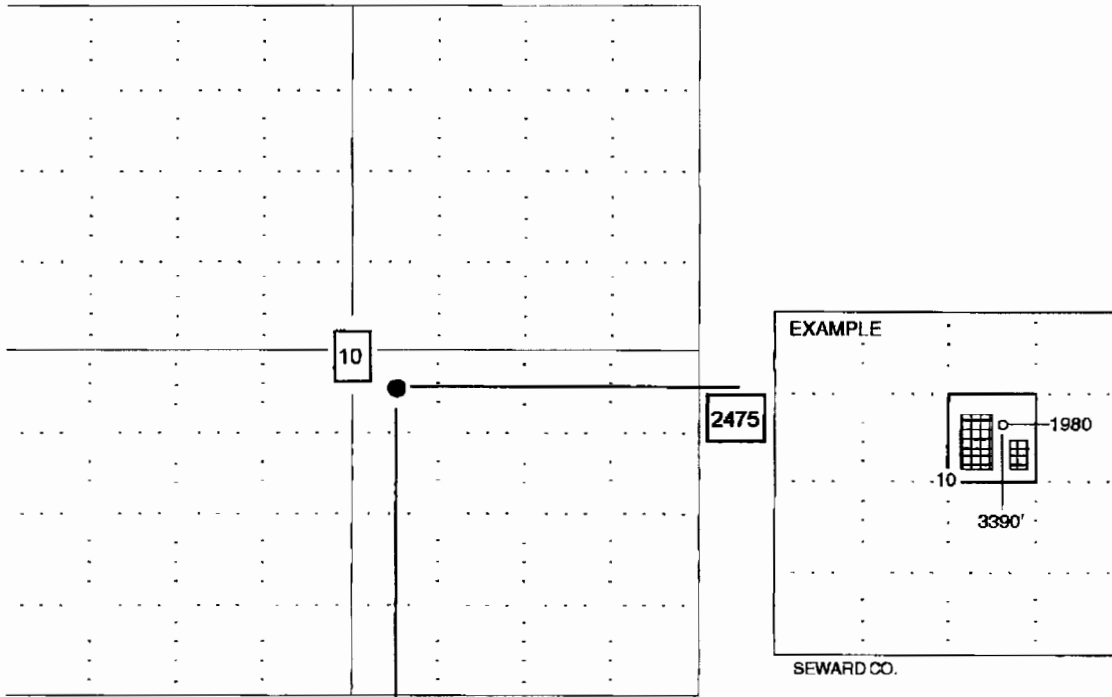

NOTE: In all cases locate the spot of the proposed drilling location.

In plotting the proposed location of the well, you must show:

1. The manner in which you are using the depicted plat by identifying section lines, i.e. 1 section, 1 section with 8 surrounding sections, 4 sections, etc.
2. The distance of the proposed drilling location from the section's south / north and east / west.
3. The distance to the nearest lease or unit boundary line.
4. If proposed location is located within a prorated or spaced field a certificate of acreage attribution plat must be attached: (CO-7 for oil wells; CG-8 for gas wells).

RECEIVED
 OIL & GAS CORPORATION COMMISSION
 JUN 13 2005
 CONSERVATION DIVISION
 WICHITA, KS