

Notice: Fill out COMPLETELY and return to Conservation Division at the address below within 60 days from plugging date.

KANSAS CORPORATION COMMISSION
OIL & GAS CONSERVATION DIVISION
WELL PLUGGING RECORD
K.A.R. 82-3-117

Form CP-4
December 2003
Type or Print on this Form
Form must be Signed
All blanks must be Filled

Lease Operator: Quest Cherokee Oilfield Service, LLC
 Address: 211 W. 14th Street Chanute, KS 66720
 Phone: (620) 431-9500 Operator License #: 33344
 Type of Well: Oil Docket #: _____
 (Oil, Gas D&A, SWD, ENHR, Water Supply Well, Cathodic, Other) (If SWD or ENHR)
 The plugging proposal was approved on: _____ (Date)
 by: _____ (KCC District Agent's Name)
 Is ACO-1 filed? Yes No If not, is well log attached? Yes No
 Producing Formation(s): List All (If needed attach another sheet)
 _____ Depth to Top: _____ Bottom: _____ T.D. _____
 _____ Depth to Top: _____ Bottom: _____ T.D. _____
 _____ Depth to Top: _____ Bottom: _____ T.D. _____

API Number: 15 - 133-21163 -00 - 00
 Lease Name: NeMac
 Well Number: 2
 Spot Location (QQQQ): SW NW-NW
1200 Feet from North / South Section Line
330 4955 Feet from East / West Section Line
 Sec. 36 Twp. 29 S. R. 17 East West
 County: Neosho
 Date Well Completed: 8/1/80
 Plugging Commenced: 5/18/05
 Plugging Completed: 5/18/05

KCC
GEM
6-1-05
RBDMS
CP 2/3

Show depth and thickness of all water, oil and gas formations.

Oil, Gas or Water Records		Casing Record (Surface Conductor & Production)				
Formation	Content	From	To	Size	Put In	Pulled Out
		931'	Surface	2-7/8"		

Describe in detail the manner in which the well is plugged, indicating where the mud fluid was placed and the method or methods used in introducing it into the hole. If cement or other plugs were used, state the character of same depth placed from (bottom), to (top) for each plug set.

Established rate @ 3 bpm @ 100psi, then pumped 25sks cement to lock off perforations and shut in 700psi

Plug and abandon.

RECEIVED
MAY 31 2005

Name of Plugging Contractor: Company Tools Quest Cherokee Oilfield Service, LLC License #: 33344
 Address: 211 W. 14th Street, Chanute, KS 66720

Name of Party Responsible for Plugging Fees: Quest Cherokee Oilfield Service, LLC
 State of Kansas County, Neosho, ss.

Quest Cherokee Oilfield Service, LLC (Employee of Operator) or (Operator) on above-described well, being first duly sworn on oath, says: That I have knowledge of the facts statements, and matters herein contained, and the log of the above-described well is as filed, and the same are true and correct, so help me God.

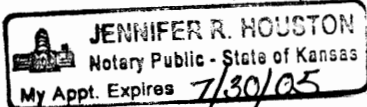

(Signature) _____
 (Address) 211 W. 14th Street, Chanute, KS 66720

SUBSCRIBED and SWORN TO before me this 20th day of May, 2005
Jennifer R. Houston My Commission Expires: July 30, 2005
 Notary Public

Mail to: KCC - Conservation Division, 130 S. Market - Room 2078, Wichita, Kansas 67202

Bv

QUEST

Resource Corporation

211 W. 14TH STREET,
CHANUTE, KS 66720
620-431-9500

TICKET NUMBER 1095

FIELD TICKET REF # _____

FOREMAN Wayne

TREATMENT REPORT & FIELD TICKET CEMENT

DATE	WELL NAME & NUMBER	SECTION	TOWNSHIP	RANGE	COUNTY
5-18-05	Demac # 2	36	29	17	MO

FOREMAN / OPERATOR	TIME IN	TIME OUT	LESS LUNCH	TRUCK #	TRAILER #	TRUCK HOURS	EMPLOYEE SIGNATURE
Wayne	12:45	1:45	NO	903 388		1	<i>[Signature]</i>
Wes	2:45	1:45		" 197		1	<i>[Signature]</i>
Jimmy	12:45	1:45		" 206		1	<i>[Signature]</i>
Daniel	12:45	1:45		" 286		1	<i>[Signature]</i>

JOB TYPE Squeeze Plug HOLE SIZE _____ HOLE DEPTH _____ CASING SIZE & WEIGHT 2 1/2
 CASING DEPTH 955 DRILL PIPE _____ TUBING _____ OTHER _____
 SLURRY WEIGHT _____ SLURRY VOL _____ WATER gal/sk _____ CEMENT LEFT in CASING Full
 DISPLACEMENT 3.5 DISPLACEMENT PSI _____ MIX PSI _____ RATE _____

REMARKS:

Establish Rate 5 BPM 100 PSI Then Pump 25 Sls. Cement to lock off. Hrt's and Shut in 100 PSI

RECEIVED

MAY 31 2005

KCC WICHITA

Plug and Abandon

ACCOUNT CODE	QUANTITY or UNITS	DESCRIPTION OF SERVICES OR PRODUCT	TOTAL AMOUNT
903 388	1	Foreman Pickup	
" 197	1	Cement Pump Truck	
" 206	1	Bulk Truck	
1104	25 Sls.	Portland Cement	
1124		50/50 POZ Blend Cement	
1126		OWC - Blend Cement	
1110		Gilsonite	
1107		Flo-Seal	
1118	1 SK	Premium Gel	
1215A		KCL	
1111B		Sodium Silicate	
1123		City Water	
		Transport Truck	
		Transport Trailer	
903 286	1	80 Vac	

**WELL COMPLETION REPORT AND
DRILLER'S LOG**

API No. 15 — 133 County — 21,163 Number

S. 36 T. 29 R. 17 E
Loc. 330' FWL & 1200' FNL NW

County Neosho

Operator
NeMac, Inc.

Address
Box 247 Thayer, Kansas 66776

Well No. #2 Lease Name NeMac, Inc.

Footage Location
1,200 feet from (N) line 330' feet from (W) line

Principal Contractor Company Tools Geologist None

Spud Date 5-1-80 Date Completed 5-8-80 Total Depth 931 P.B.T.D.

Directional Deviation Oil and/or Gas Purchaser

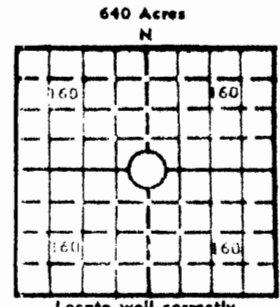

Elev.: Gr. _____

DF _____ KB _____

CASING RECORD

Report of all strings set — surface, intermediate, production, etc.

Purpose of string	Size hole drilled	Size casing set (in O.D.)	Weight lbs/ft.	Setting depth	Type cement	Sacks	Type and percent additives
Oil	5 1/2	2 7/8	New 10 rd	931	Portland	125	2 SX Prem Gal
RECEIVED MAY 3 1 2005 KCC WICHTA							

LINER RECORD

PERFORATION RECORD

Top, ft.	Bottom, ft.	Sacks cement	Shots per ft.	Size & type	Depth interval
			17 Shots	3/8	902 to 910

Size	Setting depth	Packer set at

ACID, FRACTURE, SHOT, CEMENT SQUEEZE RECORD

Amount and kind of material used	Depth interval treated
100 lbs J276 Redifrac Cold Water GE 10 Gal L53 Clay Control 250 lbs J66 Fixafrac Diverting Agnt 80 CWT Sand 20-40 Mesh Bulk 80 CWT Prop Agent Pump.	902 to 910

INITIAL PRODUCTION

Date of first production <u>8-1-80</u>	Producing method (flowing, pumping, gas lift, etc.) <u>Pumping</u>
RATE OF PRODUCTION PER 24 HOURS	Oil <u>2</u> bbls. Gas <u>0</u> MCF Water <u>0</u> bbls. Gas-oil ratio _____ CFPB
Disposition of gas (vented, used on lease or sold)	Producing interval(s)

INSTRUCTIONS: As provided in KCC Rule 82-2-125, within 90 days after completion of a well, one completed copy of this Drillers Log shall be transmitted to the State Geological Survey of Kansas, 4150 Monroe Street, Wichita, Kansas 67209. Copies of this form are available from the Conservation Division, State Corporation Commission, 245 No. Water, Wichita, Kansas 67202. Phone AC 316-522-2206. If confidential custody is desired, please note Rule 82-2-125. Drillers Logs will be on open file in the Oil and Gas Division, State Geological Survey of Kansas, Lawrence, Kansas 66044.

erator

NeMac, Inc.

DESIGNATE TYPE OF COMP.: OIL, GAS, DRY HOLE, SWD

Well No. #2	Lease Name NeMac, Inc.	Oil
S 36 T 29 R 17 E W		

WELL LOG

Show all important zones of porosity and contents thereof; cored intervals, and all drill-stem tests, including depth interval tested, cushion used, time tool open, flowing and shut-in pressures, and recoveries.

SHOW GEOLOGICAL MARKERS, LOGS RUN, OR OTHER DESCRIPTIVE INFORMATION.

FORMATION DESCRIPTION, CONTENTS, ETC.	TOP	BOTTOM	NAME	DEPTH
Soil Clay Sand	0	4		4
Sand Stone	4	20		16
Lime	20	35		15
Shale	35	60		25
Shale	60	85		25
Lime	85	100		15
Shale	100	125		25
Lime	125	200		75
Coal	200	202		2
Shale	202	220		18
Lime	220	255		35
Shale	255	260		5
Lime	260	320		60
Shale	320	370		50
Lime	370	380		10
Shale	380	410		20
Lime	410	435		25
Shale	435	440		5
Sand & Shale	440	540		100
Lime	540	580		40
Shale	580	620		40
Lime	620	650		30
Dark Shale	650	660		10
Shale	660	740		80
Lime	740	760		20
Shale	760	805		45
Dark Shale	805	810		5
Shale	810	895		85
Oil Sand (Show)	895	905		10
Shale & Oil Sand	905	920		15
Shale	920	935		15

KCC WICHITA
MAY 3 1 2005
RECEIVED

USE ADDITIONAL SHEETS, IF NECESSARY, TO COMPLETE WELL RECORD.

Date Received	<p><i>Neal Mules</i></p> <p>Signature</p> <p>President</p> <p>Title</p> <p>October 1, 1980</p> <p>Date</p>
---------------	--