

15-051-20989-00-00

STATE OF KANSAS
STATE CORPORATION COMMISSION
CONSERVATION DIVISION
P. O. BOX 17027
WICHITA, KANSAS 67217

Rev. 6-3-74
FORM CP-1

RECEIVED
STATE CORPORATION COMMISSION

JAN 13 1975
01-13-1975
CONSERVATION DIVISION
Wichita, Kansas

WELL PLUGGING APPLICATION FORM
File One Copy

API Number 15 - 051 - 20,989 - 00-00 (of this well)
Lease Owner Kedco Management Corporation
Address 816 Union Center, Wichita, Kansas 67202
Lease (Farm Name) Richards Well No. 1
Well Location 120'E/NW NE SW Sec. 6 Twp. 11S Rge. 20W (E) (W) X
County Ellis Total Depth 3710' Field Name _____
Oil Well _____ Gas Well _____ Input Well _____ SWD Well _____ Rotary D & A X
Well Log attached with this application as required Yes
Date and hour plugging is desired to begin January 5, 1975 - 11:30 P.M.

PLUGGING OF THIS WELL WILL BE DONE IN ACCORDANCE WITH K.S.A. 55-128 OF THE RULES AND REGULATIONS OF THE STATE CORPORATION COMMISSION.

Name of company representative authorized to be in charge of plugging operations:

_____ Address _____

Plugging Contractor Red Tiger Drilling Company License No. _____

Address 1720 Wichita Plaza, Wichita, Kansas 67202

Invoice covering assessment for plugging this well should be sent to:

Name Kedco Management Corporation

Address 816 Union Center, Wichita, Kansas 67202

and payment will be guaranteed by applicant or acting agent.

KEDCO MANAGEMENT CORPORATION

Signed: H. Marvin Douglas
Applicant or Acting Agent

Date: January 6, 1975

15-051-20989-00-00

DRILLERS LOG

No. 1 Richards

CASING RECORD:

8-5/8" @ 204'
w/160 sx. cmt.

TOTAL DEPTH: 3710'

COMPANY:

Kedco Management Corp.

CONTRACTOR:

Red Tiger Drilling Co.

COMMENCED:

December 28, 1974

COMPLETED:

January 6, 1975

DESCRIPTION:

120'E/NW NE SW
G-115-20W
Ellis County,
Kansas

ELEVATION: 2071' KB

FORMATION

FROM

TO

REMARKS

Post Rock	0	217
Shale	217	1005
Sand	1005	1245
Shale	1245	1520
Anhydrite	1520	1561
Shale	1561	1710
Shale & Lime	1710	2790
Lime & Shale	2790	3075
Lime	3075	3585
Lime & Shale	3585	3679
Lime	3679	3710

RECEIVED
STATE CORPORATION COMMISSION
JAN 13 1975
01/13/1975
CONSERVATION DIVISION
Topeka, Kansas

I certify that this is a true and correct copy of the above log to the best of my knowledge.

RED TIGER DRILLING COMPANY

Linda H. Dickens
Linda H. Dickens

Subscribed and sworn to before me this 9th day of January, 1975.

D. Ann Doremus
Notary Public

My Commission Expires:

December 28, 1977

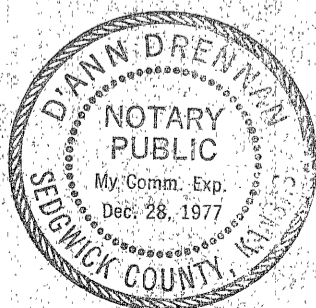

15-051-20989.00-00

RECEIVED
STATE CORPORATION COMMISSION

DEC 24 1975
01-24-1975
CONSERVATION DIVISION
Wichita, Kansas

LAUGHLIN-SIMMONS & CO. OF KANSAS, INC.
OILWELL ELEVATIONS AND LOCATIONS
2121 W. 18TH STREET WICHITA, KANSAS 67203 (316) 943-5351

12-28-74
DATE

Ellis COUNTY 6 S 11 T 20 R 120' East NW NE SW LOCATION

Kedco OPERATOR 1 NO. Richards FARM

ELEVATION: 2068 FT

Mr/ Marvin Douglas
Kedco Management Corporation
816 Union Center
Wichita, Kansas 67202

SCALE: 4" = 1 mile

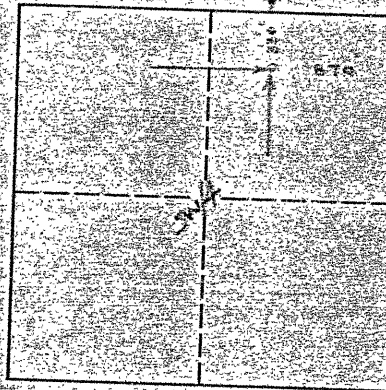

This Log was staked 11-11-74 & alternate also set. Both spot rough locations. Returned 12-6-74 and re-staked as requested. Returned 12-28-74 and re-ran elevation as requested. Also checked spot location is as indicated.

MINIMUM STAKING CHARGE: \$60.00 re-stake
(INCLUDES GROUND ELEVATION)

EXTRA TIME & MILEAGE: _____

ELEVATION CHARGE: \$35.00 return trip to run.

TOTAL: \$95.00

L-S ENGINEER

Laughlin-Simmons & Co. of Kansas, Inc. is not liable in case of errors and/or omissions.

State of Kansas



State Corporation Commission

CONSERVATION DIVISION

(Oil, Gas and Water)

P. O. Box 17027

3830 S. Meridian

WICHITA, KANSAS 67217

January 8, 1975

WELL PLUGGING AUTHORITY

Well No.	1
Lease	Richards
Description	120'E/NW NE SW 6-11-20W
County	Ellis
Total Depth	3700'
Plugging Contractor	Red Tiger Drilling

Kedco Management Corporation
816 Union Center
Wichita, Kansas 67202

Gentlemen:

This is your authority to plug the above subject well in accordance with the Rules and Regulations of the State Corporation Commission.

This authority is void after 90 days from the above date.

Yours very truly,

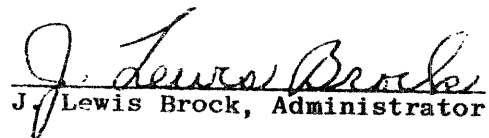
J. Lewis Brock, Administrator

Mr. Leo Massey, P. O. Box 582, Hays, Kansas 67601
is hereby assigned to supervise the plugging of the above named well.