

For KCC Use: 10-2-2001
Effective Date: _____
District # 4
SGA? Yes No

KANSAS CORPORATION COMMISSION
OIL & GAS CONSERVATION DIVISION

NOTICE OF INTENT TO DRILL

Must be approved by KCC five (5) days prior to commencing well

Form C-1
September 1999
Form must be Typed
Form must be Signed
All blanks must be Filled

Expected Spud Date 10 1 2001
month day year

Spot APPROX East
N/2 SE - NE - NW Sec. 6 Twp. 11 S. R. 20 West

OPERATOR: License# 5259
Name: MAT OIL OPERATIONS, INC.
Address: P.O. BOX 33
City/State/Zip: RUSSELL, KS. 67665
Contact Person: ALLEN BANGERT
Phone: 785 483 2169

750 feet from S / (circle one) Line of Section
3000 feet from W (circle one) Line of Section
Is SECTION _____ Regular Irregular?

(Note: Locate well on the Section Plat on reverse side)

CONTRACTOR: License# 30606
Name: MURFIN DRILLING COMPANY

County: ELLIS
Lease Name: RICHARDS Well #: 13
Field Name: MENDOTA

Is this a Prorated / Spaced Field? Yes No

Target Formation(s): ARBUCKLE

Nearest Lease or unit boundary: 750'

Ground Surface Elevation: 2039 feet MSL

Water well within one-quarter mile: Yes No

Public water supply well within one mile: Yes No

Depth to bottom of fresh water: 180'

Depth to bottom of usable water: 750'

Surface Pipe by Alternate: 1 2

Length of Surface Pipe Planned to be set: 200'

Length of Conductor Pipe required: NONE

Projected Total Depth: 3750'

Formation at Total Depth: ARBUCKLE

Water Source for Drilling Operations:

Well _____ Farm Pond _____ Other

DWR Permit #: _____

(Note: Apply for Permit with DWR)

Will Cores be taken? Yes No

If Yes, proposed zone: _____

Well Drilled For: Oil Enh Rec Gas OWO Seismic; # of Holes Other

Well Class: Infield Pool Ext. Wildcat Other

Type Equipment: Mud Rotary Air Rotary Cable

If OWWO: old well information as follows:

Operator: _____

Well Name: _____

Original Completion Date: _____ Original Total Depth: _____

Directional, Deviated or Horizontal wellbore? Yes No

If Yes, true vertical depth: _____

Bottom Hole Location: _____

KCC DKT #: _____

AFFIDAVIT

RECEIVED

The undersigned hereby affirms that the drilling, completion and eventual plugging of this well will comply with K.S.A. 55-101, et. seq. It is agreed that the following minimum requirements will be met:

SEP 26 2001
09-26-2001
KCC WICHITA

1. Notify the appropriate district office **prior** to spudding of well;
2. A copy of the approved notice of intent to drill **shall be** posted on each drilling rig;
3. The minimum amount of surface pipe as specified below **shall be set** by circulating cement to the top; in all cases surface pipe **shall be set** through all unconsolidated materials plus a minimum of 20 feet into the underlying formation.
4. If the well is dry hole, an agreement between the operator and the district office on plug length and placement is necessary **prior to plugging**;
5. The appropriate district office will be notified before well is either plugged or production casing is cemented in;
6. If an ALTERNATE II COMPLETION, production pipe shall be cemented from below any usable water to surface within **120 days** of spud date. **In all cases, NOTIFY district office** prior to any cementing.

I hereby certify that the statements made herein are true and to the best of my knowledge and belief.

Date: 9-25-2001 Signature of Operator or Agent: Allen Bangert Title: PROD. SUPT.

For KCC Use ONLY

API # 15 - 051-25114-0000

Conductor pipe required NONE feet

Minimum surface pipe required 200 feet per Alt. (2)

Approved by: JK 9-27-2001

This authorization expires: 3-27-2002
(This authorization void if drilling not started within 6 months of effective date.)

Spud date: _____ Agent: _____

Remember to:

- File Drill Pit Application (form CDP-1) with Intent to Drill;
- File Completion Form ACO-1 within 120 days of spud date;
- File acreage attribution plat according to field proration orders;
- Notify appropriate district office 48 hours prior to workover or re-entry;
- Submit plugging report (CP-4) after plugging is completed;
- Obtain written approval before disposing or injecting salt water.

Mail to: KCC - Conservation Division, 130 S. Market - Room 2078, Wichita, Kansas 67202

2001

IN ALL CASES PLOT THE INTENDED WELL ON THE PLAT BELOW

Plat of acreage attributable to a well in a prorated or spaced field

If the intended well is in a prorated or spaced field, please fully complete this side of the form. If the intended well is in a prorated or spaced field complete the plat below showing that the well will be properly located in relationship to other wells producing from the common source of supply. Please show all the wells and within 1 mile of the boundaries of the proposed acreage attribution unit for gas wells and within 1/2 mile of the boundaries of the proposed acreage attribution unit for oil wells.

API No. 15 - _____
 Operator: MAI OIL OPERATIONS, INC.
 Lease: RICHARDS
 Well Number: 13
 Field: MENDOTA
 Number of Acres attributable to well: _____
 QTR / QTR / QTR of acreage: _____ - _____ - _____

Location of Well: County: ELLIS
 _____ 750 feet from S (N) (circle one) Line of Section
 _____ 3000 feet from E (W) (circle one) Line of Section
 Sec. 6 Twp. 11 S. R. 20 East West
 Is Section _____ Regular or X Irregular
 If Section is Irregular, locate well from nearest corner boundary.
 Section corner used: X NE ___ NW ___ SE ___ SW

PLAT

*(Show location of the well and shade attributable acreage for prorated or spaced wells.)
 (Show footage to the nearest lease or unit boundary line.)*

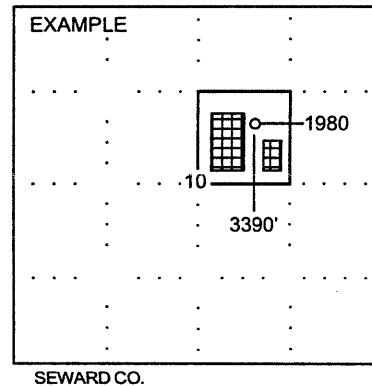
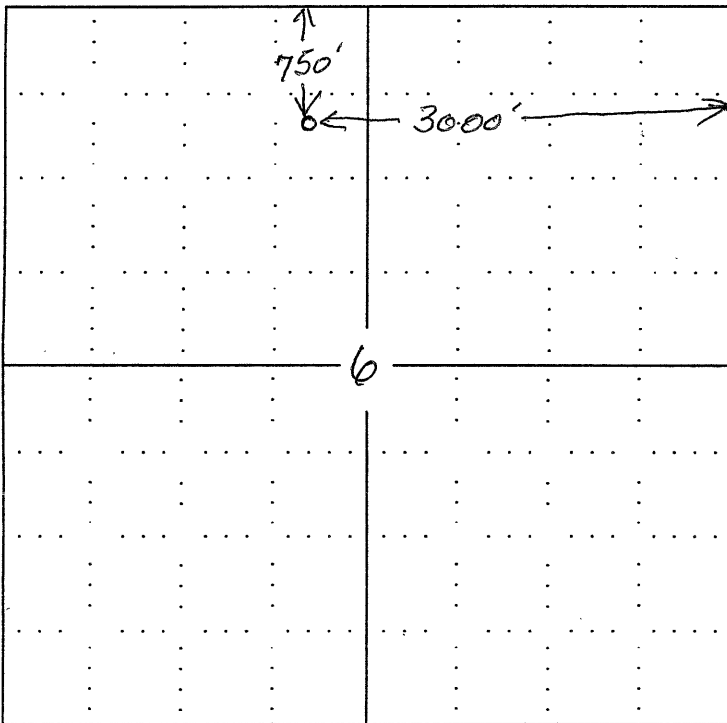

NOTE: In all cases locate the spot of the proposed drilling location.

In plotting the proposed location of the well, you must show:

1. The manner in which you are using the depicted plat by identifying section lines, i.e. 1 section, 1 section with 8 surrounding sections, 4 sections, etc.
2. The distance of the proposed drilling location from the section's south / north and east / west.
3. The distance to the nearest lease or unit boundary line.
4. If proposed location is located within a prorated or spaced field a certificate of acreage attribution plat must be attached: (CO-7 for oil wells; CG-8 for gas wells).