

EFFECTIVE DATE: 7-6-97

State of Kansas

DISTRICT # 4

NOTICE OF INTENTION TO DRILL

SEAT Yes No

Must be approved by the K.C.C. five (5) days prior to commencing well

Spot 70' EAST
NE. NW. NE. Sec 6... Twp 11 S, Rg 20.. X West

Expected Spud Date 7-22-97
month day year

4950 feet from South / North line of Section
1580 feet from East / West line of Section
IS SECTION X REGULAR IRREGULAR?

OPERATOR: License # 5259
Name: MAI OIL OPERATIONS, INC.
Address: P.O. BOX 33
City/State/Zip: RUSSELL, KS. 67665
Contact Person: ALLEN BANGERT
Phone: 913-483-2169

(NOTE: Locate well on the Section Plat on Reverse Side)
County: ELLIS
Lease Name: RICHARDS Well #: 6
Field Name: MENDOTA

CONTRACTOR: License #: 5184
Name: SHIELDS DRILLING CO.

Is this a Prorated/Spaced Field? yes X, no
Target Formation(s): ARBUCKLE
Nearest lease or unit boundary: 330'

Well Drilled For: Well Class: Type Equipment:
X Oil ... Enh Rec X Infield X Mud Rotary
... Gas ... Storage ... Pool Ext. ... Air Rotary
... OUVO ... Disposal ... Wildcat ... Cable
... Seismic; ... # of Holes ... Other

Ground Surface Elevation: 2082' feet MSL
Water well within one-quarter mile: yes X, no
Public water supply well within one mile: yes X, no

If OUVO: old well information as follows:
Operator:
Well Name:
Comp. Date: Old Total Depth

Depth to bottom of fresh water: 700' 180'
Depth to bottom of usable water: 950' 750' BASE OF DAKOTA
Surface Pipe by Alternate: 1 X 2
Length of Surface Pipe Planned to be set: 200'

Directional, Deviated or Horizontal wellbore? yes X, no
If yes, true vertical depth:
Bottom Hole Location:

Length of Conductor pipe required: NONE
Projected Total Depth: 3710'
Formation at Total Depth: ARBUCKLE
Water Source for Drilling Operations: well farm pond X, other

AFFIDAVIT

The undersigned hereby affirms that the drilling, completion and eventual plugging of this well will comply with K.S.A. 55-101, et. seq.
It is agreed that the following minimum requirements will be met:

- 1. Notify the appropriate district office prior to spudding of well;
2. A copy of the approved notice of intent to drill shall be posted on each drilling rig;
3. The minimum amount of surface pipe as specified below shall be set by circulating cement to the top; in all cases surface pipe shall be set through all unconsolidated materials plus a minimum of 20 feet into the underlying formation;
4. If the well is dry hole, an agreement between the operator and the district office on plug length and placement is necessary prior to plugging;
5. The appropriate district office will be notified before well is either plugged or production casing is cemented in;
6. IF AN ALTERNATE II COMPLETION, PRODUCTION PIPE SHALL BE CEMENTED FROM BELOW ANY USABLE WATER TO SURFACE WITHIN 120 DAYS OF SPUD DATE. IN ALL CASES, NOTIFY DISTRICT OFFICE PRIOR TO ANY CEMENTING.

I hereby certify that the statements made herein are true and to the best of my knowledge and belief.

Date: 6-26-97 Signature of Operator or Agent: Allen Bangert Title: PROD. SUPT.

FOR KCC USE:
API # 15- 051-249710000
Conductor pipe required NONE feet
Minimum surface pipe required 200' feet per Alt. X(2)
Approved by: JK 7-1-97
This authorization expires: 1-1-98
(This authorization void if drilling not started within 6 months of effective date.)
Spud date: Agent:

REMEMBER TO:

- File Drill Pit Application (form GDP-1) with Intent to Drill;
- File Completion Form ACO-1 within 120 days of spud date;
- File acreage attribution plat according to field proration orders;
- Notify appropriate district office 48 hours prior to workover or re-entry;
- Submit plugging report (CP-4) after plugging is completed;
- Obtain written approval before disposing or injecting salt water.

Mail to: Conservation Division, 200 Colorado Derby Building, 202 W. First St., Wichita, Kansas 67202-1286.

RECEIVED
MAY 20 1997
JUN 30, 1997
6
11
2000

IN ALL CASES PLOT THE INTENDED WELL ON THE PLAT BELOW

PLAT OF ACREAGE ATTRIBUTABLE TO A WELL IN A PRORATED OR SPACED FIELD

If the intended well is in a prorated or spaced field, please fully complete this side of the form. If the intended well is in a prorated or spaced field complete the plat below showing that the well will be properly located in relationship to other wells producing from the common source of supply. Please show all the wells within 1 mile of the boundaries of the proposed acreage attribution unit for gas wells and within 1/2 mile of the boundaries of the proposed acreage attribution unit for oil wells.

API NO. 15- \_\_\_\_\_  
OPERATOR \_\_\_\_\_  
LEASE \_\_\_\_\_  
WELL NUMBER \_\_\_\_\_  
FIELD \_\_\_\_\_

LOCATION OF WELL: COUNTY \_\_\_\_\_  
\_\_\_\_\_ feet from south/north line of section  
\_\_\_\_\_ feet from east/west line of section  
SECTION \_\_\_\_\_ TWP \_\_\_\_\_ RG \_\_\_\_\_

NUMBER OF ACRES ATTRIBUTABLE TO WELL \_\_\_\_\_  
QTR/QTR/QTR OF ACREAGE \_\_\_\_\_

IS SECTION \_\_\_\_\_ REGULAR or \_\_\_\_\_ IRREGULAR  
IF SECTION IS IRREGULAR, LOCATE WELL FROM NEAREST  
CORNER BOUNDARY.

Section corner used: \_\_\_\_\_ NE \_\_\_\_\_ NW \_\_\_\_\_ SE \_\_\_\_\_ SW

PLAT

(Show location of the well and shade attributable acreage for prorated or spaced wells.)  
(Show footage to the nearest lease or unit boundary line.)

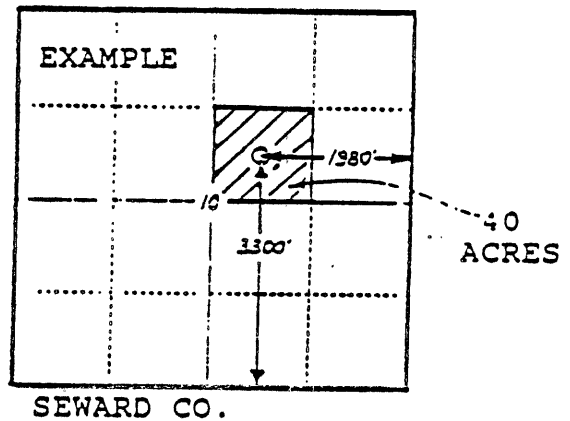
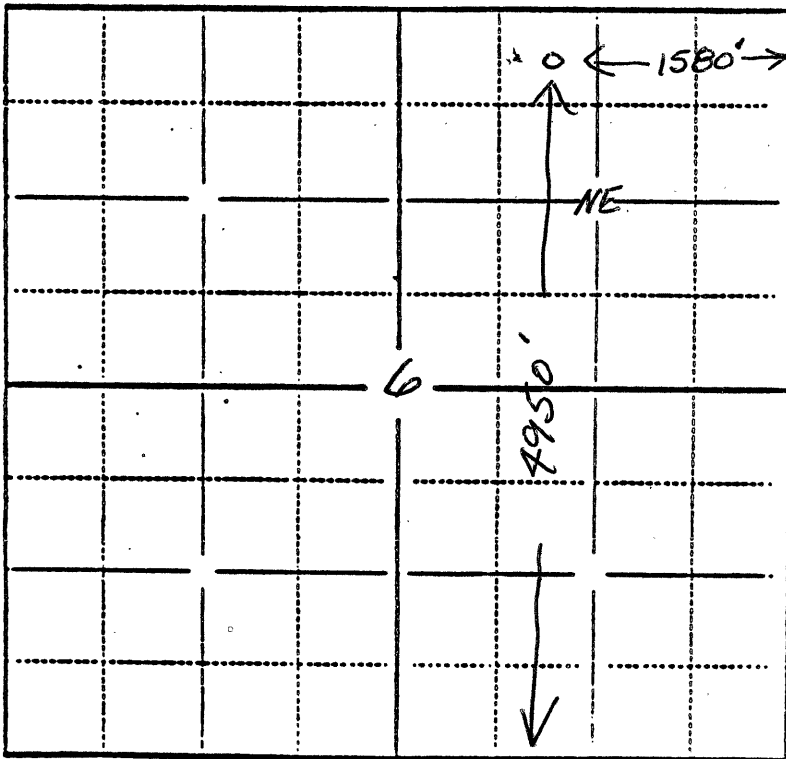

In plotting the proposed location of the well, you must show:

- 1) The manner in which you are using the depicted plat by identifying section lines, i.e. 1 section, 1 section with 8 surrounding sections, 4 sections, etc.;
- 2) the distance of the proposed drilling location from the section's south/north and east/west lines; and
- 3) the distance to the nearest lease or unit boundary line.