

For KCC Use: 6-25-05
Effective Date: 1
District # 1
SGA? ☐ Yes ☒ No

KANSAS CORPORATION COMMISSION
OIL & GAS CONSERVATION DIVISION
NOTICE OF INTENT TO DRILL
Must be approved by KCC five (5) days prior to commencing well

Form C-1
December 2002
Form must be Typed
Form must be Signed
All blanks must be Filled

Expected Spud Date July 07, 2005
month day year

OPERATOR: License# 5316
Name: Falcon Exploration, Inc.
Address: 155 N. Market, Suite 1020
City/State/Zip: Wichita, KS 67202
Contact Person: Ron Schraeder / Mike Mitchell
Phone: 316-262-1378

CONTRACTOR: License# KLN 5822
Name: Val Energy, Inc.

Well Drilled For: ☒ Oil ☐ Enh Rec ☒ Infield ☒ Mud Rotary
☒ Gas ☐ Storage ☐ Pool Ext. ☐ Air Rotary
☒ OWO ☐ Disposal ☐ Wildcat ☐ Cable
☐ Seismic; # of Holes ☐ Other
☐ Other

If OWO: old well information as follows:
Operator: Benson-McCown & Co.
Well Name: Robert Giles #1
Original Completion Date: 12/29/92 Original Total Depth: 5300

Directional, Deviated or Horizontal wellbore? ☐ Yes ☒ No

If Yes, true vertical depth: _____

Bottom Hole Location: _____

KCC DKT #: _____

Spot E/2 SE NW NE Sec. 12 Twp. 31 S. R. 22 ☐ East ☒ West
4260 feet from ☐ N / ☒ S Line of Section
1420 feet from ☒ E / ☐ W Line of Section

Is SECTION _____ Regular _____ Irregular?

(Note: Locate well on the Section Plat on reverse side)

County: Clark
Lease Name: Decker Well #: 3 OWWO
Field Name: Lexington NW

Is this a Prorated / Spaced Field? ☐ Yes ☒ No

Target Formation(s): MRW, Mississippi, Viola

Nearest Lease or unit boundary: 1020'

Ground Surface Elevation: 2210 KB; 2205 GL feet MSL

Water well within one-quarter mile: ☐ Yes ☒ No

Public water supply well within one mile: ☐ Yes ☒ No

Depth to bottom of fresh water: 180

Depth to bottom of usable water: 200'

Surface Pipe by Alternate: ☒ 1 ☐ 2

Length of Surface Pipe ~~Planned to be set:~~ 679'

Length of Conductor Pipe required: ~~NA~~ NONE

Projected Total Depth: 6300'

Formation at Total Depth: Viola

Water Source for Drilling Operations:

☐ Well ☐ Farm Pond Other X

DWR Permit #: _____

(Note: Apply for Permit with DWR ☐)

Will Cores be taken? ☐ Yes ☒ No

If Yes, proposed zone: _____

AFFIDAVIT

The undersigned hereby affirms that the drilling, completion and eventual plugging of this well will comply with K.S.A. 55 et. seq.

It is agreed that the following minimum requirements will be met:

1. Notify the appropriate district office **prior** to spudding of well;
2. A copy of the approved notice of intent to drill **shall be** posted on each drilling rig;
3. The minimum amount of surface pipe as specified below **shall be set** by circulating cement to the top; in all cases surface pipe **shall be set** through all unconsolidated materials plus a minimum of 20 feet into the underlying formation.
4. If the well is dry hole, an agreement between the operator and the district office on plug length and placement is necessary **prior to plugging**;
5. The appropriate district office will be notified before well is either plugged or production casing is cemented in;
6. If an ALTERNATE II COMPLETION, production pipe shall be cemented from below any usable water to surface within **120 days** of spud date. Or pursuant to Appendix "B" - Eastern Kansas surface casing order #133,891-C, which applies to the KCC District 3 area, alternate II cementing must be completed within 30 days of the spud date or the well shall be plugged. **In all cases, NOTIFY district office** prior to any cementing.

I hereby certify that the statements made herein are true and to the best of my knowledge and belief.

Date: 06/14/05 Signature of Operator or Agent: Ronald Schraeder Title: Engineer

For KCC Use ONLY

API # 15 - 025-21090-00-01

Conductor pipe required NONE feet

Minimum surface pipe required 679 set feet per Alt. ①

Approved by: RJP 6-20-05

This authorization expires: 12-20-05

(This authorization void if drilling not started within 6 months of effective date.)

Spud date: _____ Agent: _____

Remember to:

- File Drill Pit Application (form CDP-1) with Intent to Drill;
 - File Completion Form ACO-1 within 120 days of spud date;
 - File acreage attribution plat according to field proration orders;
 - Notify appropriate district office 48 hours prior to workover or re-entry;
 - Submit plugging report (CP-4) after plugging is completed;
 - Obtain written approval before disposing or injecting salt water.
- If this permit has expired (See: authorized expiration date) please check the box below and return to the address below.

☐ Well Not Drilled - Permit Expired

Signature of Operator or Agent: _____

Date: _____

Mail to: KCC - Conservation Division, 130 S. Market - Room 2078, Wichita, Kansas 67202

RECEIVED

JUN 15 2005

KCC WICHITA

IN ALL CASES PLOT THE INTENDED WELL ON THE PLAT BELOW*Plat of acreage attributable to a well in a prorated or spaced field*

If the intended well is in a prorated or spaced field, please fully complete this side of the form. If the intended well is in a prorated or spaced field complete the plat below showing that the well will be properly located in relationship to other wells producing from the common source of supply. Please show all the wells and within 1 mile of the boundaries of the proposed acreage attribution unit for gas wells and within 1/2 mile of the boundaries of the proposed acreage attribution unit for oil wells.

API No. 15 - _____
 Operator: Falcon Exploration, Inc.
 Lease: Decker
 Well Number: 3 OWWO
 Field: Lexington NW
 Number of Acres attributable to well: 680
 QTR / QTR / QTR of acreage: E/2 - SE NW - NE

Location of Well: County: Clark
4260 feet from ☐ N / ☒ S Line of Section
1420 feet from ☒ E / ☐ W Line of Section
 Sec. 12 Twp. 31 S. R. 22 ☐ East ☒ West

Is Section: ☐ Regular or ☐ Irregular

If Section Is Irregular, locate well from nearest corner boundary.

Section corner used: ☐ NE ☐ NW ☐ SE ☐ SW

PLAT

(Show location of the well and shade attributable acreage for prorated or spaced wells.)

(Show footage to the nearest lease or unit boundary line.)

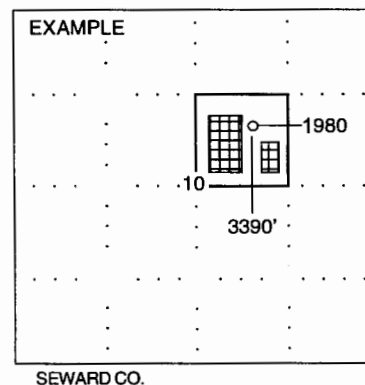
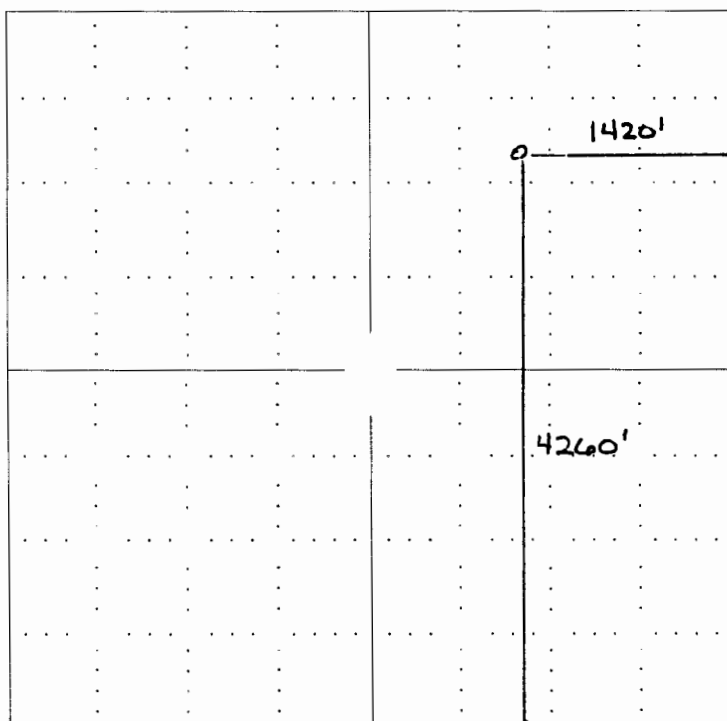

NOTE: In all cases locate the spot of the proposed drilling location.

In plotting the proposed location of the well, you must show:

1. The manner in which you are using the depicted plat by identifying section lines, i.e. 1 section, 1 section with 8 surrounding sections, 4 sections, etc.
2. The distance of the proposed drilling location from the section's south / north and east / west.
3. The distance to the nearest lease or unit boundary line.
4. If proposed location is located within a prorated or spaced field a certificate of acreage attribution plat must be attached: (CO-7 for oil wells; CG-8 for gas wells).

RECEIVED

JUN 15 2005

KCC WICHITA

KANSAS

CORPORATION COMMISSION

KATHLEEN SEBELIUS, GOVERNOR

BRIAN J. MOLINE, CHAIR

ROBERT E. KREHBIEL, COMMISSIONER

MICHAEL C. MOFFET, COMMISSIONER

June 17, 2005

Mr. Ron Schraeder
Falcon Exploration, Inc.
155 N. Market Ste 1020
Wichita, KS 67202

RE: Drilling Pit Application
Decker Lease Well No. 3 OWWO
NE/4 Sec. 12-31S-22W
Clark County, Kansas

Dear Mr. Schraeder:

District staff has inspected the above referenced location and has determined that the reserve pit shall be constructed **without slots**, the bottom shall be flat and reasonably level, and the free fluids must be removed. The fluids are to be removed from the reserve pit as soon as the Hutchinson Salt section has been drilled through and displacement of the fluids into the reserve pit has occurred. The fluids should be removed again as soon as practical after drilling operations have ceased.

If production casing is set all completion fluids shall be removed on a daily basis.

The fluids should be taken to an authorized disposal well. Please call the District Office at (620) 225-8888 when the fluids have been removed. Also please file the enclosed CDP-5 form, Surface Pond Waste Transfer, within 30 days of fluid removal.

A copy of this letter should be posted in the doghouse along with the approved Intent to Drill.

If you have any questions or concerns please feel free to contact the undersigned at the above address.

Sincerely,



Kathy Haynes
Environmental Protection and Remediation Department

cc: S Durrant