

For KCC Use: Effective Date: 6-18-05
District #: 4
SGA? Yes No

KANSAS CORPORATION COMMISSION
OIL & GAS CONSERVATION DIVISION
NOTICE OF INTENT TO DRILL

Must be approved by the K.C.C. five (5) days prior to commencing well

Form C-1
December 2002
Form must be Typed
Form must be Signed
All blanks must be Filled

Expected Spud Date JUNE 17 2005
month day year

Spot 120' N & 180' E OF CENTER East
C - W/2 - NE Sec. 11 Twp. 16 S. R. 11 West

OPERATOR: License # 3882
Name: SAMUEL GARY JR. & ASSOCIATES, INC.
Address: 1670 BROADWAY, SUITE 3300
City/State/Zip: DENVER, CO 80202
Contact Person: TOM FERTAL
Phone: (303) 831-4673

feet from N / S Line of Section
1200
feet from E / W Line of Section
1800
Is SECTION X Regular Irregular?

(Note: Locate well on the Section Plat on Reverse Side)

CONTRACTOR: License 33323
Name: PETROMARK DRILLING

County: BARTON
Lease Name: HOUSKA Well #: 1-11
Field Name: WILDCAT

Is this a Prorated / Spaced Field? Yes No

Target Formation(s): ARBUCKLE

Nearest Lease or unit boundary: 1200'

Ground Surface Elevation: EST 1800' feet MSL

Water well within one-quarter mile: Yes No

Public water supply well within one mile: Yes No

Depth to bottom of fresh water: 180

Depth to bottom of usable water: 360

Surface Pipe by Alternate: 1 2

Length of Surface Pipe Planned to be set: 420'

Length of Conductor pipe required: NONE

Projected Total Depth: 3500'

Formation at Total Depth: ARBUCKLE

Water Source for Drilling Operations:

Well Farm Pond Other X

DWR Permit #: N/A

(Note: Apply for Permit with DWR)

Will Cores Be Taken? Yes No

If yes, proposed zone: N/A

Well Drilled For: Oil Gas OWWO Seismic; # of Holes Other
 Enh Rec Storage Disposal
Well Class: Infield Pool Ext. Wildcat Other
Type Equipment: Mud Rotary Air Rotary Cable

If OWWO: old well information as follows:
Operator: _____
Well Name: _____
Original Completion Date: _____ Original Total Depth: _____

Directional, Deviated or Horizontal wellbore? Yes No
If yes, true vertical depth: _____
Bottom Hole Location: _____
KCC DKT#: _____

AFFIDAVIT

The undersigned hereby affirms that the drilling, completion and eventual plugging of this well will comply with K.S.A. 55-101, et. seq.
It is agreed that the following minimum requirements will be met:

1. Notify the appropriate district office **prior** to spudding of well;
2. A copy of the approved Notice of Intent to Drill **shall be posted** on each drilling rig;
3. The minimum amount of surface pipe as specified below **shall be set** by circulating cement to the top; in all cases surface pipe **shall be set** through all unconsolidated materials plus a minimum of 20 feet into the underlying formation;
4. If the well is a dry hole, an agreement between the operator and the district office on plug length and placement is necessary **prior to plugging**;
5. The appropriate district office will be notified before well is either plugged or production casing is cemented in;
6. If an ALTERNATE II COMPLETION, production pipe shall be cemented from below any usable water to surface within **120 days** of spud date.
Or pursuant to Appendix "B" - Eastern Kansas surface casing order #133,891-C, which applies to the KCC District 3 area, alternate II cementing must be completed within 30 days of spud date or the well shall be plugged. **In all cases, NOTIFY district office** prior to any cementing.

I hereby certify that the statements made herein are true and to the best of my knowledge and belief.

Date: June 9, 2005 Signature of Operator or Agent: Thomas H Fertal Title: SR. GEOLOGIST

Remember to:

- File Drill Pit Application (Form CDP-1) with Intent to Drill;
- File Completion Form ACO-1 within 120 days of spud date;
- File acreage attribution plat according to field proration orders;
- Notify appropriate district office 48 hours prior to workover or re-entry;
- Submit plugging report (CP-4) after plugging is completed;
- Obtain written approval before disposing or injecting salt water.
- If this permit has expired (See: authorized expiration date) please check the box below and return to the address below.

Well Not Drilled - Permit Expired

Signature of Operator or Agent: _____

Date: _____

11
16
11/3

For KCC use ONLY
API # 15 - 009-24848 0000
Conductor pipe required NONE feet
Minimum surface pipe required 380 feet per Alt. ①
Approved by RJPLG-13-05
This authorization expires: 12-13-05
(This authorization void if drilling not started within 6 months of effective date.)
Spud date: _____ Agent: _____

Mail to: KCC - Conservation Division 130 S. Market - Room 2078, Wichita, Kansas 67202

RECEIVED
KANSAS CORPORATION COMMISSION

IN ALL CASES PLOT THE INTENDED WELL ON THE PLAT BELOW JUN 13 2005

Plat of Acreage attributable to a well in a prorated or spaced field

CONSERVATION DIVISION
WICHITA, KS

If the intended well is in a prorated or spaced field, please fully complete this side of the form. If the intended well is in a prorated or spaced field complete the plat below showing that the well will be properly located in relationship to other wells producing from the common source of supply. Please show all the wells and within 1 mile of the boundaries of the proposed acreage attribution unit for gas wells and within 1/2 mile of the boundaries of the proposed acreage attribution unit for oil wells.

API No. 15 - _____
Operator: SAMUEL GARY JR & ASSOCIATES, INC.
Lease: HOUSKA
Well Number: 1-11
Field: WILDCAT

Location of Well: County: BARTON
1200 feet from N / S Line of Section
1800 feet from E / W Line of Section
Sec. 11 Twp. 16 S. R. 11 East West

Is Section: Regular or Irregular

Number of Acres attributable to well: _____

If Section is Irregular, locate well from nearest corner boundary.

QTR / QTR / QTR of acreage: _____ - _____ - _____

Section corner used: NE NW SE SW

PLAT

*(Show location of the well and shade attributable acreage for prorated or spaced wells.)
(Show footage to the nearest lease or unit boundary line.)*

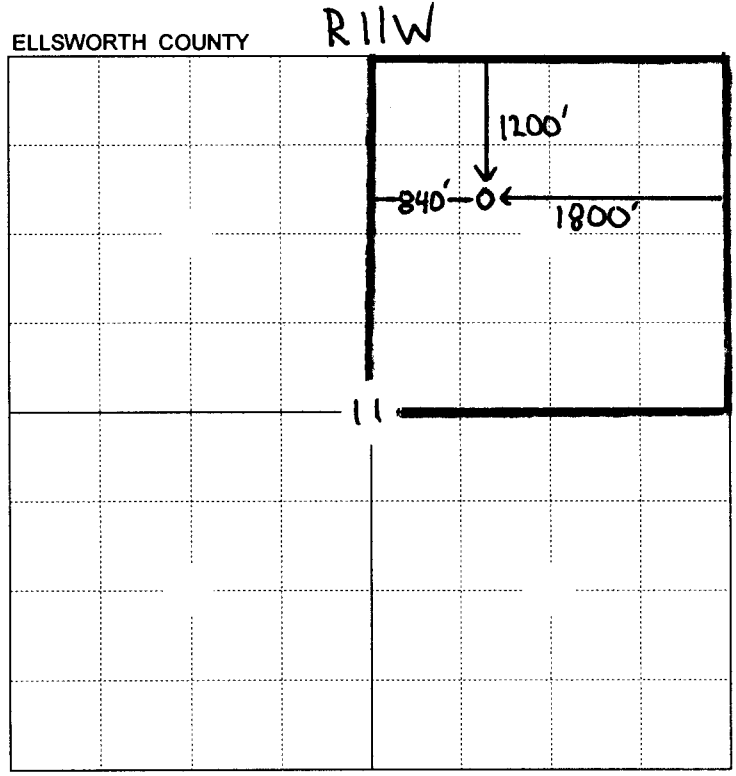

*840' from nearest
lease boundary.*

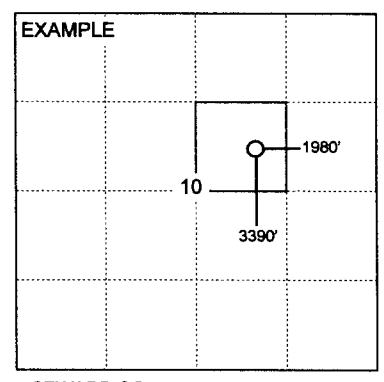

NOTE: In all cases locate the spot of the proposed drilling location.

In plotting the proposed location of the well, you must show:

1. The manner in which you are using the depicted plat by identifying section lines, i.e. 1 section, 1 section with 8 surrounding sections, 4 sections, etc.
2. The distance of the proposed drilling location from the section's south / north and east / west.
3. The distance to the nearest lease or unit boundary line.
4. If proposed location is located within a prorated or spaced field a certificate of acreage attribution plat must be attached: (CO-7 for oil wells; CG-8 for gas wells).