

CARD MUST BE TYPED

State of Kansas  
NOTICE OF INTENTION TO DRILL  
HUGOTON INFILL

CARD MUST BE SIGNED  
SGA-NO

EFFECTIVE DATE 6-8-05

Starting Date MAY 01 2005 API Number 15- 055-21878-00-00  
month day year IS SECTION X REGULAR IRREGULAR

OPERATOR: License # 5952  
Name BP AMERICA PRODUCTION COMPANY  
Address P. O. BOX 3092, WL1, RM 3.201  
City/State/Zip HOUSTON, TX 77253-3092  
Contact Person SUE SELLERS  
Phone (281) 366-2052

Ap-Nw-NE NE SE Sec 03 Twp 23 S. Rg 33 W W  
2500 FSL Ft. from South Line of Section  
500 FEL Ft. from East Line of Section

CONTRACTOR License # 5382  
Name CHEYENNE DRILLING  
City/State

Note: Attach acreage attribution plat locating both Chase (Hugoton) wells  
Total number of acres attributed to unit 640

Well Drilled as: X New Recompletion OWWO  
Projected Total Depth 2800 feet  
Formation

Nearest producing well from  
same common source of supply 2399 feet  
Nearest lease or unit boundary line 500 feet

If OWWO or Recompletion: old well info as follows:  
Operator  
Well Name  
Comp. Date Old Total Depth

County FINNEY  
Lease Name MEYER J. J. Well # 3HI  
Ground surface elevation 2871 feet MSL  
Depth to bottom of fresh water 300'  
Depth to bottom of usable water 1140'  
Surface pipe by Alternate: 1 - 2 X  
Surface pipe planned to be set 320'  
Water Source for Drilled Operations:  
DWR Permit #: well farm pond X other

I certify that well will comply with K.S.A. 55-101, et seq., plus eventually plugging hole to KCC specifications.  
Date April 22, 2005 Signature of Operator or Agent Lou Barry Title PERMITTING COORDINATOR

For KCC Use:  
Conductor Pipe Required NONE feet; Minimum Surface Pipe Required 320' feet per Alt. X2  
This Authorization Expires 12-305 Approved By DPW 6-3-05

WLF, DKT#05-CONS-250-CWLE

9/95

RECEIVED  
KANSAS CORPORATION COMMISSION

Must be filed with K.C.C. five (5) days prior to commencing well  
This card void if drilling not started within six (6) months of date received by K.C.C.

APR 25 2005

CONSERVATION DIVISION  
WICHITA, KS

A Regular Section of Land  
1 Mile = 5,280 Ft.

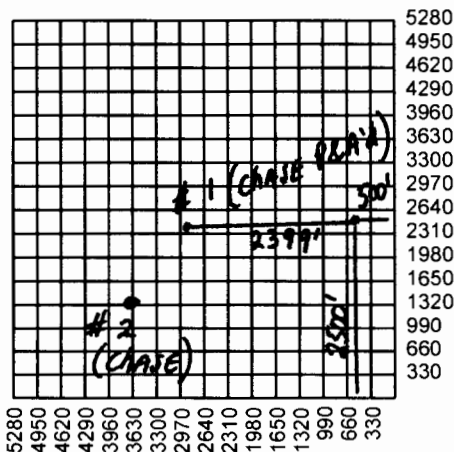

- Important procedures to follow:
1. Notify District office before setting surface casing.
  2. Set surface casing by circulating cement to the top.
  3. File completion forms ACO-1 with K.C.C. within 120 days of well spud date, following instructions on ACO-1, side 1, and including copies of wireline logs.
  4. Notify District office 48 hours prior to old well workover or re-entry.
  5. Submit plugging report (CP-4) to K.C.C. after plugging is completed.
  6. If an alternate 2 completion, cement in the production pipe from below any useable water to surface within 120 day of spud date.

State Corporation Commission of Kansas  
Conservation Division  
130 S. Market Room 2078  
Wichita, Kansas 67202-1212  
(316) 337-6231