

For KCC Use:

Effective Date: \_\_\_\_\_

District # \_\_\_\_\_

SGA?  Yes  No

6.5-05  
3

# KANSAS CORPORATION COMMISSION OIL & GAS CONSERVATION DIVISION

Form C-1

September 1999

Form must be Typed

Form must be Signed

All blanks must be Filled

## NOTICE OF INTENT TO DRILL

Must be approved by KCC five (5) days prior to commencing well

Expected Spud Date June 1 2005  
month day year

Spot S/2-SW SE Sec. 33 Twp. 30 S. R. 16  East  West  
330 feet from S / N (circle one) Line of Section  
1978 feet from E / W (circle one) Line of Section

Is SECTION  Regular  Irregular?

(Note: Locate well on the Section Plat on reverse side)

County: Wilson

Lease Name: Small AX&P Well #: 15-33

Field Name: Neodesha

Is this a Prorated / Spaced Field?  Yes  No

Target Formation(s): Cherokee Coals

Nearest Lease or unit boundary: 330

Ground Surface Elevation: 783 feet MSL

Water well within one-quarter mile:  Yes  No

Public water supply well within one mile:  Yes  No

Depth to bottom of fresh water: 150'

Depth to bottom of usable water: 200'

Surface Pipe by Alternate: 1  2

Length of Surface Pipe Planned to be set: 20'

Length of Conductor Pipe required: None

Projected Total Depth: 1200 Feet

Formation at Total Depth: Mississippian

Water Source for Drilling Operations:

Well  Farm Pond  Other

DWR Permit #: \_\_\_\_\_

(Note: Apply for Permit with DWR )

Will Cores be taken?  Yes  No

If Yes, proposed zone: \_\_\_\_\_

OPERATOR: License# 33365  
Name: Layne Energy Operating, LLC  
Address: 1900 Shawnee Mission Parkway  
City/State/Zip: Mission Woods, KS 66205  
Contact Person: Victor H. Dyal  
Phone: 913-748-3987

CONTRACTOR: License# 5675  
Name: McPherson

Well Drilled For:	Well Class:	Type Equipment:
<input type="checkbox"/> Oil	<input type="checkbox"/> Enh Rec	<input checked="" type="checkbox"/> Infield
<input checked="" type="checkbox"/> Gas	<input type="checkbox"/> Storage	<input type="checkbox"/> Pool Ext.
<input type="checkbox"/> OWWO	<input type="checkbox"/> Disposal	<input checked="" type="checkbox"/> Air Rotary
<input type="checkbox"/> Seismic; # of Holes	<input type="checkbox"/> Other	<input type="checkbox"/> Cable
<input type="checkbox"/> Other		

If OWWO: old well information as follows:

Operator: \_\_\_\_\_

Well Name: \_\_\_\_\_

Original Completion Date: \_\_\_\_\_ Original Total Depth: \_\_\_\_\_

Directional, Deviated or Horizontal wellbore?  Yes  No

If Yes, true vertical depth: \_\_\_\_\_

Bottom Hole Location: \_\_\_\_\_

KCC DKT #: \_\_\_\_\_

RECEIVED  
KANSAS CORPORATION COMMISSION  
MAY 31 2005

CONSERVATION DIVISION  
WICHITA, KS

### AFFIDAVIT

The undersigned hereby affirms that the drilling, completion and eventual plugging of this well will comply with K.S.A. 55-101, et. seq.

It is agreed that the following minimum requirements will be met:

1. Notify the appropriate district office **prior** to spudding of well;
2. A copy of the approved notice of intent to drill **shall be** posted on each drilling rig;
3. The minimum amount of surface pipe as specified below **shall be set** by circulating cement to the top; in all cases surface pipe **shall be set** through all unconsolidated materials plus a minimum of 20 feet into the underlying formation.
4. If the well is dry hole, an agreement between the operator and the district office on plug length and placement is necessary **prior to plugging**;
5. The appropriate district office will be notified before well is either plugged or production casing is cemented in;
6. If an ALTERNATE II COMPLETION, production pipe shall be cemented from below any usable water to surface within **120 days** of spud date. **In all cases, NOTIFY district office** prior to any cementing.

I hereby certify that the statements made herein are true and to the best of my knowledge and belief.

Date: May 27, 2005 Signature of Operator or Agent: [Signature] Title: Agent

**For KCC Use ONLY**

API # 15 - 205 - 26087.0000

Conductor pipe required None feet

Minimum surface pipe required 20 feet per Alt. (2)

Approved by: RJS-31-05

This authorization expires: 11-31-05  
(This authorization void if drilling not started within 6 months of effective date.)

Spud date: \_\_\_\_\_ Agent: \_\_\_\_\_

#### Remember to:

- File Drill Pit Application (form CDP-1) with Intent to Drill;
- File Completion Form ACO-1 within 120 days of spud date;
- File acreage attribution plat according to field proration orders;
- Notify appropriate district office 48 hours prior to workover or re-entry;
- Submit plugging report (CP-4) after plugging is completed;
- Obtain written approval before disposing or injecting salt water.

Mail to: KCC - Conservation Division, 130 S. Market - Room 2078, Wichita, Kansas 67202

33  
30  
163

**IN ALL CASES PLOT THE INTENDED WELL ON THE PLAT BELOW**

*Plat of acreage attributable to a well in a prorated or spaced field*

**If the intended well is in a prorated or spaced field, please fully complete this side of the form.** If the intended well is in a prorated or spaced field complete the plat below showing that the well will be properly located in relationship to other wells producing from the common source of supply. Please show all the wells and within 1 mile of the boundaries of the proposed acreage attribution unit for gas wells and within 1/2 mile of the boundaries of the proposed acreage attribution unit for oil wells.

API No. 15 - \_\_\_\_\_  
Operator: Layne Energy Operating, LLC  
Lease: Small AX&P  
Well Number: 15-33  
Field: Neodesha

Location of Well: County: Montgomery  
330 feet from  / N (circle one) Line of Section  
1978 feet from  / W (circle one) Line of Section  
Sec. 33 Twp. 30 S. R. 16  East  West

Number of Acres attributable to well: \_\_\_\_\_  
QTR / QTR / QTR of acreage: \_\_\_\_\_ - SW \_\_\_\_\_ - SE

Is Section  Regular or \_\_\_\_\_ Irregular

**If Section is Irregular, locate well from nearest corner boundary.**

Section corner used: \_\_\_ NE \_\_\_ NW \_\_\_ SE \_\_\_ SW

**PLAT**

*(Show location of the well and shade attributable acreage for prorated or spaced wells.)  
(Show footage to the nearest lease or unit boundary line.)*

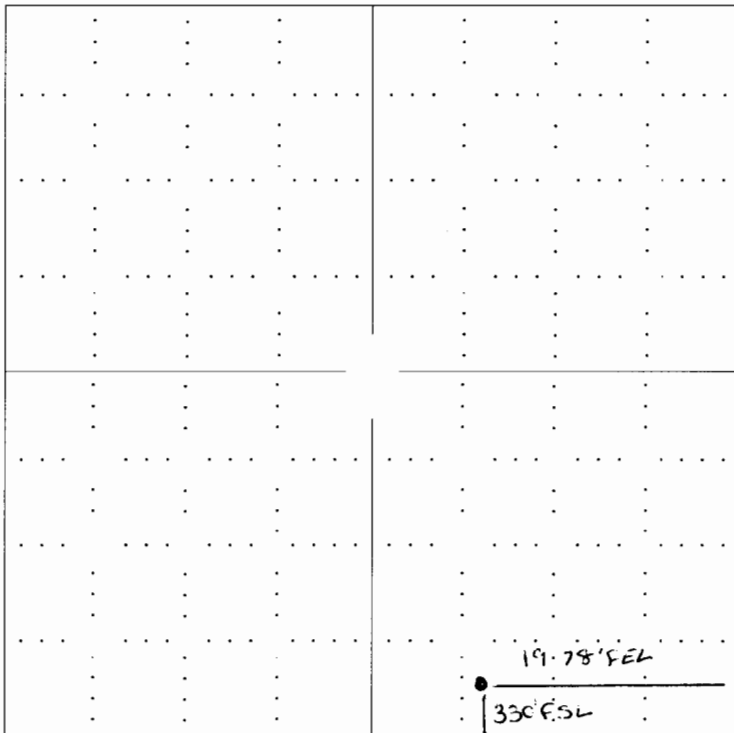

RECEIVED  
KANSAS CORPORATION COMMISSION  
MAY 31 2005  
CONSERVATION DIVISION  
WICHITA KS

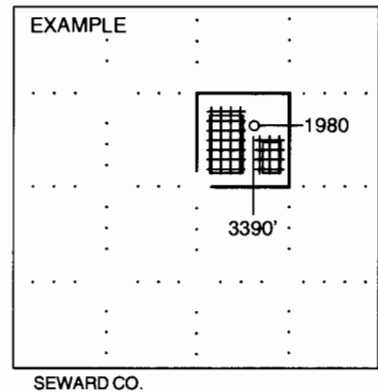

**NOTE: In all cases locate the spot of the proposed drilling location.**

**In plotting the proposed location of the well, you must show:**

1. The manner in which you are using the depicted plat by identifying section lines, i.e. 1 section, 1 section with 8 surrounding sections, 4 sections, etc.
2. The distance of the proposed drilling location from the section's south / north and east / west.
3. The distance to the nearest lease or unit boundary line.
4. If proposed location is located within a prorated or spaced field a certificate of acreage attribution plat must be attached: (CO-7 for oil wells; CG-8 for gas wells).