

OWWO

For KCC Use: Effective Date: 6.6.05 District # 1 SGA?  Yes  No

KANSAS CORPORATION COMMISSION OIL & GAS CONSERVATION DIVISION NOTICE OF INTENT TO DRILL

Form C-1 December 2002 Form must be Typed Form must be Signed All blanks must be Filled

Must be approved by KCC five (5) days prior to commencing well

Expected Spud Date 6 15 2005 month day year

Spot Nw - Nw - Nw Sec. 35 Twp. 23 S. R. 18 East West  East  West 420 feet from  N /  S Line of Section 330 feet from  E /  W Line of Section

OPERATOR: License# 3911 Name: Rama Operating Co., Inc. Address: P.O. Box 159 City/State/Zip: Stafford, KS. 67578 Contact Person: Robin Austin Phone: (620) 234-5191 CONTRACTOR: License# 7023 Name: Klima Well Service

Is SECTION  Regular  Irregular?

(Note: Locate well on the Section Plat on reverse side)

County: Pawnee Lease Name: Spence "A" "OWWO" Well #: 2 Field Name: Gatterman

Is this a Prorated / Spaced Field?  Yes  No

Target Information(s): Lansing-Kansas City

Nearest Lease or unit boundary: 420

Ground Surface Elevation: 2106 feet MSL

Water well within one-quarter mile:  Yes  No

Public water supply well within one mile:  Yes  No

Depth to bottom of fresh water: 150

Depth to bottom of usable water: 230 Kilon

Surface Pipe by Alternate:  1  2

Length of Surface Pipe ~~Planned to be set~~: 323 in place

Length of Conductor Pipe required: None

Projected Total Depth: 4160

Formation at Total Depth: Lansing-Kansas City

Water Source for Drilling Operations:  Well  Farm Pond Other Haul

DWR Permit #: \_\_\_\_\_

(Note: Apply for Permit with DWR )

Will Cores be taken?  Yes  No

If Yes, proposed zone: \_\_\_\_\_

AFFIDAVIT

The undersigned hereby affirms that the drilling, completion and eventual plugging of this well will comply with K.S.A. 55 et. seq. it is agreed that the following minimum requirements will be met:

- 1. Notify the appropriate district office prior to spudding of well;
2. A copy of the approved notice of intent to drill shall be posted on each drilling rig;
3. The minimum amount of surface pipe as specified below shall be set by circulating cement to the top;
4. If the well is dry hole, an agreement between the operator and the district office on plug length and placement is necessary prior to plugging;
5. The appropriate district office will be notified before well is either plugged or production casing is cemented in;
6. If an ALTERNATE II COMPLETION, production pipe shall be cemented from below any usable water to surface within 120 days of spud date.

I hereby certify that the statements made herein are true and to the best of my knowledge and belief.

Date: 5-26-05 Signature of Operator or Agent: \_\_\_\_\_ Title: Vice-president

For KCC Use ONLY. API # 15 - 145-20684.00-01 Conductor pipe required NONE feet Minimum surface pipe required 323 feet per Alt. 1 Approved by: RJPG-1.05 This authorization expires: 12.1.05 Spud date: \_\_\_\_\_ Agent: \_\_\_\_\_

Remember to:

- File Drill Pit Application (form CDP-1) with Intent to Drill;
- File Completion Form ACO-1 within 120 days of spud date;
- File acreage attribution plat according to field proration orders;
- Notify appropriate district office 48 hours prior to workover or re-entry;
- Submit plugging report (CP-4) after plugging is completed;
- Obtain written approval before disposing or injecting salt water.

If this permit has expired (See: authorized expiration date) please check the box below and return to the address below. Well Not Drilled - Permit Expired Signature of Operator or Agent: \_\_\_\_\_ Date: \_\_\_\_\_

Mail to: KCC - Conservation Division, 130 S. Market - Room 2078, Wichita, Kansas 67202

RECEIVED

MAY 31 2005

KCC WICHITA

35 23 182

**IN ALL CASES PLOT THE INTENDED WELL ON THE PLAT BELOW**

*Plat of acreage attributable to a well in a prorated or spaced field*

**If the intended well is in a prorated or spaced field, please fully complete this side of the form.** If the intended well is in a prorated or spaced field complete the plat below showing that the well will be properly located in relationship to other wells producing from the common source of supply. Please show all the wells and within 1 mile of the boundaries of the proposed acreage attribution unit for gas wells and within 1/2 mile of the boundaries of the proposed acreage attribution unit for oil wells.

API No. 15 - \_\_\_\_\_  
 Operator: Rama Operating Co., Inc. \_\_\_\_\_  
 Lease: Spence "A" "OWWO" \_\_\_\_\_  
 Well Number: 2 \_\_\_\_\_  
 Field: Gatterman \_\_\_\_\_

Number of Acres attributable to well: 160 \_\_\_\_\_  
 QTR / QTR / QTR of acreage: Nw - Nw - Nw \_\_\_\_\_

Location of Well: County: Pawnee \_\_\_\_\_  
 420 feet from  N /  S Line of Section  
 330 feet from  E /  W Line of Section  
 Sec. 35 Twp. 23 S. R. 18  East  West

Is Section:  Regular or  Irregular

**If Section is Irregular, locate well from nearest corner boundary.**

Section corner used:  NE  NW  SE  SW

**PLAT**

*(Show location of the well and shade attributable acreage for prorated or spaced wells.)*

*(Show footage to the nearest lease or unit boundary line.)*

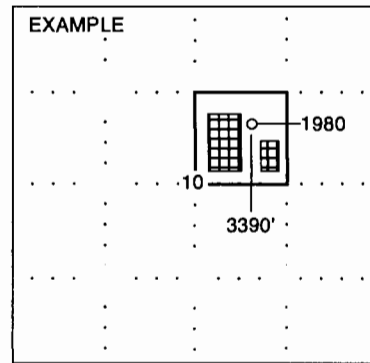
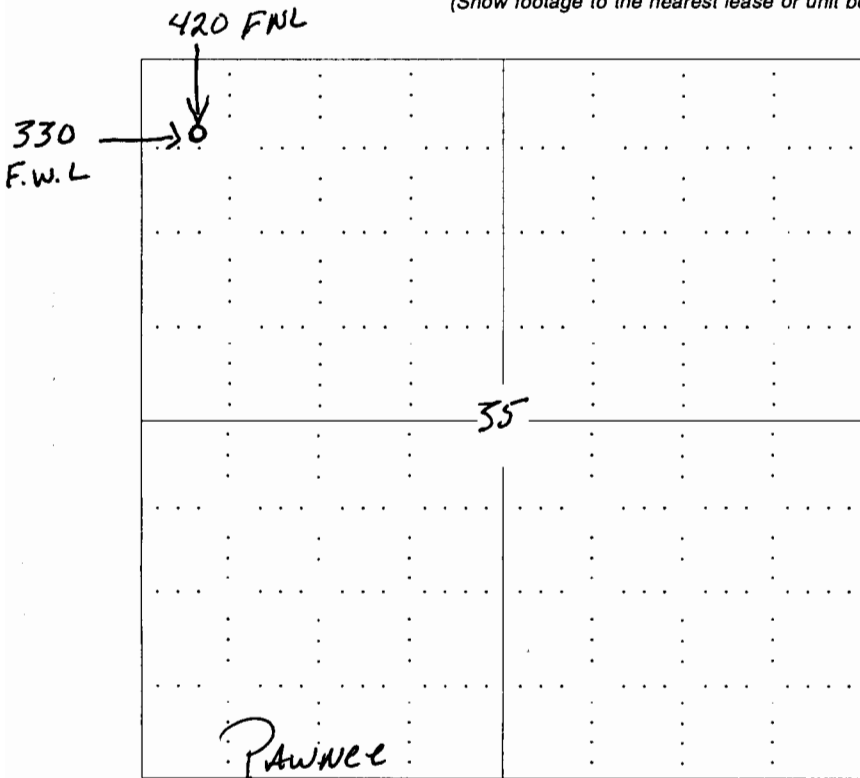

**NOTE: In all cases locate the spot of the proposed drilling location.**

**In plotting the proposed location of the well, you must show:**

1. The manner in which you are using the depicted plat by identifying section lines, i.e. 1 section, 1 section with 8 surrounding sections, 4 sections, etc.
2. The distance of the proposed drilling location from the section's south / north and east / west.
3. The distance to the nearest lease or unit boundary line.
4. If proposed location is located within a prorated or spaced field a certificate of acreage attribution plat must be attached: (CO-7 for oil wells; CG-8 for gas wells).

# KANSAS

CORPORATION COMMISSION

KATHLEEN SEBELIUS, GOVERNOR  
BRIAN J. MOLINE, CHAIR  
ROBERT E. KREHBIEL, COMMISSIONER  
MICHAEL C. MOFFET, COMMISSIONER

June 1, 2005

Mr. Robin Austin  
Rama Operating Co., Inc.  
PO Box 159  
Stafford, KS 67578

RE: Drilling Pit Application  
Spence A OWWO Lease Well No. 2  
NW/4 Sec. 35-23S-18W  
Pawnee County, Kansas

Dear Mr. Austin:

District staff has inspected the above referenced location and has determined that the reserve pit shall be constructed **without slots**, the bottom shall be flat and reasonably level, and the free fluids must be removed. The fluids are to be removed from the reserve pit as soon as practical after drilling operations have ceased.

**If production casing is set all completion fluids shall be removed on a daily basis.**

The fluids should be taken to an authorized disposal well. Please call the District Office at (620) 225-8888 when the fluids have been removed. Also, please file the enclosed CDP-5 form, Surface Pond Waste Transfer, within 30 days of fluid removal.

**A copy of this letter should be posted in the doghouse along with the approved Intent to Drill.** If you have any questions or concerns please feel free to contact the undersigned at the above address.

Sincerely,

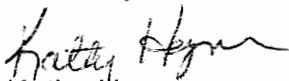

Kathy Haynes  
Environmental Protection and Remediation Department

cc: S Durrant