

CORRECTED

For KCC Use:
Effective Date: 7-13-05
District # 1
SGA? Yes No

**KANSAS CORPORATION COMMISSION
OIL & GAS CONSERVATION DIVISION**

Form C-1
December 2002
Form must be Typed
Form must be Signed
All blanks must be Filled

NOTICE OF INTENT TO DRILL

Must be approved by KCC five (5) days prior to commencing well

"CORRECTION"

Expected Spud Date July 18, 2005
month day year

* Spot 140'S of
NE NE SE Sec. 18 Twp. 31 S. R. 17
2170 feet from N / S Line of Section
 West

OPERATOR: License# 4058
Name: AMERICAN WARRIOR, INC.
Address: P. O. Box 399
City/State/Zip: Garden City, Kansas 67846-0399
Contact Person: Cecil O'Brate
Phone: 620/275-9231

* 330 feet from E / W Line of Section
Is SECTION Regular Irregular?

CONTRACTOR: License# 5929
Name: DUKE DRILLING CO., INC.

(Note: Locate well on the Section Plat on reverse side)
County: Comanche
Lease Name: Jerry Bunnell Well #: 2-18

Well Drilled For: Oil Enh Rec Infield Mud Rotary
 Gas Storage Pool Ext. Air Rotary
 OWWO Disposal Wildcat Cable
 Seismic; # of Holes Other
 Other

Is this a Prorated / Spaced Field? Yes No
Target Information(s): Arbuckle
Nearest Lease or unit boundary: 330'
Ground Surface Elevation: 2086' feet MSL

If OWWO: old well information as follows:
Operator: _____
Well Name: _____
Original Completion Date: _____ Original Total Depth: _____

Water well within one-quarter mile: Yes No
Public water supply well within one mile: Yes No
Depth to bottom of fresh water: 150'
Depth to bottom of usable water: 220'

Directional, Deviated or Horizontal wellbore? Yes No

Surface Pipe by Alternate: 1 2
Length of Surface Pipe Planned to be set: 600'
Length of Conductor Pipe required: None
Projected Total Depth: 6000'
Formation at Total Depth: Arbuckle

If Yes, true vertical depth: _____
Bottom Hole Location: _____

Water Source for Drilling Operations:
 Well Farm Pond Other X
DWR Permit #: _____

KCC DKT #: _____

(Note: Apply for Permit with DWR)
Will Cores be taken? Yes No

*WAS: 140'S & 40'W of NE NE SE, 370' FEL
*IS: 140'S of NE NE SE, 330' FEL

If Yes, proposed zone: _____

AFFIDAVIT

RECEIVED
JUL 12 2005

The undersigned hereby affirms that the drilling, completion and eventual plugging of this well will comply with K.S.A. 55 et. seq.
It is agreed that the following minimum requirements will be met:

KCC WICHITA

1. Notify the appropriate district office prior to spudding of well;
2. A copy of the approved notice of Intent to drill shall be posted on each drilling rig;
3. The minimum amount of surface pipe as specified below shall be set by circulating cement to the top; in all cases surface pipe shall be set through all unconsolidated materials plus a minimum of 20 feet into the underlying formation.
4. If the well is dry hole, an agreement between the operator and the district office on plug length and placement is necessary prior to plugging;
5. The appropriate district office will be notified before well is either plugged or production casing is cemented in;
6. If an ALTERNATE II COMPLETION, production pipe shall be cemented from below any usable water to surface within 120 days of spud date. Or pursuant to Appendix "B" - Eastern Kansas surface casing order #133,891-C, which applies to the KCC District 3 area, alternate II cementing must be completed within 30 days of the spud date or the well shall be plugged. In all cases, NOTIFY district office prior to any cementing.

I hereby certify that the statements made herein are true and to the best of my knowledge and belief.
Date: July 11, 2005 Signature of Operator or Agent: Sally R. Byers Title: Agent

For KCC Use ONLY
API # 15 - 033-21436-00-00
Conductor pipe required NONE feet
Minimum surface pipe required 240 feet per All 1 e
Approved by: RJP 7.8.05/RJP 7.13.05
This authorization expires: 1-8-06
(This authorization void if drilling not started within 6 months of effective date.)
Spud date: _____ Agent: _____

- Remember to:
- File Drill Pit Application (form GDP-1) with Intent to Drill;
 - File Completion Form ACO-1 within 120 days of spud date;
 - File acreage attribution plat according to field proration orders;
 - Notify appropriate district office 48 hours prior to workover or re-entry;
 - Submit plugging report (CP-4) after plugging is completed;
 - Obtain written approval before disposing or injecting salt water.
- If this permit has expired (See: authorized expiration date) please check the box below and return to the address below.
 Well Not Drilled - Permit Expired
Signature of Operator or Agent: _____
Date: _____

18
31
17W

IN ALL CASES PLOT THE INTENDED WELL ON THE PLAT BELOW

Plat of acreage attributable to a well in a prorated or spaced field

If the intended well is in a prorated or spaced field, please fully complete this side of the form. If the intended well is in a prorated or spaced field complete the plat below showing that the well will be properly located in relationship to other wells producing from the common source of supply. Please show all the wells and within 1 mile of the boundaries of the proposed acreage attribution unit for gas wells and within 1/2 mile of the boundaries of the proposed acreage attribution unit for oil wells.

API No. 15 - _____
Operator: _____
Lease: _____
Well Number: _____
Field: _____
Number of Acres attributable to well: _____
QTR / QTR / QTR of acreage: _____ - _____ - _____

Location of Well: County: _____
_____ feet from N / S Line of Section
_____ feet from E / W Line of Section
Sec. _____ Twp. _____ S. R. _____ East West
Is Section: Regular or Irregular
If Section is Irregular, locate well from nearest corner boundary.
Section corner used: NE NW SE SW

PLAT

*(Show location of the well and shade attributable acreage for prorated or spaced wells.)
(Show footage to the nearest lease or unit boundary line.)*

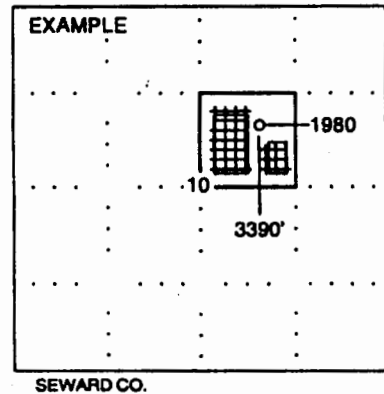
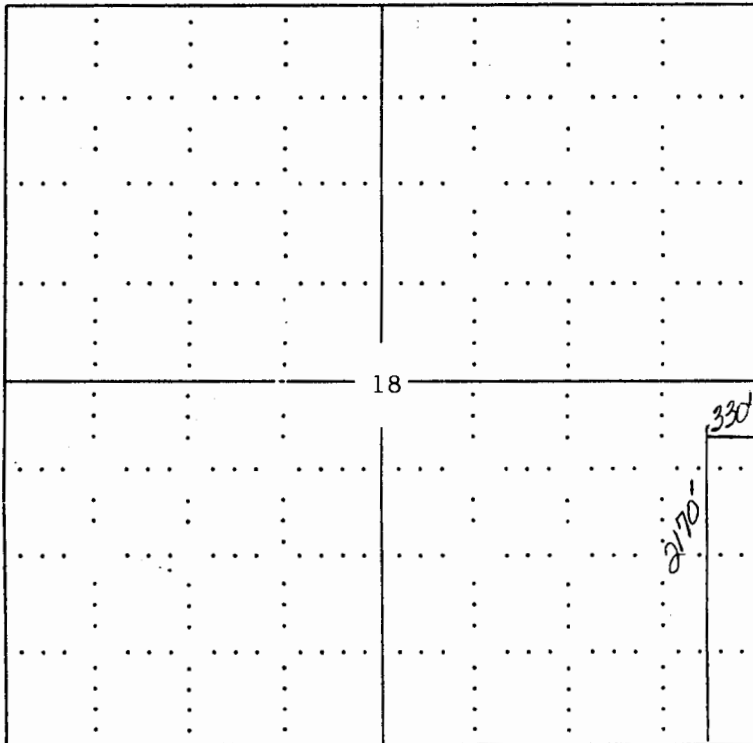

NOTE: In all cases locate the spot of the proposed drilling location.

COMANCHE COUNTY

In plotting the proposed location of the well, you must show:

1. The manner in which you are using the depicted plat by identifying section lines, i.e. 1 section, 1 section with 8 surrounding sections, 4 sections, etc.
2. The distance of the proposed drilling location from the section's south / north and east / west.
3. The distance to the nearest lease or unit boundary line.
4. If proposed location is located within a prorated or spaced field a certificate of acreage attribution plat must be attached: (CO-7 for oil wells; CG-8 for gas wells).