

For KCC Use: 7-23-05
Effective Date: _____
District # _____
SGA? Yes No

KANSAS CORPORATION COMMISSION
OIL & GAS CONSERVATION DIVISION

Form C-1
September 1999
Form must be Typed
Form must be Signed
All blanks must be Filled

NOTICE OF INTENT TO DRILL

Must be approved by KCC five (5) days prior to commencing well

Expected Spud Date July 28th 2005
month day year

OPERATOR: License# 5003
Name: McCoy Petroleum Corporation
Address: 8080 E. Central, Suite #300
City/State/Zip: Wichita, Kansas 67206
Contact Person: Scott Hampel
Phone: 316-636-2737

CONTRACTOR: License# 5142
Name: Sterling Drilling Company

Well Drilled For: Oil Gas OWWO Seismic; # of Holes Other
 Enh Rec Storage Disposal Other
Well Class: Infield Pool Ext. Wildcat
Type Equipment: Mud Rotary Air Rotary Cable

If OWWO: old well information as follows:

Operator: _____
Well Name: _____
Original Completion Date: _____ Original Total Depth: _____

Directional, Deviated or Horizontal wellbore? Yes No

If Yes, true vertical depth: _____

Bottom Hole Location: _____

KCC DKT #: _____

Spot NW - NE - NE Sec. 33 Twp. 25 S. R. 20 East West
330 feet from S (circle one) Line of Section
990 feet from E (circle one) Line of Section
Is SECTION _____ Regular Irregular?

(Note: Locate well on the Section Plat on reverse side)

County: Edwards
Lease Name: BIAGGI "A" Well #: 2-33
Field Name: Trenton

Is this a Prorated / Spaced Field? Yes No

Target Information(s): Mississippian

Nearest Lease or unit boundary: 330'

Ground Surface Elevation: ~2260' feet MSL

Water well within One-quarter mile: Yes No

Public water supply well within one mile: Yes No

Depth to bottom of fresh water: 100' 230'

Depth to bottom of usable water: 260' 330'

Surface Pipe by Alternate: 1 _____ 2 _____

Length of Surface Pipe Planned to be set: 280' 350' min

Length of Conductor Pipe required: None

Projected Total Depth: 4700'

Producing Formation Target: Mississippian

Water Source for Drilling Operations: _____

Well _____ Farm Pond _____ Other Haul Water

DWR Permit #: _____

(Note: Apply for Permit with DWR)

Will Cores be taken? Yes No

If Yes, proposed zone: _____

AFFIDAVIT

The undersigned hereby affirms that the drilling, completion and eventual plugging of this well will comply with K.S.A. 55-101, et. seq.

It is agreed that the following minimum requirements will be met:

1. Notify the appropriate district office **prior** to spudding of well;
2. A copy of the approved notice of intent to drill **shall be posted** on each drilling rig;
3. The minimum amount of surface pipe as specified below **shall be set** by circulating cement to the top; in all cases surface pipe **shall be set** through all unconsolidated materials plus a minimum of 20 feet into the underlying formation.
4. If the well is dry hole, an agreement between the operator and the district office on plug length and placement is necessary **prior to plugging**;
5. The appropriate district office will be notified before well is either plugged or production casing is cemented in;
6. If an ALTERNATE 11 COMPLETION, production pipe shall be cemented from below any usable water to surface within **120 days** of spud date. **In all cases, NOTIFY district office** prior to any cementing.

I hereby certify that the statements made herein are true and to the best of my knowledge and belief.

Date: July 14, 2005 Signature of Operator or Agent: Scott Hampel Title: Engineering/Production Mgr.

For KCC Use ONLY

API # 15 - 047-21507-00-00

Conductor pipe required NONE feet

Minimum surface pipe required 350 feet per Alt

Approved by: RJP 7-18-05

This authorization expires: 1-18-06

(This authorization void if drilling not started within 6 months of effective date.)

Spud date: _____ Agent: _____

Remember to -

- File Drill Pit Application (form CDP-1) with Intent to Drill;
- File Completion Form ACO-1 within 120 days of spud date;
- File acreage attribution plat according to field proration orders;
- Notify appropriate district office 48 hours prior to workover or re-entry;
- Submit plugging report (CP-4) after plugging is completed;
- Obtain written approval before disposing or injecting salt water.

Mail to: KCC - Conservation Division, 130 S. Market - Room 2078, Wichita, Kansas 67202

RECEIVED
JUL 15 2005
KCC WICHITA

IN ALL CASES PLOT THE INTENDED WELL ON THE PLAT BELOW

Plat of acreage attributable to a well in a prorated or spaced field

If the intended well is in a prorated or spaced field, please fully complete this side of the form. If the intended well is in a prorated or spaced field complete the plat below showing that the well will be properly located in relationship to other wells producing from the common source of supply. Please show all the wells and within 1 mile of the boundaries of the proposed acreage attribution unit for gas wells and within 1/2 mile of the boundaries of the proposed acreage attribution unit for oil wells.

API No. 15 - _____
 Operator: McCoy Petroleum Corporation
 Lease: BIAGGI "A"
 Well Number: 2-33
 Field: Trenton
 Number of Acres attributable to well: _____
 QTR / QTR / QTR of acreage: NW - NE - NE

Location of Well: County: Edwards
330' feet from N Line of Section
990' feet from E Line of Section
 Sec. 33 Twp. 25 S. R. 20 East West

Is Section _____ Regular or X Irregular

If Section is Irregular, locate well from nearest corner boundary.
 Section corner used: ___NE ___NW -SE ___SW

PLAT

(Show location of the well and shade attributable acreage for prorated or spaced wells)
(Show footage to the nearest lease or unit boundary fine.)

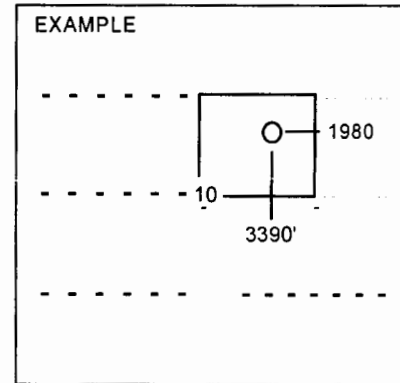
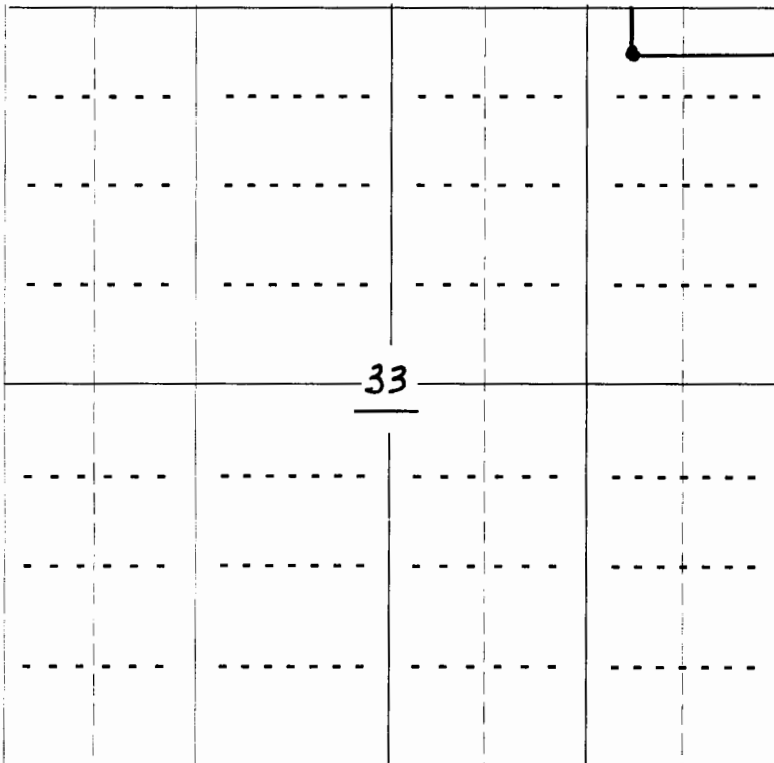

NOTE., In all cases locate the spot of the proposed drilling location.

RECEIVED
 JUL 15 2009

KCC WICHITA

In plotting the proposed location of the well, you must show.

1. The manner in which you are using the depicted plat by identifying section lines, i.e. 1 section, 1 section with 8 surrounding sections, 4 sections, etc.
2. The distance of the proposed drilling location from the section's south / north and east / west.
3. The distance to the nearest lease or unit boundary line.
4. If proposed location is located within a prorated or spaced field a certificate of acreage attribution plat must be attached: (CO-7 for oil wells; CG-8 for gas wells).

KANSAS

CORPORATION COMMISSION

KATHLEEN SEBELIUS, GOVERNOR

BRIAN J. MOLINE, CHAIR

ROBERT E. KREHBIEL, COMMISSIONER

MICHAEL C. MOFFET, COMMISSIONER

July 18, 2005

Mr. Scott Hampel
McCoy Petroleum Corporation
8080 E. Central Ste 300
Wichita, KS 67206

RE: Drilling Pit Application
Biaggi A Lease Well No. 2-33
NE/4 Sec. 33-25S-20W
Edwards County, Kansas

Dear Mr. Hampel:

District staff has inspected the above referenced location and has determined that the reserve pit shall be constructed **without slots**, the bottom shall be flat and reasonably level, and the free fluids must be removed. The fluids are to be removed from the reserve pit as soon as the Hutchinson Salt section has been drilled through and displacement of the fluids into the reserve pit has occurred. The fluids should be removed again as soon as practical after drilling operations have ceased.

If production casing is set all completion fluids shall be removed on a daily basis.

The fluids should be taken to an authorized disposal well. Please call the District Office at (620) 225-8888 when the fluids have been removed. Please file form CDP-5, Exploration and Production Waster Transfer, within 30 days of fluid removal. Conservation division forms are available through our office and on the KCC web site: www.kcc.state.ks.us/conservation/forms.

A copy of this letter should be posted in the doghouse along with the approved Intent to Drill.

If you have any questions or concerns please feel free to contact the undersigned at the above address.

Sincerely,

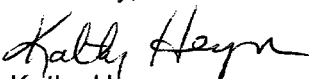

Kathy Haynes
Environmental Protection and Remediation Department

cc: S Durrant